

# CORNER RECORD

Document Number CR-16-199

City of Lathrop

County of San Joaquin, California

Brief Legal Description Lathrop Village Homes, Unit No. 5, Book of Maps & Plats Vol. 20, Page 54, Lathrop Village Homes, Unit No. 6, Book of Maps & Plats Vol. 20, Page 66, and Lathrop Village Homes, Unit No. 7, Book of Maps & Plats Vol. 20, Page 78.

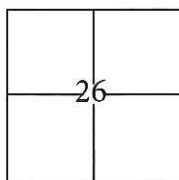

### CORNER TYPE

Government Corner  Control   
Meander  Property   
Rancho  Other

### COORDINATES(Optional)

N. \_\_\_\_\_  
E. \_\_\_\_\_  
Zone III NAD27  NAD83   
NAD83 Epoch 1991.35  
Elev. \_\_\_\_\_  
Vert. Datum: NGVD29  NADV88   
Meas. Units: Metric  Imperial

T. 1 S., R. 6 E. M.D.B. & M.

Date of Survey March 7, 2016

Corner - Left as found  Found and tagged  Established  Reestablished  Rebuilt

Identification and type of corner found: Evidence used to identify or procedure used to establish or reestablish the corner:  
Tied all found centerline monuments to the Primary Survey Control for Reclamation 17. Used conventional survey methods to establish a position on found cut crosses. Evidence identification and field procedure in more detail are shown on page 2.

A description of the physical condition of the monument as found and as set or reset: \_\_\_\_\_  
Found 3/4" iron pins, no tag, in monument wells and found cut crosses in concrete as shown on page 2.

### SURVEYOR'S STATEMENT

This Corner Record was prepared by me or under my direction in conformance with the Land Surveyor's Act on March 14, 2016.  
Signed [Signature] P.L.S. or R.C.E. No.: 7051

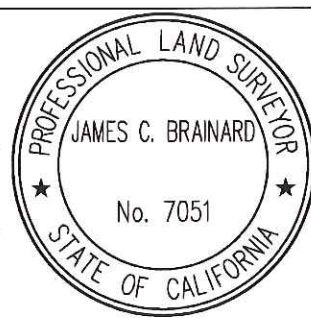

### COUNTY SURVEYOR'S STATEMENT

This Corner Record was received April 18, 2016 and examined and filed May 10, 2016.  
Signed [Signature] P.L.S. or R.C.E. No.: 4842  
Title County Surveyor



County Surveyor's Comment \_\_\_\_\_

## STATEMENT OF PURPOSE:

THE PURPOSE OF THIS SURVEY IS TO IDENTIFY AND RECORD THE LOCATION OF EXISTING MONUMENTS PRIOR TO PG&E IMPROVEMENTS. NO CLAIM IS MADE AS TO THE RELATIONSHIP OF THE MONUMENTS SHOWN HEREON TO THE EXISTING PROPERTY LINES. ORIGINAL LOT LINES SHOWN ARE FOR GENERAL LOCATION AND INFORMATIONAL PURPOSES ONLY.

## DATUM STATEMENT:

COORDINATES SHOWN HEREON ARE GRID AND ARE BASED ON THE PRIMARY SURVEY CONTROL NETWORK FOR RECLAMATION 17 POINT ID NO. 6, 7 AND 604, CALIFORNIA COORDINATE SYSTEM (CCS83), ZONE III, 1983 NAD, (1991.35 GPS ADJUSTMENT) AS SHOWN ON RECORD OF SURVEY BOOK 38 OF SURVEYS, PAGE 119. DISTANCES SHOWN ARE GRID. THE PROJECT SPECIFIC SCALE FACTOR IS 0.99992976.

## LEGEND:

- ⊗ INDICATES FOUND CUT CROSS, NO TAG.
- INDICATES FOUND 3/4" IRON PIN, NO TAG, IN MONUMENT WELL, UNLESS OTHERWISE NOTED

GRID COORDINATES (U.S. SURVEY FEET)		
POINT	NORTHING	EASTING
107	2120210.41'	6334546.15'
108	2120079.06'	6334539.01'
109	2120210.03'	6334660.40'
1001	2120256.37'	6334524.62'
1002	2120253.36'	6334524.44'
1003	2120254.34'	6334564.56'
1004	2120230.20'	6334589.25'
1005	2120230.11'	6334640.22'
1008	2120229.91'	6334701.24'

GRID COORDINATES (U.S. SURVEY FEET)		
POINT	NORTHING	EASTING
1009	2120190.30'	6334590.44'
1010	2120116.72'	6334560.28'
1011	2120052.60'	6334559.95'
1012	2120058.07'	6334519.75'
1013	2120078.30'	6334519.07'
1014	2120119.32'	6334520.30'
1015	2120190.64'	6334500.18'
1018	2120230.73'	6334459.46'
1019	2120230.54'	6334499.63'

