

CORNER RECORD

Document Number CR-16-191

City of _____

County of San Joaquin, California

Brief Legal Description Plat of El Ricado, Volume 6 Maps & Plats, Page 4, Parcel Map, Book 10 of Parcel Maps, and Page 16.

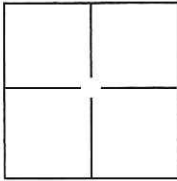

CORNER TYPE

Government Corner Control
 Meander Property
 Rancho Other

Date of Survey February 4, 2016

COORDINATES(Optional)

N. _____
 E. _____
 Zone III NAD27 NAD83
 NAD83 Epoch 1991.35
 Elev. _____
 Vert. Datum: NGVD29 NADV88
 Meas. Units: Metric Imperial

Corner - Left as found Found and tagged Established Reestablished Rebuilt

Identification and type of corner found: Evidence used to identify or procedure used to establish or reestablish the corner:

Established coordinates on all found monuments by the use of G.P.S. and conventional survey methods. Tied all found monuments to the City of Stockton Horizontal Control System. Evidence identification and field procedure in more detail are shown on page 2.

A description of the physical condition of the monument as found and as set or reset: _____

Found 1/2" rebar, 1" iron pipe, and bolt and washer, as shown on page 2.

SURVEYOR'S STATEMENT

This Corner Record was prepared by me or under my direction in conformance with

the Land Surveyors' Act on February 5, 2016.

Signed [Signature] P.L.S. or R.C.E. No.: 7051

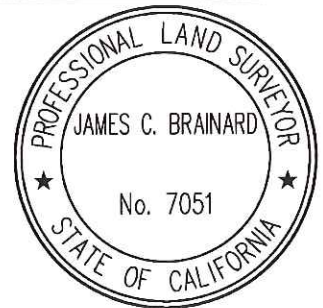

COUNTY SURVEYOR'S STATEMENT

This Corner Record was received March 31, 2016 and examined

and filed May 9, 2016.

Signed [Signature] P.L.S. or R.C.E. No.: 4842

Title County Surveyor

County Surveyor's Comment _____

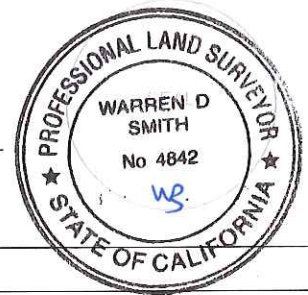

STATEMENT OF PURPOSE:

THE PURPOSE OF THIS SURVEY IS TO IDENTIFY AND RECORD THE LOCATION OF EXISTING MONUMENTS PRIOR TO PG&E IMPROVEMENTS. NO CLAIM IS MADE AS TO THE RELATIONSHIP OF THE MONUMENTS SHOWN HEREON TO THE EXISTING PROPERTY LINES. LOT LINES SHOWN ARE FOR GENERAL LOCATION AND INFORMATIONAL PURPOSES ONLY.

DATUM STATEMENT:

COORDINATES SHOWN HEREON ARE GRID AND ARE BASED ON CITY OF STOCKTON MONUMENTS 6S-TP2 AND 6S-12 CALIFORNIA COORDINATE SYSTEM (CCS83), ZONE III, 1983 NAD, (1991.35 EPOCH STOCKTON & SAN JOAQUIN COUNTY GPS ADJUSTMENT) AND SHOWN ON RECORD OF SURVEY BOOK 35 OF SURVEYS, PAGE 05. THE PROJECT SPECIFIC SCALE FACTOR IS 0.99993620.



LEGEND:

- INDICATES FOUND MONUMENT AS NOTED
- CHW INDICATES CHAS. H. WIDDOWS
- FB INDICATES FIELD BOOK, BOOK-PAGE

GRID COORDINATES (U.S. SURVEY FEET)		
POINT	NORTHING	EASTING
1000	2175792.28'	6345927.96'
1001	2175456.39'	6346030.04'
1002	2175404.64'	6346003.68'
1003	2175312.74'	6346031.72'
2300	2175709.47'	6345931.51'
2301	2175319.81'	6346051.24'
2302	2175189.58'	6346090.61'

