

# CORNER RECORD

Document Number CR-16-157

City of Stockton

County of San Joaquin, California

Brief Legal Description Lincoln Village West, Unit No. 18, Book 19 of Maps & Plats, Page 78.

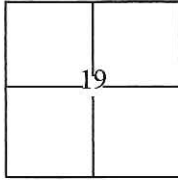

### CORNER TYPE

Government Corner  Control   
 Meander  Property   
 Rancho  Other

### COORDINATES(Optional)

N. \_\_\_\_\_  
 E. \_\_\_\_\_  
 Zone III NAD27  NAD83   
 NAD83 Epoch 1991.35  
 Elev. \_\_\_\_\_  
 Vert. Datum: NGVD29  NADV88   
 Meas. Units: Metric  Imperial

T. 2 N., R. 6 E., M.D.B.&M.

Date of Survey October 8, 2015

Corner - Left as found  Found and tagged  Established  Reestablished  Rebuilt

Identification and type of corner found: Evidence used to identify or procedure used to establish or reestablish the corner:

Used G.P.S. to locate centerline monuments. Found cut "X"s at lot line and used total station set up on centerline monuments to establish location of each found cut "X".

A description of the physical condition of the monument as found and as set or reset: \_\_\_\_\_

Found cut "X"s in concrete, along the approximate property line extended into the right of way, approximately 6 feet from lot corners along Mill Springs Drive and approximately 3 feet from lot corners along Mill Springs Court.

### SURVEYOR'S STATEMENT

This Corner Record was prepared by me or under my direction in conformance with

the Land Surveyor's Act on October 20, 2015.

Signed [Signature] P.L.S. or R.C.E. No.: 7051

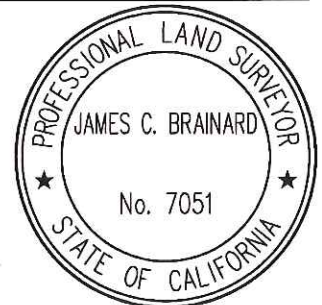

### COUNTY SURVEYOR'S STATEMENT

This Corner Record was received February 8, 2016 and examined

and filed March 24, 2016.

Signed [Signature] P.L.S. or R.C.E. No.: 4842

Title Acting County Surveyor

County Surveyor's Comment \_\_\_\_\_



## STATEMENT OF PURPOSE:

THE PURPOSE OF THIS SURVEY IS TO IDENTIFY AND RECORD THE LOCATION OF EXISTING MONUMENTS PRIOR TO THE CONSTRUCTION OF PG&E FACILITIES AROUND THE MONUMENTS. THE PURPOSE OF THIS SURVEY IS NOT TO MAKE PROPERTY LINE DETERMINATIONS. LOT LINES SHOWN HEREON ARE FOR GENERAL LOCATION AND INFORMATIONAL PURPOSES ONLY.

## NOTE:

FIELD EFFORT INCLUDED A SEARCH FOR EXISTING CUT CROSSES AT THEIR TYPICAL LOCATION, ONLY THOSE FOUND ARE SHOWN.

GRID COORDINATES (U.S. SURVEY FEET)		
POINT	NORTHING	EASTING
1193	2190874.61'	6313379.11'
1194	2190840.03'	6313432.22'
1195	2190850.42'	6313382.14'
1196	2190796.29'	6313375.90'
1197	2190727.02'	6313392.42'
1198	2190529.37'	6313384.35'
1199	2190516.70'	6313377.17'
1200	2190486.73'	6313377.51'

GRID COORDINATES (U.S. SURVEY FEET)		
POINT	NORTHING	EASTING
1201	2190564.04'	6313439.76'
1202	2190502.14'	6313418.96'
1205	2190517.18'	6313460.40'
1206	2190714.07'	6313436.67'
1207	2190783.22'	6313245.97'
1208	2190806.39'	6313119.90'
1254	2190727.43'	6313414.36'

## DATUM STATEMENT:

COORDINATES SHOWN HEREON ARE GRID AND ARE BASED ON CITY OF STOCKTON MONUMENTS 7N-3 AND 7N-5, CALIFORNIA COORDINATE SYSTEM (CCS83), ZONE III, 1983 NAD, (1991.35 EPOCH STOCKTON & SAN JOAQUIN COUNTY GPS ADJUSTMENT) AND SHOWN ON RECORD OF SURVEY BOOK 33 OF SURVEYS, PAGE 20. THE PROJECT SPECIFIC SCALE FACTOR IS 0.99993927.

## LEGEND:

- ⊗ INDICATES FOUND CUT CROSS, NO TAG.
- INDICATES FOUND IRON PINS, 3/4" IN DIAMETER, WITH BRASS TAG ATTACHED STAMPED "R.C.E. 8189" IN CAST IRON MONUMENT WELL.
- ⊠ INDICATES RECORD MONUMENT, NOT SEARCHED FOR.

