

# CORNER RECORD

Document Number CR-16-162  
County of San Joaquin, California

City of Stockton  
Brief Legal Description Lincoln Village West, Unit No. 31, Book 21 of Maps & Plats, Page 33 and Lincoln Village West, Unit No. 23, Book 20 of Maps & Plats, Page 43.

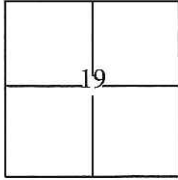

### CORNER TYPE

Government Corner  Control   
Meander  Property   
Rancho  Other

Date of Survey October 8, 2015

### COORDINATES(Optional)

N. \_\_\_\_\_  
E. \_\_\_\_\_  
Zone III NAD27  NAD83   
NAD83 Epoch 1991.35  
Elev. \_\_\_\_\_  
Vert. Datum: NGVD29  NADV88   
Meas. Units: Metric  Imperial

T. 2 N., R. 6 E., M.D.B.&M.

Corner - Left as found  Found and tagged  Established  Reestablished  Rebuilt

Identification and type of corner found: Evidence used to identify or procedure used to establish or reestablish the corner:

Used G.P.S. to locate centerline monuments. Found cut "X"s at lot line and used total station set up on centerline monuments to establish location of each found cut "X".

A description of the physical condition of the monument as found and as set or reset: \_\_\_\_\_

Found cut "X"s in concrete, along the approximate property line extended into the right of way, approximately 6 feet from lot corners. Also, found 3/4" iron pins with brass tags stamped R.C.E. 8189 as shown on page 2.

### SURVEYOR'S STATEMENT

This Corner Record was prepared by me or under my direction in conformance with

the Land Surveyor's Act on October 20, 2015.

Signed [Signature] P.L.S. or R.C.E. No.: 7051

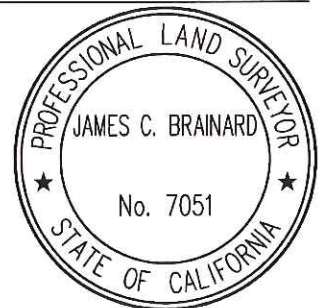

### COUNTY SURVEYOR'S STATEMENT

This Corner Record was received February 8, 2016 and examined

and filed March 24, 2016.

Signed [Signature] P.L.S. or R.C.E. No.: 4842

Title Acting County Surveyor

County Surveyor's Comment \_\_\_\_\_



## STATEMENT OF PURPOSE:

THE PURPOSE OF THIS SURVEY IS TO IDENTIFY AND RECORD THE LOCATION OF EXISTING MONUMENTS PRIOR TO THE CONSTRUCTION OF PG&E FACILITIES AROUND THE MONUMENTS. THE PURPOSE OF THIS SURVEY IS NOT TO MAKE PROPERTY LINE DETERMINATIONS. LOT LINES SHOWN HEREON ARE FOR GENERAL LOCATION AND INFORMATIONAL PURPOSES ONLY.

## NOTE:

FIELD EFFORT INCLUDED A SEARCH FOR EXISTING CUT CROSSES AT THEIR TYPICAL LOCATION, ONLY THOSE FOUND ARE SHOWN.

## DATUM STATEMENT:

COORDINATES SHOWN HEREON ARE GRID AND ARE BASED ON CITY OF STOCKTON MONUMENTS 7N-3 AND 7N-5, CALIFORNIA COORDINATE SYSTEM (CCS83), ZONE III, 1983 NAD, (1991.35 EPOCH STOCKTON & SAN JOAQUIN COUNTY GPS ADJUSTMENT) AND SHOWN ON RECORD OF SURVEY BOOK 33 OF SURVEYS, PAGE 20. THE PROJECT SPECIFIC SCALE FACTOR IS 0.99993927.

## LEGEND:

- ⊗ INDICATES FOUND CUT CROSS, NO TAG.
- INDICATES FOUND IRON PINS, 3/4" IN DIAMETER, WITH BRASS TAG ATTACHED STAMPED "R.C.E. 8189" IN CAST IRON MONUMENT WELL.

GRID COORDINATES (U.S. SURVEY FEET)		
POINT	NORTHING	EASTING
1006	2192006.83'	6314434.16'
1007	2191852.17'	6313979.84'
1137	2191945.45'	6314328.29'
1138	2191964.91'	6314416.72'
1139	2192004.32'	6314456.41'
1140	2192041.36'	6314458.05'
1141	2192101.32'	6314427.31'
1142	2192132.84'	6314416.57'
1146	2192046.38'	6314395.32'
1147	2192003.81'	6314350.68'

