

# CORNER RECORD

Document Number CR-16-161  
 County of San Joaquin, California

City of Stockton

Brief Legal Description Lincoln Village West, Unit No. 31, Book 21 of Maps & Plats, Page 33 and Lincoln Village West, Unit No. 23, Book 20 of Maps & Plats, Page 43.

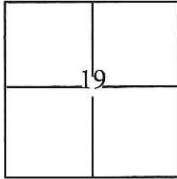

### CORNER TYPE

Government Corner  Control   
 Meander  Property   
 Rancho  Other

Date of Survey October 8, 2015

### COORDINATES(Optional)

N. \_\_\_\_\_  
 E. \_\_\_\_\_  
 Zone III NAD27  NAD83   
 NAD83 Epoch 1991.35  
 Elev. \_\_\_\_\_  
 Vert. Datum: NGVD29  NADV88   
 Meas. Units: Metric  Imperial

T. 2 N., R. 6 E., M.D.B.&M.

Corner - Left as found  Found and tagged  Established  Reestablished  Rebuilt

Identification and type of corner found: Evidence used to identify or procedure used to establish or reestablish the corner:

Used G.P.S. to locate centerline monuments. Found cut "X"s at lot line and used total station set up on centerline monuments to establish location of each found cut "X".

A description of the physical condition of the monument as found and as set or reset: \_\_\_\_\_

Found cut "X"s in concrete, along the approximate property line extended into the right of way, approximately 6 feet from lot corners. Also, found 3/4" iron pins with brass tags stamped R.C.E. 8189 as shown on page 2.

### SURVEYOR'S STATEMENT

This Corner Record was prepared by me or under my direction in conformance with the Land Surveyor's Act on October 20, 2015.

Signed [Signature] P.L.S. or R.C.E. No.: 7051

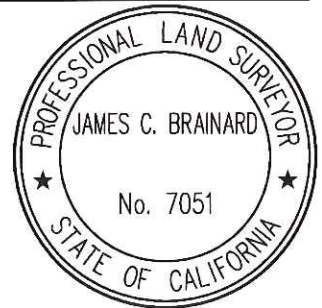

### COUNTY SURVEYOR'S STATEMENT

This Corner Record was received February 8, 2016 and examined and filed March 24, 2016.

Signed [Signature] P.L.S. or R.C.E. No.: 4842

Title Acting County Surveyor

County Surveyor's Comment \_\_\_\_\_

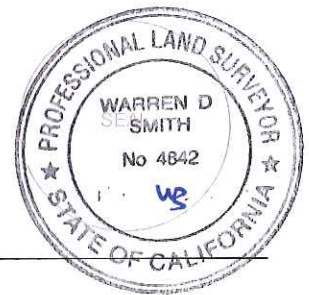

## STATEMENT OF PURPOSE:

THE PURPOSE OF THIS SURVEY IS TO IDENTIFY AND RECORD THE LOCATION OF EXISTING MONUMENTS PRIOR TO THE CONSTRUCTION OF PG&E FACILITIES AROUND THE MONUMENTS. THE PURPOSE OF THIS SURVEY IS NOT TO MAKE PROPERTY LINE DETERMINATIONS. LOT LINES SHOWN HEREON ARE FOR GENERAL LOCATION AND INFORMATIONAL PURPOSES ONLY.

## DATUM STATEMENT:

COORDINATES SHOWN HEREON ARE GRID AND ARE BASED ON CITY OF STOCKTON MONUMENTS 7N-3 AND 7N-5, CALIFORNIA COORDINATE SYSTEM (CCS83), ZONE III, 1983 NAD, (1991.35 EPOCH STOCKTON & SAN JOAQUIN COUNTY GPS ADJUSTMENT) AND SHOWN ON RECORD OF SURVEY BOOK 33 OF SURVEYS, PAGE 20. THE PROJECT SPECIFIC SCALE FACTOR IS 0.99993927.

## LEGEND:

- ⊗ INDICATES FOUND CUT CROSS, NO TAG.
- ⊙ INDICATES FOUND IRON PINS, 3/4" IN DIAMETER, WITH BRASS TAG ATTACHED STAMPED "R.C.E. 8189" IN CAST IRON MONUMENT WELL.

## NOTE:

FIELD EFFORT INCLUDED A SEARCH FOR EXISTING CUT CROSSES AT THEIR TYPICAL LOCATION, ONLY THOSE FOUND ARE SHOWN.

| GRID COORDINATES (U.S. SURVEY FEET) |             |             |
|-------------------------------------|-------------|-------------|
| POINT                               | NORTHING    | EASTING     |
| 1006                                | 2192006.83' | 6314434.16' |
| 1007                                | 2191852.17' | 6313979.84' |
| 1120                                | 2191896.49' | 6313939.36' |
| 1121                                | 2191782.90' | 6313977.98' |
| 1122                                | 2191745.00' | 6313990.86' |
| 1123                                | 2191719.64' | 6314024.84' |
| 1124                                | 2191907.20' | 6313986.43' |
| 1131                                | 2191845.55' | 6314034.79' |
| 1132                                | 2191855.21' | 6314063.20' |
| 1133                                | 2191868.07' | 6314101.08' |
| 1134                                | 2191880.98' | 6314138.95' |
| 1135                                | 2191893.90' | 6314176.79' |
| 1136                                | 2191906.78' | 6314214.66' |
| 1148                                | 2191968.34' | 6314246.57' |
| 1149                                | 2191936.14' | 6314151.86' |

| GRID COORDINATES (U.S. SURVEY FEET) |             |             |
|-------------------------------------|-------------|-------------|
| POINT                               | NORTHING    | EASTING     |
| 1150                                | 2191919.99' | 6314104.48' |
| 1151                                | 2191891.03' | 6314019.34' |

