

CORNER RECORD

Document Number CR-16-157

City of Stockton

County of San Joaquin, California

Brief Legal Description Lincoln Village West, Unit No. 23, Book 20 of Maps & Plats, Page 43.

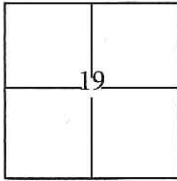

CORNER TYPE

Government Corner Control
 Meander Property
 Rancho Other

COORDINATES(Optional)

N. _____
 E. _____
 Zone III NAD27 NAD83
 NAD83 Epoch 1991.35
 Elev. _____
 Vert. Datum: NGVD29 NADV88
 Meas. Units: Metric Imperial

T. 2 N., R. 6 E., M.D.B.&M.

Date of Survey October 8, 2015

Corner - Left as found Found and tagged Established Reestablished Rebuilt

Identification and type of corner found: Evidence used to identify or procedure used to establish or reestablish the corner:

Used G.P.S. to locate centerline monuments. Found cut "X"s at lot line projections and used total station set up on centerline monuments to establish location of each found cut "X".

A description of the physical condition of the monument as found and as set or reset: _____

Found cut "X"s in concrete, along the approximate property line extended into the right of way, approximately 6 feet from lot corners along Five Mile Drive and 3 feet along Germanna Court. Also, found 3/4" iron pins with brass tags stamped R.C.E. 8189 as shown on page 2.

SURVEYOR'S STATEMENT

This Corner Record was prepared by me or under my direction in conformance with

the Land Surveyor's Act on October 20, 2015.

Signed [Signature] P.L.S. or R.C.E. No.: 7051

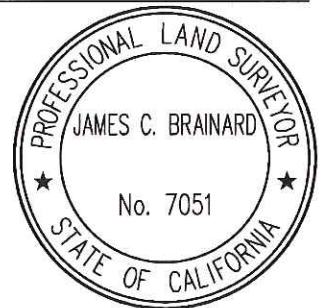

COUNTY SURVEYOR'S STATEMENT

This Corner Record was received February 8, 2016 and examined

and filed March 24, 2016.

Signed [Signature] P.L.S. or R.C.E. No.: 4842

Title Acting County Surveyor

County Surveyor's Comment _____



STATEMENT OF PURPOSE:

THE PURPOSE OF THIS SURVEY IS TO IDENTIFY AND RECORD THE LOCATION OF EXISTING MONUMENTS PRIOR TO THE CONSTRUCTION OF PG&E FACILITIES AROUND THE MONUMENTS. THE PURPOSE OF THIS SURVEY IS NOT TO MAKE PROPERTY LINE DETERMINATIONS. LOT LINES SHOWN HEREON ARE FOR GENERAL LOCATION AND INFORMATIONAL PURPOSES ONLY.

LEGEND:

- ⊗ INDICATES FOUND CUT CROSS, NO TAG.
- INDICATES FOUND IRON PINS, 3/4" IN DIAMETER, WITH BRASS TAG ATTACHED STAMPED "R.C.E. 8189" IN CAST IRON MONUMENT WELL.
- INDICATES SEARCHED FOR RECORD MONUMENT, NOT FOUND

GRID COORDINATES (U.S. SURVEY FEET)		
POINT	NORTHING	EASTING
1154	2192502.77'	6314131.49'
1155	2192454.55'	6314087.52'
1156	2192430.58'	6314097.58'
1157	2192404.53'	6314109.32'
1158	2192356.98'	6314114.08'

DATUM STATEMENT:

COORDINATES SHOWN HEREON ARE GRID AND ARE BASED ON CITY OF STOCKTON MONUMENTS 7N-3 AND 7N-5, CALIFORNIA COORDINATE SYSTEM (CCS83), ZONE III, 1983 NAD, (1991.35 EPOCH STOCKTON & SAN JOAQUIN COUNTY GPS ADJUSTMENT) AND SHOWN ON RECORD OF SURVEY BOOK 33 OF SURVEYS, PAGE 20. THE PROJECT SPECIFIC SCALE FACTOR IS 0.99993927.

NOTE:

FIELD EFFORT INCLUDED A SEARCH FOR EXISTING CUT CROSSES AT THEIR TYPICAL LOCATION, ONLY THOSE FOUND ARE SHOWN.

GRID COORDINATES (U.S. SURVEY FEET)		
POINT	NORTHING	EASTING
1005	2192300.19'	6314334.32'
1011	2192243.81'	6314168.71'
1012	2192291.22'	6314152.65'
1013	2192420.73'	6314131.34'
1098	2192281.02'	6314203.51'
1099	2192252.14'	6314118.50'
1127	2192184.12'	6314067.53'
1128	2192216.29'	6314162.20'
1129	2192232.36'	6314209.54'
1130	2192248.44'	6314256.88'
1143	2192227.52'	6314384.32'
1144	2192293.59'	6314389.22'
1145	2192245.28'	6314327.62'
1152	2192454.36'	6314175.24'
1153	2192486.93'	6314165.26'

