

# CORNER RECORD

Document Number CR-16-110  
County of San Joaquin, California

City of Manteca

Brief Legal Description Hacienda Estates, Unit No. 1, Volume 19 of Maps & Plats, Page 77 and Parcel Map, Book 1 of Parcel Maps, Page 80.

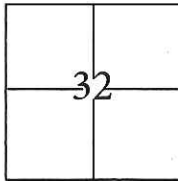

### CORNER TYPE

Government Corner  Control   
Meander  Property   
Rancho  Other

### COORDINATES(Optional)

N. \_\_\_\_\_  
E. \_\_\_\_\_  
Zone III NAD27  NAD83   
NAD83 Epoch 1991.35  
Elev. \_\_\_\_\_  
Vert. Datum: NGVD29  NADV88   
Meas. Units: Metric  Imperial

Date of Survey November 5, 2015

T. 1 S., R. 7 E., M.D.B. & M.

Corner - Left as found  Found and tagged  Established  Reestablished  Rebuilt

Identification and type of corner found: Evidence used to identify or procedure used to establish or reestablish the corner:

Used G.P.S. to locate the centerline monuments. Found cut "X"s at lot line projections and used total station set up on centerline monuments to establish location of each found cut "X".

A description of the physical condition of the monument as found and as set or reset: \_\_\_\_\_

Found cut "X"s in concrete, along the approximate property line extended into the right of way, approximately 3 feet from lot corners. Also, found 3/4" iron pins tagged R.C.E. 8189 in monument wells as shown on page 2.

### SURVEYOR'S STATEMENT

This Corner Record was prepared by me or under my direction in conformance with the Land Surveyor's Act on November 9, 2015.

Signed [Signature] P.L.S. or R.C.E. No.: \_\_\_\_\_

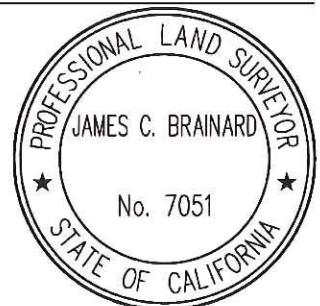

### COUNTY SURVEYOR'S STATEMENT

This Corner Record was received January 11, 2016 and examined and filed February 9, 2016.

Signed Warren D. Smith P.L.S. or R.C.E. No.: 4842

Title Acting County Surveyor

County Surveyor's Comment \_\_\_\_\_



## STATEMENT OF PURPOSE:

THE PURPOSE OF THIS SURVEY IS TO IDENTIFY AND RECORD THE LOCATION OF EXISTING MONUMENTS PRIOR TO THE CONSTRUCTION OF PG&E FACILITIES AROUND THE MONUMENTS. THE PURPOSE OF THIS SURVEY IS NOT TO MAKE PROPERTY LINE DETERMINATIONS. LOT LINES SHOWN HEREON ARE FOR GENERAL LOCATION AND INFORMATIONAL PURPOSES ONLY.

## LEGEND:

- ⊗ INDICATES FOUND CUT CROSS
- INDICATES FOUND 3/4" IRON PINS WITH BRASS TAG STAMPED "R.C.E. 8189" IN MONUMENT WELL

## DATUM STATEMENT:

COORDINATES SHOWN HEREON ARE GRID AND ARE BASED ON CITY OF MANTECA MONUMENTS 233 AND 234, CALIFORNIA COORDINATE SYSTEM (CCS83), ZONE III, 1983 NAD, (1991.35 EPOCH MANTECA & SAN JOAQUIN COUNTY GPS ADJUSTMENT) AND SHOWN ON RECORD OF SURVEY BOOK 33 OF SURVEYS, PAGE 133. THE PROJECT SPECIFIC COMBINED SCALE FACTOR IS 0.99995139.

## NOTE:

FIELD EFFORT INCLUDED A SEARCH FOR EXISTING CUT CROSSES AT THEIR TYPICAL LOCATION, ONLY THOSE FOUND ARE SHOWN.



GRID COORDINATES (U.S. SURVEY FEET)		
POINT	NORTHING	EASTING
105	2118670.48'	6351406.20'
106	2118744.30'	6351713.01'
107	2118738.63'	6351404.91'
108	2118918.67'	6351401.62'
119	2118719.13'	6351540.26'
120	2118720.04'	6351590.24'
121	2118720.96'	6351640.22'
122	2118703.22'	6351735.93'
123	2118762.58'	6351756.33'
124	2118786.80'	6351733.07'
125	2118763.44'	6351559.46'

