

CORNER RECORD

Document Number CR-16-109

City of Tracy

County of San Joaquin, California

Brief Legal Description Tract 1011, Meadow Glen Unit 2, Book 20 of Maps & Plats, Page 26.

CORNER TYPE		COORDINATES(Optional)	
<div style="border: 1px solid black; width: 40px; height: 40px; display: flex; align-items: center; justify-content: center;"> 20 </div>	Government Corner <input type="checkbox"/>	Control <input type="checkbox"/>	N. _____
	Meander <input type="checkbox"/>	Property <input checked="" type="checkbox"/>	E. _____
	Rancho <input type="checkbox"/>	Other <input checked="" type="checkbox"/>	Zone <u>III</u> NAD27 <input type="checkbox"/> NAD83 <input checked="" type="checkbox"/>
Date of Survey <u>November 9, 2015</u>		NAD83 Epoch <u>1991.35</u>	
T.2S., R.5E., MDB&M		Elev. _____	
		Vert. Datum: NGVD29 <input type="checkbox"/> NADV88 <input checked="" type="checkbox"/>	
		Meas. Units: Metric <input type="checkbox"/> Imperial <input checked="" type="checkbox"/>	

Corner - Left as found Found and tagged Established Reestablished Rebuilt

Identification and type of corner found: Evidence used to identify or procedure used to establish or reestablish the corner:
Used G.P.S. to locate the centerline monuments. Found cut "X"s at lot line projections and used total station set up on centerline monuments to establish location of each found cut "X".

A description of the physical condition of the monument as found and as set or reset:
Found cut "X"s in concrete, along the approximate property line extended into the right of way, approximately 9.5 feet from lot corners. Also, found 2 1/2" illegible brass disks as shown on page 2.

SURVEYOR'S STATEMENT

This Corner Record was prepared by me or under my direction in conformance with the Land Surveyor's Act on November 19, 2015.
 Signed [Signature] P.L.S. or R.C.E. No.: 7051

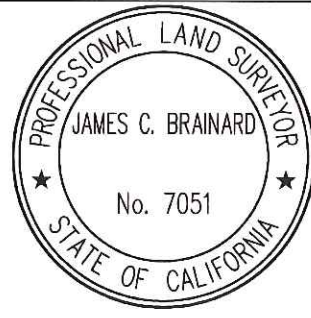

COUNTY SURVEYOR'S STATEMENT

This Corner Record was received January 11, 2016 and examined and filed February 9, 2016.
 Signed [Signature] P.L.S. or R.C.E. No.: 4842



Title Acting County Surveyor

County Surveyor's Comment _____

STATEMENT OF PURPOSE:

THE PURPOSE OF THIS SURVEY IS TO IDENTIFY AND RECORD THE LOCATION OF EXISTING MONUMENTS PRIOR TO THE CONSTRUCTION OF PG&E FACILITIES AROUND THE MONUMENTS. THE PURPOSE OF THIS SURVEY IS NOT TO MAKE PROPERTY LINE DETERMINATIONS. LOT LINES SHOWN HEREON ARE FOR GENERAL LOCATION AND INFORMATIONAL PURPOSES ONLY.

LEGEND:

- ⊗ INDICATES FOUND CUT CROSS, NO TAG.
- INDICATES 2 1/2" ILLEGIBLE BRASS DISK

DATUM STATEMENT:

COORDINATES SHOWN HEREON ARE GRID AND ARE BASED ON CITY OF TRACY MONUMENTS 2022 AND 2076, CALIFORNIA COORDINATE SYSTEM (CCS83), ZONE III, 1983 NAD, (1991.35 EPOCH TRACY & SAN JOAQUIN COUNTY GPS ADJUSTMENT) AND SHOWN ON RECORD OF SURVEY BOOK 36 OF SURVEYS, PAGE 118. THE PROJECT SPECIFIC COMBINED SCALE FACTOR IS 0.99992920.

NOTE:

FIELD EFFORT INCLUDED A SEARCH FOR EXISTING CUT CROSSES AT THEIR TYPICAL LOCATION, ONLY THOSE FOUND ARE SHOWN.



GRID COORDINATES (U.S. SURVEY FEET)		
POINT	NORTHING	EASTING
6	2097743.24'	6289931.29'
7	2097748.30'	6289150.36'
160	2097724.41'	6289600.62'
161	2097724.79'	6289540.65'
162	2097725.15'	6289480.64'
163	2097725.58'	6289420.65'
164	2097725.91'	6289360.66'
165	2097726.35'	6289300.63'
166	2097726.71'	6289240.68'
167	2097767.28'	6289420.97'
168	2097766.53'	6289540.93'

