

CORNER RECORD

Document Number CR-16-104

City of Tracy County of San Joaquin, California
 Brief Legal Description Tract 1549, Cobblestone, Book 25 of Maps & Plats, Page 56.

	CORNER TYPE	COORDINATES(Optional)
<div style="border: 1px solid black; width: 100px; height: 100px; margin: 0 auto; display: flex; align-items: center; justify-content: center;"> <div style="border-right: 1px solid black; width: 50%; height: 50%; display: flex; align-items: center; justify-content: center;">20</div> <div style="border-right: 1px solid black; width: 50%; height: 50%;"></div> </div>	Government Corner <input type="checkbox"/>	N. _____
	Control <input type="checkbox"/>	E. _____
Meander <input type="checkbox"/>	Property <input checked="" type="checkbox"/>	Zone <u>III</u> NAD27 <input type="checkbox"/> NAD83 <input checked="" type="checkbox"/>
Rancho <input type="checkbox"/>	Other <input checked="" type="checkbox"/>	NAD83 Epoch <u>1991.35</u>
	Date of Survey <u>November 9, 2015</u>	Elev. _____
T.2S., R.5E., MDB&M		Vert. Datum: NGVD29 <input type="checkbox"/> NADV88 <input checked="" type="checkbox"/>
		Meas. Units: Metric <input type="checkbox"/> Imperial <input checked="" type="checkbox"/>

Corner - Left as found Found and tagged Established Reestablished Rebuilt

Identification and type of corner found: Evidence used to identify or procedure used to establish or reestablish the corner:
Used G.P.S. to locate the centerline monuments. Found gashes at lot line projections and used total station set up on centerline monuments to establish location of each found gash.

A description of the physical condition of the monument as found and as set or reset:
Found gashes in concrete, along the approximate property line extended into the right of way, approximately 9.5 feet from lot corners. Also, found 2 1/2" brass disks stamped R.C.E. 27034 in as shown on page 2.

SURVEYOR'S STATEMENT

This Corner Record was prepared by me or under my direction in conformance with the Land Surveyor's Act on November 19, 2015.
 Signed [Signature] P.L.S. or R.C.E. No.: 7051

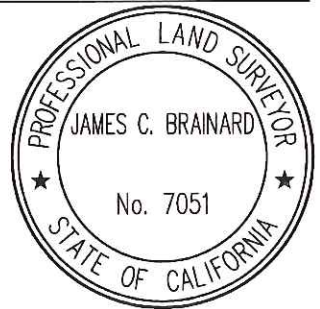

COUNTY SURVEYOR'S STATEMENT

This Corner Record was received January 11, 2016 and examined and filed February 9, 2016.
 Signed [Signature] P.L.S. or R.C.E. No.: 4842



Title Acting County Surveyor
 County Surveyor's Comment _____

STATEMENT OF PURPOSE:

THE PURPOSE OF THIS SURVEY IS TO IDENTIFY AND RECORD THE LOCATION OF EXISTING MONUMENTS PRIOR TO THE CONSTRUCTION OF PG&E FACILITIES AROUND THE MONUMENTS. THE PURPOSE OF THIS SURVEY IS NOT TO MAKE PROPERTY LINE DETERMINATIONS. LOT LINES SHOWN HEREON ARE FOR GENERAL LOCATION AND INFORMATIONAL PURPOSES ONLY.

LEGEND:

- INDICATES FOUND SLASH, NO TAG.
- ⊙ INDICATES 2 1/2" BRASS DISK STAMPED "R.C.E. 27034", UNLESS OTHERWISE NOTED

DATUM STATEMENT:

COORDINATES SHOWN HEREON ARE GRID AND ARE BASED ON CITY OF TRACY MONUMENTS 2022 AND 2076, CALIFORNIA COORDINATE SYSTEM (CCS83), ZONE III, 1983 NAD, (1991.35 EPOCH TRACY & SAN JOAQUIN COUNTY GPS ADJUSTMENT) AND SHOWN ON RECORD OF SURVEY BOOK 36 OF SURVEYS, PAGE 118. THE PROJECT SPECIFIC COMBINED SCALE FACTOR IS 0.99992920.

NOTE:

FIELD EFFORT INCLUDED A SEARCH FOR EXISTING CUT CROSSES AT THEIR TYPICAL LOCATION, ONLY THOSE FOUND ARE SHOWN.

GRID COORDINATES (U.S. SURVEY FEET)		
POINT	NORTHING	EASTING
2	2098248.98'	6289506.64'
3	2098246.32'	6289903.67'
100	2098224.26'	6289861.53'
101	2098206.40'	6289903.25'
102	2098210.59'	6289923.15'
103	2098239.39'	6289943.80'
104	2098273.48'	6289934.08'
105	2098267.69'	6289821.82'

GRID COORDINATES (U.S. SURVEY FEET)		
POINT	NORTHING	EASTING
106	2098268.93'	6289632.75'
107	2098269.45'	6289569.79'
108	2098269.70'	6289506.78'
121	2098227.42'	6289609.49'
122	2098227.01'	6289672.50'
123	2098226.46'	6289735.51'
124	2098226.00'	6289798.52'
126	2098282.61'	6289884.88'

