

CORNER RECORD

Document Number CR-16-99

City of Stockton

County of San Joaquin, California

Brief Legal Description Quail Lakes, Unit No. 13, Volume 23 of Maps & Plats, Page 77.

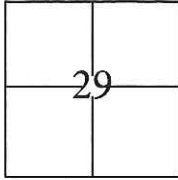

T. 2 N., R. 6 E., M. D. B. &M.

CORNER TYPE

Government Corner Control
 Meander Property
 Rancho Other

Date of Survey November 18, 2015

COORDINATES(Optional)

N. _____
 E. _____
 Zone III NAD27 NAD83
 NAD83 Epoch 1991.35
 Elev. _____
 Vert. Datum: NGVD29 NADV88
 Meas. Units: Metric Imperial

Corner - Left as found Found and tagged Established Reestablished Rebuilt

Identification and type of corner found: Evidence used to identify or procedure used to establish or reestablish the corner:

Used G.P.S. to locate the centerline monuments. Found cut "X"s at lot line projections and used total station set up on centerline monuments to establish location of each found cut "X".

A description of the physical condition of the monument as found and as set or reset: _____

Found cut "X"s in concrete, along the approximate property line extended into the right of way, approximately 6 feet from lot corners. Also, found 3/4" iron pins as shown on page 2.

SURVEYOR'S STATEMENT

This Corner Record was prepared by me or under my direction in conformance with

the Land Surveyor's Act on November 20, 2015.

Signed [Signature] P.L.S. or R.C.E. No.: 7051

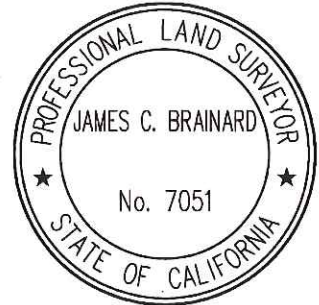

COUNTY SURVEYOR'S STATEMENT

This Corner Record was received January 11, 2016 and examined

and filed February 9, 2016.

Signed [Signature] P.L.S. or R.C.E. No.: 4842

Title Acting County Surveyor

County Surveyor's Comment _____



STATEMENT OF PURPOSE:

THE PURPOSE OF THIS SURVEY IS TO IDENTIFY AND RECORD THE LOCATION OF EXISTING MONUMENTS PRIOR TO THE CONSTRUCTION OF PG&E FACILITIES AROUND THE MONUMENTS. THE PURPOSE OF THIS SURVEY IS NOT TO MAKE PROPERTY LINE DETERMINATIONS. LOT LINES SHOWN HEREON ARE FOR GENERAL LOCATION AND INFORMATIONAL PURPOSES ONLY.

LEGEND:

- ⊗ INDICATES FOUND CUT CROSS, NO TAG.
- INDICATES 3/4" IRON PIN WITH ILLEGIBLE BRASS TAG IN MONUMENT WELL
- INDICATES SEARCHED, FOUND NOTHING.

DATUM STATEMENT:

COORDINATES SHOWN HEREON ARE GRID AND ARE BASED ON CITY OF STOCKTON MONUMENTS 227 AND 235, CALIFORNIA COORDINATE SYSTEM (CCS83), ZONE III, 1983 NAD, (1991.35 EPOCH STOCKTON & SAN JOAQUIN COUNTY GPS ADJUSTMENT) AND SHOWN ON RECORD OF SURVEY BOOK 33 OF SURVEYS, PAGE 20. THE PROJECT SPECIFIC COMBINED SCALE FACTOR IS 0.99993812.

NOTE:

FIELD EFFORT INCLUDED A SEARCH FOR EXISTING CUT CROSSES AT THEIR TYPICAL LOCATION, ONLY THOSE SEARCHED FOR ARE SHOWN.

GRID COORDINATES (U.S. SURVEY FEET)		
POINT	NORTHING	EASTING
1	2184302.06'	6321867.39'
14	2184492.13'	6321711.23'
502	2184497.42'	6321660.60'
503	2184504.86'	6321669.70'
504	2184515.86'	6321704.21'
505	2184506.69'	6321738.48'
506	2184409.96'	6321809.77'

