

CORNER RECORD

Document Number CR-16-96

City of Manteca

County of San Joaquin, California

Brief Legal Description Franciscan Village, Unit No. 1, Volume 20 of Maps & Plats, Page 34.

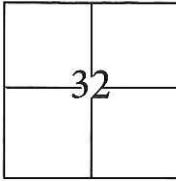

CORNER TYPE

Government Corner Control
 Meander Property
 Rancho Other

COORDINATES(Optional)

N. _____
 E. _____
 Zone III NAD27 NAD83
 NAD83 Epoch _____
 Elev. _____
 Vert. Datum: NGVD29 NADV88
 Meas. Units: Metric Imperial

Date of Survey November 4, 2015

T. 1 S., R. 7 E., M.D.B. & M.

Corner - Left as found Found and tagged Established Reestablished Rebuilt

Identification and type of corner found: Evidence used to identify or procedure used to establish or reestablish the corner:

Used G.P.S. to locate the centerline monuments. Found cut "X"s at lot line projections and used total station set up on centerline monuments to establish location of each found cut "X".

A description of the physical condition of the monument as found and as set or reset: _____

Found cut "X"s in concrete, along the approximate property line extended into the right of way, approximately 3 feet from lot corners. Also, found 3/4" iron pins tagged R.C.E. 14269 in monument wells as shown on page 2.

SURVEYOR'S STATEMENT

This Corner Record was prepared by me or under my direction in conformance with the Land Surveyor's Act on November 9, 2015.

Signed [Signature] P.L.S. or R.C.E. No.: 7051

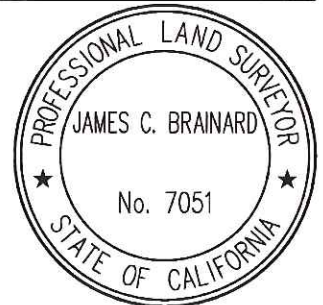

COUNTY SURVEYOR'S STATEMENT

This Corner Record was received January 11, 2016 and examined and filed February 9, 2016.

Signed [Signature] P.L.S. or R.C.E. No.: 4842

Title Acting County Surveyor

County Surveyor's Comment _____



STATEMENT OF PURPOSE:

THE PURPOSE OF THIS SURVEY IS TO IDENTIFY AND RECORD THE LOCATION OF EXISTING MONUMENTS PRIOR TO THE CONSTRUCTION OF PG&E FACILITIES AROUND THE MONUMENTS. THE PURPOSE OF THIS SURVEY IS NOT TO MAKE PROPERTY LINE DETERMINATIONS. LOT LINES SHOWN HEREON ARE FOR GENERAL LOCATION AND INFORMATIONAL PURPOSES ONLY.

LEGEND:

- ⊗ INDICATES FOUND CUT CROSS, NO TAG.
- INDICATES FOUND 3/4" IRON PIN TAGGED RCE 14269

DATUM STATEMENT:

COORDINATES SHOWN HEREON ARE GRID AND ARE BASED ON CITY OF MANTECA MONUMENTS 233 AND 234, CALIFORNIA COORDINATE SYSTEM (CCS83), ZONE III, 1983 NAD, (1991.35 EPOCH MANTECA & SAN JOAQUIN COUNTY GPS ADJUSTMENT) AND SHOWN ON RECORD OF SURVEY BOOK 33 OF SURVEYS, PAGE 133. THE PROJECT SPECIFIC COMBINED SCALE FACTOR IS 0.99992972.

NOTE:

FIELD EFFORT INCLUDED A SEARCH FOR EXISTING CUT CROSSES AT THEIR TYPICAL LOCATION, ONLY THOSE FOUND ARE SHOWN.

GRID COORDINATES (U.S. SURVEY FEET)		
POINT	NORTHING	EASTING
541	2117977.39'	6352638.13'
542	2117973.82'	6353098.90'
633	2117998.98'	6352686.99'
644	2117954.65'	6352733.55'
645	2117954.21'	6352793.60'
646	2117954.12'	6352853.45'
647	2117953.27'	6352913.69'
648	2117952.82'	6352973.69'
649	2117952.45'	6353033.78'
650	2117952.60'	6353045.24'
651	2117944.01'	6353062.71'
652	2117928.55'	6353086.19'

GRID COORDINATES (U.S. SURVEY FEET)		
POINT	NORTHING	EASTING
653	2117936.13'	6353127.07'
654	2117973.46'	6353145.93'
655	2118011.05'	6353127.66'
656	2118019.36'	6353087.19'
657	2118004.23'	6353063.15'
658	2117995.93'	6353045.58'
659	2117996.33'	6353032.83'
660	2117997.28'	6352912.74'
661	2117997.74'	6352852.71'
662	2117998.21'	6352792.70'
663	2117998.67'	6352732.67'

