

CORNER RECORD

Document Number CR-16-93
City of Manteca County of San Joaquin, California

Brief Legal Description Franciscan Village, Unit No. 1, Volume 20 of Maps & Plats, Page 34.

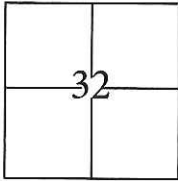

CORNER TYPE

Government Corner Control
Meander Property
Rancho Other

COORDINATES(Optional)

N. _____
E. _____
Zone III NAD27 NAD83
NAD83 Epoch _____
Elev. _____
Vert. Datum: NGVD29 NADV88
Meas. Units: Metric Imperial

Date of Survey November 4, 2015

T. 1 S., R. 7 E., M.D.B. & M.

Corner - Left as found Found and tagged Established Reestablished Rebuilt

Identification and type of corner found: Evidence used to identify or procedure used to establish or reestablish the corner:

Used G.P.S. to locate the centerline monuments. Found cut "X"s at lot line projections and used total station set up on centerline monuments to establish location of each found cut "X".

A description of the physical condition of the monument as found and as set or reset: _____

Found cut "X"s in concrete, along the approximate property line extended into the right of way, approximately 3 feet from lot corners along Don Carlos Court and 4 feet from lot corners along Elm Avenue. Also, found 3/4" iron pins tagged R.C.E. 14269 in monument wells as shown on page 2.

SURVEYOR'S STATEMENT

This Corner Record was prepared by me or under my direction in conformance with the Land Surveyor's Act on November 9, 2015.

Signed [Signature] P.L.S. or R.C.E. No.: 7051

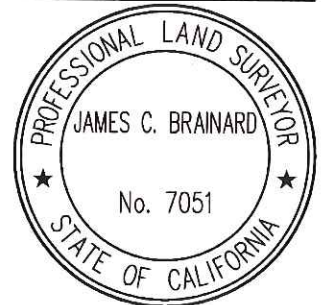

COUNTY SURVEYOR'S STATEMENT

This Corner Record was received January 11, 2016 and examined and filed February 9, 2016.

Signed [Signature] P.L.S. or R.C.E. No.: 4842

Title Acting County Surveyor

County Surveyor's Comment _____



STATEMENT OF PURPOSE:

THE PURPOSE OF THIS SURVEY IS TO IDENTIFY AND RECORD THE LOCATION OF EXISTING MONUMENTS PRIOR TO THE CONSTRUCTION OF PG&E FACILITIES AROUND THE MONUMENTS. THE PURPOSE OF THIS SURVEY IS NOT TO MAKE PROPERTY LINE DETERMINATIONS. LOT LINES SHOWN HEREON ARE FOR GENERAL LOCATION AND INFORMATIONAL PURPOSES ONLY.

LEGEND:

- ⊗ INDICATES FOUND CUT CROSS, NO TAG.
- INDICATES FOUND 3/4" IRON PIN TAGGED RCE 14269

DATUM STATEMENT:

COORDINATES SHOWN HEREON ARE GRID AND ARE BASED ON CITY OF MANTECA MONUMENTS 233 AND 234, CALIFORNIA COORDINATE SYSTEM (CCS83), ZONE III, 1983 NAD, (1991.35 EPOCH MANTECA & SAN JOAQUIN COUNTY GPS ADJUSTMENT) AND SHOWN ON RECORD OF SURVEY BOOK 33 OF SURVEYS, PAGE 133. THE PROJECT SPECIFIC COMBINED SCALE FACTOR IS 0.99992972.

NOTE:

FIELD EFFORT INCLUDED A SEARCH FOR EXISTING CUT CROSSES AT THEIR TYPICAL LOCATION, ONLY THOSE FOUND ARE SHOWN.

GRID COORDINATES (U.S. SURVEY FEET)		
POINT	NORTHING	EASTING
545	2118487.50'	6352631.14'
547	2118483.83'	6353086.20'
583	2118537.94'	6352666.60'
584	2118509.07'	6352689.61'
585	2118465.21'	6352679.00'
586	2118437.98'	6352654.81'
587	2118437.27'	6352628.85'
589	2118464.81'	6352723.31'
590	2118464.30'	6352783.35'
591	2118463.83'	6352843.37'
592	2118463.31'	6352903.37'
593	2118462.84'	6352963.38'
594	2118462.37'	6353023.45'

GRID COORDINATES (U.S. SURVEY FEET)		
POINT	NORTHING	EASTING
595	2118462.35'	6353032.44'
596	2118454.00'	6353049.95'
597	2118437.32'	6353093.09'
598	2118460.29'	6353126.93'
599	2118508.84'	6353126.08'
600	2118530.57'	6353091.43'
601	2118514.33'	6353050.48'
602	2118506.15'	6353032.82'
603	2118506.79'	6352972.89'
604	2118507.26'	6352916.85'
605	2118507.68'	6352860.83'
606	2118508.14'	6352804.81'
607	2118508.58'	6352748.78'

