

CORNER RECORD

Document Number CR-16-91

City of Manteca

County of San Joaquin, California

Brief Legal Description Franciscan Village, Unit No. 1, Volume 20 of Maps & Plats, Page 34.

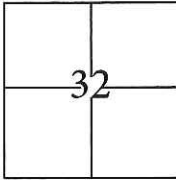

CORNER TYPE

- Government Corner Control
- Meander Property
- Rancho Other

Date of Survey November 4, 2015

COORDINATES(Optional)

N. _____
 E. _____
 Zone III NAD27 NAD83
 NAD83 Epoch _____
 Elev. _____
 Vert. Datum: NGVD29 NADV88
 Meas. Units: Metric Imperial

T. 1 S., R. 7 E., M.D.B. & M.

Corner - Left as found Found and tagged Established Reestablished Rebuilt

Identification and type of corner found: Evidence used to identify or procedure used to establish or reestablish the corner:

Used G.P.S. to locate the centerline monuments. Found cut "X"s at lot line projections and used total station set up on centerline monuments to establish location of each found cut "X".

A description of the physical condition of the monument as found and as set or reset: _____

Found cut "X"s in concrete, along the approximate property line extended into the right of way, approximately 3 feet from lot corners. Also, found 3/4" iron pins tagged R.C.E. 14269 in monument wells as shown on page 2.

SURVEYOR'S STATEMENT

This Corner Record was prepared by me or under my direction in conformance with the Land Surveyor's Act on November 9, 2015.

Signed [Signature] P.L.S. or R.C.E. No.: 7051

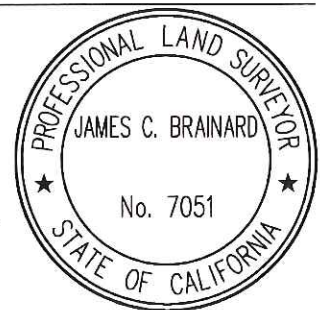

COUNTY SURVEYOR'S STATEMENT

This Corner Record was received January 11, 2016 and examined and filed February 9, 2016.

Signed [Signature] P.L.S. or R.C.E. No.: 4842

Title Acting County Surveyor

County Surveyor's Comment _____



STATEMENT OF PURPOSE:

THE PURPOSE OF THIS SURVEY IS TO IDENTIFY AND RECORD THE LOCATION OF EXISTING MONUMENTS PRIOR TO THE CONSTRUCTION OF PG&E FACILITIES AROUND THE MONUMENTS. THE PURPOSE OF THIS SURVEY IS NOT TO MAKE PROPERTY LINE DETERMINATIONS. LOT LINES SHOWN HEREON ARE FOR GENERAL LOCATION AND INFORMATIONAL PURPOSES ONLY.

LEGEND:

- ⊗ INDICATES FOUND CUT CROSS, NO TAG.
- INDICATES FOUND 3/4" IRON PIN TAGGED RCE 14269

DATUM STATEMENT:

COORDINATES SHOWN HEREON ARE GRID AND ARE BASED ON CITY OF MANTECA MONUMENTS 233 AND 234, CALIFORNIA COORDINATE SYSTEM (CCS83), ZONE III, 1983 NAD, (1991.35 EPOCH MANTECA & SAN JOAQUIN COUNTY GPS ADJUSTMENT) AND SHOWN ON RECORD OF SURVEY BOOK 33 OF SURVEYS, PAGE 133. THE PROJECT SPECIFIC COMBINED SCALE FACTOR IS 0.99992972.

NOTE:

FIELD EFFORT INCLUDED A SEARCH FOR EXISTING CUT CROSSES AT THEIR TYPICAL LOCATION, ONLY THOSE FOUND ARE SHOWN.

GRID COORDINATES (U.S. SURVEY FEET)		
POINT	NORTHING	EASTING
548	2118741.94'	6352682.74'
549	2118738.71'	6353116.58'
553	2118719.23'	6352783.09'
554	2118718.74'	6352848.11'
555	2118718.25'	6352913.19'
556	2118717.83'	6352973.16'
557	2118717.35'	6353033.17'

GRID COORDINATES (U.S. SURVEY FEET)		
POINT	NORTHING	EASTING
568	2118761.36'	6353032.23'
569	2118761.81'	6352972.27'
570	2118762.26'	6352912.28'
571	2118762.75'	6352847.28'
572	2118763.21'	6352782.28'
573	2118763.52'	6352736.72'

