

# CORNER RECORD

Document Number CR-16-89  
 City of Lodi County of San Joaquin, California

Brief Legal Description Lakeshore Village, Unit No. 3, Book 26 of Maps & Plats, Page 87, Lakeshore Village, Unit No. 4, Book 26 of Maps & Plats, Page 101 and Windjammer, Book 27 of Maps & Plats, Page 20.

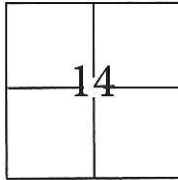

T. 3 N., R. 6 E., M.D.B.&M.

### CORNER TYPE

Government Corner  Control   
 Meander  Property   
 Rancho  Other

Date of Survey November 23, 2015

### COORDINATES(Optional)

N. \_\_\_\_\_  
 E. \_\_\_\_\_  
 Zone III NAD27  NAD83   
 NAD83 Epoch 1991.35  
 Elev. \_\_\_\_\_  
 Vert. Datum: NGVD29  NADV88   
 Meas. Units: Metric  Imperial

Corner - Left as found  Found and tagged  Established  Reestablished  Rebuilt

Identification and type of corner found: Evidence used to identify or procedure used to establish or reestablish the corner:

Used G.P.S. to locate the centerline monuments. Found cut "X"s at lot line projections and used total station set up on centerline monuments to establish location of each found cut "X".

A description of the physical condition of the monument as found and as set or reset:

Found cut "X"s in concrete, along the approximate property line extended into the right of way, approximately 4 feet from lot corners. Also, found 3/4" iron pins with illegible brass tags in monument wells as shown on page 2.

### SURVEYOR'S STATEMENT

This Corner Record was prepared by me or under my direction in conformance with the Land Surveyor's Act on November 24, 2015.

Signed [Signature] P.L.S. or R.C.E. No.: 7051

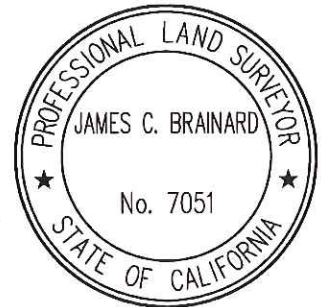

### COUNTY SURVEYOR'S STATEMENT

This Corner Record was received January 11, 2016 and examined and filed February 9, 2016.

Signed [Signature] P.L.S. or R.C.E. No.: 4842

Title Acting County Surveyor

County Surveyor's Comment \_\_\_\_\_

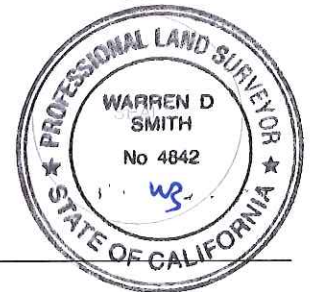

STATEMENT OF PURPOSE:

THE PURPOSE OF THIS SURVEY IS TO IDENTIFY AND RECORD THE LOCATION OF EXISTING MONUMENTS PRIOR TO THE CONSTRUCTION OF PG&E FACILITIES AROUND THE MONUMENTS. THE PURPOSE OF THIS SURVEY IS NOT TO MAKE PROPERTY LINE DETERMINATIONS. LOT LINES SHOWN HEREON ARE FOR GENERAL LOCATION AND INFORMATIONAL PURPOSES ONLY.

LEGEND:

- ⊗ INDICATES FOUND CUT CROSS, NO TAG
- INDICATES FOUND 3/4" IRON PIN WITH ILLEGIBLE BRASS TAG IN MONUMENT WELL

DATUM STATEMENT:

COORDINATES SHOWN HEREON ARE GRID AND ARE BASED ON CITY OF LODI MONUMENTS P1090 AND T1490, CALIFORNIA COORDINATE SYSTEM (CCS83), ZONE III, 1983 NAD, (1991.35 EPOCH LODI & SAN JOAQUIN COUNTY GPS ADJUSTMENT) AND SHOWN ON RECORD OF SURVEY BOOK 37 OF SURVEYS, PAGE 50. THE PROJECT SPECIFIC COMBINED SCALE FACTOR IS 0.99994891.

NOTE:

FIELD EFFORT INCLUDED A SEARCH FOR EXISTING CUT CROSSES AT THEIR TYPICAL LOCATION, ONLY THOSE FOUND ARE SHOWN.

GRID COORDINATES (U.S. SURVEY FEET)		
POINT	NORTHING	EASTING
16	2228030.30'	6332883.78'
17	2228033.68'	6332611.09'
125	2228008.28'	6332762.69'
126	2228008.84'	6332722.56'
127	2228055.33'	6332759.96'
134	2228009.32'	6332682.40'
135	2228009.80'	6332642.25'

GRID COORDINATES (U.S. SURVEY FEET)		
POINT	NORTHING	EASTING
136	2228010.31'	6332602.12'
137	2228010.84'	6332562.00'
138	2228011.33'	6332521.85'
139	2228011.83'	6332481.69'
140	2228012.32'	6332441.53'
151	2228059.22'	6332446.33'

