

CORNER RECORD

Document Number CR-16-87
County of San Joaquin, California

City of Lodi

Brief Legal Description Lakeshore Village, Unit No. 3, Book 26 of Maps & Plats, Page 87, and Lakeshore Village, Unit No. 5, Book 26 of Maps & Plats, Page 108.

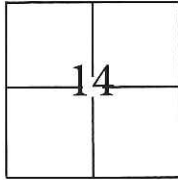

T. 3 N., R. 6 E., M.D.B.&M.

CORNER TYPE

Government Corner Control
Meander Property
Rancho Other

Date of Survey November 23, 2015

COORDINATES(Optional)

N. _____
E. _____
Zone III NAD27 NAD83
NAD83 Epoch 1991.35
Elev. _____
Vert. Datum: NGVD29 NADV88
Meas. Units: Metric Imperial

Corner - Left as found Found and tagged Established Reestablished Rebuilt

Identification and type of corner found: Evidence used to identify or procedure used to establish or reestablish the corner:

Used G.P.S. to locate the centerline monuments. Found cut "X"s at lot line projections and used total station set up on centerline monuments to establish location of each found cut "X".

A description of the physical condition of the monument as found and as set or reset: _____

Found cut "X"s in concrete, along the approximate property line extended into the right of way, approximately 4 feet from lot corners. Also, found 3/4" iron pins with illegible brass tags in monument wells as shown on page 2.

SURVEYOR'S STATEMENT

This Corner Record was prepared by me or under my direction in conformance with the Land Surveyor's Act on November 24, 2015.

Signed [Signature] P.L.S. or R.C.E. No.: 7051

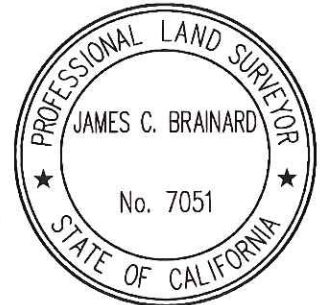

COUNTY SURVEYOR'S STATEMENT

This Corner Record was received January 11, 2016 and examined and filed February 9, 2016.

Signed [Signature] P.L.S. or R.C.E. No.: 4842

Title Acting County Surveyor

County Surveyor's Comment _____



STATEMENT OF PURPOSE:

THE PURPOSE OF THIS SURVEY IS TO IDENTIFY AND RECORD THE LOCATION OF EXISTING MONUMENTS PRIOR TO THE CONSTRUCTION OF PG&E FACILITIES AROUND THE MONUMENTS. THE PURPOSE OF THIS SURVEY IS NOT TO MAKE PROPERTY LINE DETERMINATIONS. LOT LINES SHOWN HEREON ARE FOR GENERAL LOCATION AND INFORMATIONAL PURPOSES ONLY.

LEGEND:

- ⊗ INDICATES FOUND CUT CROSS, NO TAG
- INDICATES FOUND 3/4" IRON PIN WITH ILLEGIBLE BRASS TAG IN MONUMENT WELL

DATUM STATEMENT:

COORDINATES SHOWN HEREON ARE GRID AND ARE BASED ON CITY OF LODI MONUMENTS P1090 AND T1490, CALIFORNIA COORDINATE SYSTEM (CCS83), ZONE III, 1983 NAD, (1991.35 EPOCH LODI & SAN JOAQUIN COUNTY GPS ADJUSTMENT) AND SHOWN ON RECORD OF SURVEY BOOK 37 OF SURVEYS, PAGE 50. THE PROJECT SPECIFIC COMBINED SCALE FACTOR IS 0.99994891.

NOTE:

FIELD EFFORT INCLUDED A SEARCH FOR EXISTING CUT CROSSES AT THEIR TYPICAL LOCATION, ONLY THOSE FOUND ARE SHOWN.

GRID COORDINATES (U.S. SURVEY FEET)		
POINT	NORTHING	EASTING
12	2228042.95'	6333196.12'
13	2228045.03'	6333156.16'
14	2228043.57'	6333110.20'
103	2228061.31'	6333255.18'
104	2228066.36'	6333198.11'
105	2228015.21'	6333243.39'
110	2228018.80'	6333203.03'
111	2228019.59'	6333194.04'

GRID COORDINATES (U.S. SURVEY FEET)		
POINT	NORTHING	EASTING
112	2228021.43'	6333162.80'
113	2228020.89'	6333122.78'
114	2228020.19'	6333111.98'
115	2228018.02'	6333082.89'
133	2228063.37'	6333059.92'

