

# CORNER RECORD

Document Number CR-16-82

City of Lodi

County of San Joaquin, California

Brief Legal Description Lodi West, Unit No. 3, Book 33 of Maps & Plats, Page 67.

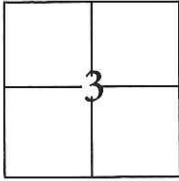

### CORNER TYPE

Government Corner  Control   
 Meander  Property   
 Rancho  Other

### COORDINATES(Optional)

N. \_\_\_\_\_  
 E. \_\_\_\_\_  
 Zone III NAD27  NAD83   
 NAD83 Epoch 1991.35  
 Elev. \_\_\_\_\_  
 Vert. Datum: NGVD29  NADV88   
 Meas. Units: Metric  Imperial

T. 3 N., R. 6 E., M.D.B. & M.

Date of Survey November 5, 2015

Corner - Left as found  Found and tagged  Established  Reestablished  Rebuilt

Identification and type of corner found: Evidence used to identify or procedure used to establish or reestablish the corner:  
Used G.P.S. to locate the centerline monuments. Found cut "X"s at lot line projections and used total station set up on centerline monuments to establish location of each found cut "X".

A description of the physical condition of the monument as found and as set or reset: \_\_\_\_\_  
Found cut "X"s in concrete, along the approximate property line extended into the right of way, approximately 4 feet from lot corners. Also, found 3/4" iron pins tagged R.C.E. 14269 in monument wells as shown on page 2.

### SURVEYOR'S STATEMENT

This Corner Record was prepared by me or under my direction in conformance with the Land Surveyor's Act on November 11, 2015.  
 Signed [Signature] P.L.S. or R.C.E. No.: 7051

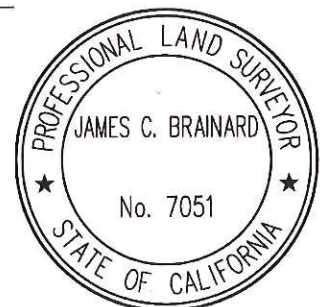

### COUNTY SURVEYOR'S STATEMENT

This Corner Record was received January 11, 2016 and examined and filed February 9, 2016.  
 Signed [Signature] P.L.S. or R.C.E. No.: 4842



Title Acting County Surveyor

County Surveyor's Comment \_\_\_\_\_

## STATEMENT OF PURPOSE:

THE PURPOSE OF THIS SURVEY IS TO IDENTIFY AND RECORD THE LOCATION OF EXISTING MONUMENTS PRIOR TO THE CONSTRUCTION OF PG&E FACILITIES AROUND THE MONUMENTS. THE PURPOSE OF THIS SURVEY IS NOT TO MAKE PROPERTY LINE DETERMINATIONS. LOT LINES SHOWN HEREON ARE FOR GENERAL LOCATION AND INFORMATIONAL PURPOSES ONLY.

## LEGEND:

- ⊗ INDICATES FOUND CUT CROSS, NO TAG.
- INDICATES FOUND 3/4" IRON REBAR WITH PLASTIC CAPS STAMPED "R.C.E. 19638" IN MONUMENT WELL

## DATUM STATEMENT:

COORDINATES SHOWN HEREON ARE GRID AND ARE BASED ON CITY OF LODI MONUMENTS H1090 AND M1090, CALIFORNIA COORDINATE SYSTEM (CCS83), ZONE III, 1983 NAD, (1991.35 EPOCH LODI & SAN JOAQUIN COUNTY GPS ADJUSTMENT) AND SHOWN ON RECORD OF SURVEY BOOK 37 OF SURVEYS, PAGE 50. THE PROJECT SPECIFIC COMBINED SCALE FACTOR IS 0.99995139.

## NOTE:

FIELD EFFORT INCLUDED A SEARCH FOR EXISTING CUT CROSSES AT THEIR TYPICAL LOCATION, ONLY THOSE FOUND ARE SHOWN.

GRID COORDINATES (U.S. SURVEY FEET)		
POINT	NORTHING	EASTING
4504	2236026.25'	6329028.01'
4505	2236115.63'	6328747.04'
5260	2236005.27'	6329027.79'
5261	2236047.27'	6329028.20'
5262	2236008.85'	6328972.15'
5263	2236053.06'	6328958.45'
5264	2236017.92'	6328918.27'

GRID COORDINATES (U.S. SURVEY FEET)		
POINT	NORTHING	EASTING
5265	2236069.16'	6328889.58'
5266	2236032.79'	6328865.56'
5267	2236053.38'	6328813.78'
5268	2236094.43'	6328825.21'
5269	2236078.17'	6328766.61'
5276	2236109.88'	6328718.49'
5277	2236130.51'	6328762.46'

