

CORNER RECORD

Document Number CR-16-81

City of Lodi

County of San Joaquin, California

Brief Legal Description Lodi West, Unit No. 3, Book 33 of Maps & Plats, Page 67 and Lodi West, Unit No. 7, Book 35 of Maps & Plats, Page 80.

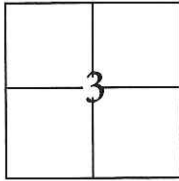

CORNER TYPE

Government Corner Control
 Meander Property
 Rancho Other

COORDINATES(Optional)

N. _____
 E. _____
 Zone III NAD27 NAD83
 NAD83 Epoch 1991.35
 Elev. _____
 Vert. Datum: NGVD29 NADV88
 Meas. Units: Metric Imperial

T. 3 N., R. 6 E., M.D.B. & M.

Date of Survey November 5, 2015

Corner - Left as found Found and tagged Established Reestablished Rebuilt

Identification and type of corner found; Evidence used to identify or procedure used to establish or reestablish the corner:

Used G.P.S. to locate the centerline monuments. Found cut "X"s at lot line projections and used total station set up on centerline monuments to establish location of each found cut "X".

A description of the physical condition of the monument as found and as set or reset: _____

Found cut "X"s in concrete, along the approximate property line extended into the right of way, approximately 4 feet from lot corners. Also, found 3/4" iron pins tagged R.C.E. 14269 in monument wells as shown on page 2.

SURVEYOR'S STATEMENT

This Corner Record was prepared by me or under my direction in conformance with the Land Surveyor's Act on November 11, 2015.

Signed [Signature] P.L.S. or R.C.E. No.: 7051

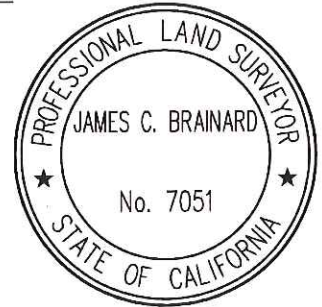

COUNTY SURVEYOR'S STATEMENT

This Corner Record was received January 11, 2016 and examined and filed February 9, 2016.

Signed [Signature] P.L.S. or R.C.E. No.: 4842

Title Acting County Surveyor

County Surveyor's Comment _____

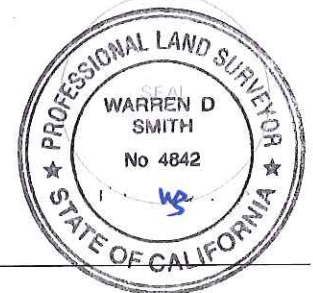

STATEMENT OF PURPOSE:

THE PURPOSE OF THIS SURVEY IS TO IDENTIFY AND RECORD THE LOCATION OF EXISTING MONUMENTS PRIOR TO THE CONSTRUCTION OF PG&E FACILITIES AROUND THE MONUMENTS. THE PURPOSE OF THIS SURVEY IS NOT TO MAKE PROPERTY LINE DETERMINATIONS. LOT LINES SHOWN HEREON ARE FOR GENERAL LOCATION AND INFORMATIONAL PURPOSES ONLY.

LEGEND:

- ⊗ INDICATES FOUND CUT CROSS, NO TAG.
- INDICATES FOUND 3/4" IRON REBAR WITH PLASTIC CAPS STAMPED "R.C.E. 19638" IN MONUMENT WELL

DATUM STATEMENT:

COORDINATES SHOWN HEREON ARE GRID AND ARE BASED ON CITY OF LODI MONUMENTS H1090 AND M1090, CALIFORNIA COORDINATE SYSTEM (CCS83), ZONE III, 1983 NAD, (1991.35 EPOCH LODI & SAN JOAQUIN COUNTY GPS ADJUSTMENT) AND SHOWN ON RECORD OF SURVEY BOOK 37 OF SURVEYS, PAGE 50. THE PROJECT SPECIFIC COMBINED SCALE FACTOR IS 0.99995139.

NOTE:

FIELD EFFORT INCLUDED A SEARCH FOR EXISTING CUT CROSSES AT THEIR TYPICAL LOCATION, ONLY THOSE FOUND ARE SHOWN.

GRID COORDINATES (U.S. SURVEY FEET)		
POINT	NORTHING	EASTING
4502	2236024.71'	6329177.81'
4503	2236022.12'	6329446.28'
5248	2236013.65'	6329466.08'
5249	2236055.67'	6329476.80'
5250	2235992.22'	6329431.08'
5251	2235998.23'	6329380.26'
5252	2236044.03'	6329359.18'
5253	2236002.37'	6329325.25'
5254	2236044.52'	6329304.23'
5255	2236045.08'	6329248.15'

GRID COORDINATES (U.S. SURVEY FEET)		
POINT	NORTHING	EASTING
5256	2236045.64'	6329193.18'
5257	2236046.19'	6329138.20'
5258	2236046.75'	6329083.22'
5259	2236004.71'	6329085.83'

