

CORNER RECORD

Document Number CR-16-73

City of Stockton

County of San Joaquin, California

Brief Legal Description Le Blanc Villa, Unit No. 2, Volume 20 of Maps & Plats, Page 28.

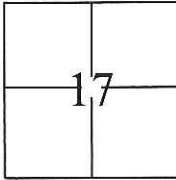

CORNER TYPE

Government Corner Control
 Meander Property
 Rancho Other

Date of Survey October 29, 2015

COORDINATES(Optional)

N. _____
 E. _____
 Zone III NAD27 NAD83
 NAD83 Epoch 1991.35
 Elev. _____
 Vert. Datum: NGVD29 NADV88
 Meas. Units: Metric Imperial

T. 2 N., R. 6 E., M.D.B.&M.

Corner - Left as found Found and tagged Established Reestablished Rebuilt

Identification and type of corner found; Evidence used to identify or procedure used to establish or reestablish the corner:
Used G.P.S. to locate the centerline monuments. Found cut "X"s at lot line projections and used total station set up on centerline monuments to establish location of each found cut "X".

A description of the physical condition of the monument as found and as set or reset:
Found cut "X"s in concrete, along the approximate property line extended into the right of way, approximately 5 feet from lot corners. Also, found 3/4" iron pipes tagged R.C.E. 15831 in monument wells as shown on page 2.

SURVEYOR'S STATEMENT

This Corner Record was prepared by me or under my direction in conformance with the Land Surveyors Act on November 5, 2015.
 Signed [Signature] P.L.S. or R.C.E. No.: 7051

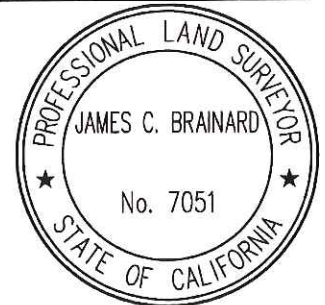

COUNTY SURVEYOR'S STATEMENT

This Corner Record was received January 11, 2016 and examined and filed February 9, 2016.
 Signed [Signature] P.L.S. or R.C.E. No.: 4842
 Title Acting County Surveyor



County Surveyor's Comment _____

STATEMENT OF PURPOSE:

THE PURPOSE OF THIS SURVEY IS TO IDENTIFY AND RECORD THE LOCATION OF EXISTING MONUMENTS PRIOR TO THE CONSTRUCTION OF PG&E FACILITIES AROUND THE MONUMENTS. THE PURPOSE OF THIS SURVEY IS NOT TO MAKE PROPERTY LINE DETERMINATIONS. LOT LINES SHOWN HEREON ARE FOR GENERAL LOCATION AND INFORMATIONAL PURPOSES ONLY.

LEGEND:

- ⊗ INDICATES FOUND CUT CROSS, NO TAG.
- INDICATES 3/4" IRON PIPE TAGGED 15831 IN MONUMENT WELL
- INDICATES SEARCHED FOR RECORD MONUMENT, NOT FOUND

DATUM STATEMENT:

COORDINATES SHOWN HEREON ARE GRID AND ARE BASED ON CITY OF STOCKTON MONUMENTS 4N-16 AND 1N-7, CALIFORNIA COORDINATE SYSTEM (CCS83), ZONE III, 1983 NAD, (1991.35 EPOCH STOCKTON & SAN JOAQUIN COUNTY GPS ADJUSTMENT) AND SHOWN ON RECORD OF SURVEY BOOK 33 OF SURVEYS, PAGE 20. THE PROJECT SPECIFIC COMBINED SCALE FACTOR IS 0.99994066.

NOTE:

FIELD EFFORT INCLUDED A SEARCH FOR EXISTING CUT CROSSES AT THEIR TYPICAL LOCATION, ONLY THOSE FOUND ARE SHOWN.

GRID COORDINATES (U.S. SURVEY FEET)		
POINT	NORTHING	EASTING
4000	2197526.47'	6317258.83'
4001	2197362.44'	6317222.67'
4032	2197419.49'	6317256.02'
4033	2197342.59'	6317259.75'
4034	2197328.07'	6317198.51'
4035	2197357.90'	6317180.87'
4036	2197531.89'	6317166.80'
4037	2197549.67'	6317080.87'
4038	2197594.47'	6317117.22'
4039	2197603.12'	6317056.41'

