

CORNER RECORD

Document Number CR-16-62

City of Stockton

County of San Joaquin, California

Brief Legal Description Colonial West, Unit No. 2, Volume 19 of Maps & Plats, Page 52 and Colonial West, Unit No. 4, Volume 19 of Maps & Plats, Page 71.

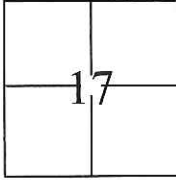

CORNER TYPE

Government Corner Control
 Meander Property
 Rancho Other

Date of Survey October 26, 2015

COORDINATES(Optional)

N. _____
 E. _____
 Zone III NAD27 NAD83
 NAD83 Epoch 1991.35
 Elev. _____
 Vert. Datum: NGVD29 NADV88
 Meas. Units: Metric Imperial

T. 2 N., R. 6 E., M.D.B.&M.

Corner - Left as found Found and tagged Established Reestablished Rebuilt

Identification and type of corner found: Evidence used to identify or procedure used to establish or reestablish the corner:
Used G.P.S. to locate the centerline monuments. Found cut "X"s at lot line projections and used total station set up on centerline monuments to establish location of each found cut "X".

A description of the physical condition of the monument as found and as set or reset: _____
Found cut "X"s in concrete, along the approximate property line extended into the right of way, approximately 5 feet from lot corners. Also, found 3/4" iron pipes tagged R.C.E. 15831 in monument wells as shown on page 2.

SURVEYOR'S STATEMENT

This Corner Record was prepared by me or under my direction in conformance with the Land Surveyor's Act on October 29, 2015.
 Signed [Signature] P.L.S. or R.C.E. No.: 7051

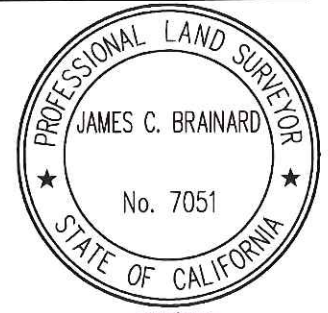

COUNTY SURVEYOR'S STATEMENT

This Corner Record was received January 11, 2016 and examined and filed February 9, 2016.
 Signed [Signature] P.L.S. or R.C.E. No.: 4842
 Title Acting County Surveyor



County Surveyor's Comment _____

STATEMENT OF PURPOSE:

THE PURPOSE OF THIS SURVEY IS TO IDENTIFY AND RECORD THE LOCATION OF EXISTING MONUMENTS PRIOR TO THE CONSTRUCTION OF PG&E FACILITIES AROUND THE MONUMENTS. THE PURPOSE OF THIS SURVEY IS NOT TO MAKE PROPERTY LINE DETERMINATIONS. LOT LINES SHOWN HEREON ARE FOR GENERAL LOCATION AND INFORMATIONAL PURPOSES ONLY.

LEGEND:

- ⊗ INDICATES FOUND CUT CROSS, NO TAG, NO REFERENCE.
- INDICATES FOUND 3/4" IRON PIPES IN WELL TAGGED R.C.E. 15831
- INDICATES SEARCHED FOR RECORD MONUMENT, NOT FOUND

NOTE:

FIELD EFFORT INCLUDED A SEARCH FOR EXISTING CUT CROSSES AT THEIR TYPICAL LOCATION, ONLY THOSE FOUND ARE SHOWN.

DATUM STATEMENT:

COORDINATES SHOWN HEREON ARE GRID AND ARE BASED ON CITY OF STOCKTON MONUMENTS 4N-6 AND 4N-10, CALIFORNIA COORDINATE SYSTEM (CCS83), ZONE III, 1983 NAD, (1991.35 EPOCH STOCKTON & SAN JOAQUIN COUNTY GPS ADJUSTMENT) AND SHOWN ON RECORD OF SURVEY BOOK 33 OF SURVEYS, PAGE 20. THE PROJECT SPECIFIC COMBINED SCALE FACTOR IS 0.99994060.

SCALE: 1"=100'

GRID COORDINATES (U.S. SURVEY FEET)		
POINT	NORTHING	EASTING
2047	2196819.43'	6318922.99'
2048	2196689.46'	6318923.31'
2049	2196499.36'	6318923.80'
2080	2196797.21'	6318757.64'
2081	2196689.79'	6318903.35'
2082	2196624.80'	6318903.50'
2083	2196559.75'	6318903.76'
2084	2196497.08'	6318881.77'
2085	2196463.01'	6318902.93'
2086	2196457.72'	6318929.18'
2087	2196476.42'	6318958.88'
2088	2196516.84'	6318962.52'
2089	2196589.24'	6318943.20'
2090	2196654.30'	6318943.24'
2091	2196719.20'	6318943.31'
2092	2196842.29'	6319052.93'

