

CORNER RECORD

Document Number CR-16-58

City of Stockton

County of San Joaquin, California

Brief Legal Description Colonial West, Unit No. 1, Volume 19 of Maps & Plats, Page 51 and Colonial West, Unit No. 5, Volume 19 of Maps & Plats, Page 84.

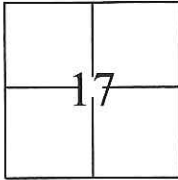

CORNER TYPE

Government Corner Control
 Meander Property
 Rancho Other

COORDINATES(Optional)

N. _____
 E. _____
 Zone III NAD27 NAD83
 NAD83 Epoch 1991.35
 Elev. _____
 Vert. Datum: NGVD29 NADV88
 Meas. Units: Metric Imperial

Date of Survey October 26, 2015

T. 2 N., R. 6 E., M.D.B.&M.

Corner - Left as found Found and tagged Established Reestablished Rebuilt

Identification and type of corner found: Evidence used to identify or procedure used to establish or reestablish the corner:

Used G.P.S. to locate the centerline monuments. Found cut "X"s at lot line projections and used total station set up on centerline monuments to establish location of each found cut "X".

A description of the physical condition of the monument as found and as set or reset: _____

Found cut "X"s in concrete, along the approximate property line extended into the right of way, approximately 5 feet from lot corners. Also, found 3/4" iron pipes tagged R.C.E. 15831 in monument wells as shown on page 2.

SURVEYOR'S STATEMENT

This Corner Record was prepared by me or under my direction in conformance with the Land Surveyor's Act on October 29, 2015.

Signed [Signature] P.L.S. or R.C.E. No.: 7051

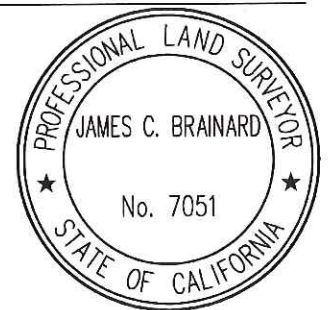

COUNTY SURVEYOR'S STATEMENT

This Corner Record was received January 11, 2016 and examined and filed February 9, 2016.

Signed [Signature] P.L.S. or R.C.E. No.: 4842

Title Acting County Surveyor

County Surveyor's Comment _____



STATEMENT OF PURPOSE:

THE PURPOSE OF THIS SURVEY IS TO IDENTIFY AND RECORD THE LOCATION OF EXISTING MONUMENTS PRIOR TO THE CONSTRUCTION OF PG&E FACILITIES AROUND THE MONUMENTS. THE PURPOSE OF THIS SURVEY IS NOT TO MAKE PROPERTY LINE DETERMINATIONS. LOT LINES SHOWN HEREON ARE FOR GENERAL LOCATION AND INFORMATIONAL PURPOSES ONLY.

LEGEND:

- ⊗ INDICATES FOUND CUT CROSS, NO TAG, NO REFERENCE.
- INDICATES FOUND 3/4" IRON PIPES IN WELL TAGGED R.C.E. 15831

DATUM STATEMENT:

COORDINATES SHOWN HEREON ARE GRID AND ARE BASED ON CITY OF STOCKTON MONUMENTS 4N-6 AND 4N-10, CALIFORNIA COORDINATE SYSTEM (CCS83), ZONE III, 1983 NAD, (1991.35 EPOCH STOCKTON & SAN JOAQUIN COUNTY GPS ADJUSTMENT) AND SHOWN ON RECORD OF SURVEY BOOK 33 OF SURVEYS, PAGE 20. THE PROJECT SPECIFIC COMBINED SCALE FACTOR IS 0.99994060.

NOTE:

FIELD EFFORT INCLUDED A SEARCH FOR EXISTING CUT CROSSES AT THEIR TYPICAL LOCATION, ONLY THOSE FOUND ARE SHOWN.

GRID COORDINATES (U.S. SURVEY FEET)		
POINT	NORTHING	EASTING
2016	2197212.35'	6319153.32'
2017	2197240.40'	6319302.73'
2018	2196949.00'	6319182.50'
2019	2196951.61'	6319304.46'
2020	2196923.15'	6319182.82'
2052	2197116.31'	6319168.39'
2158	2197044.96'	6319152.00'
2159	2196982.85'	6319156.42'
2160	2196915.62'	6319157.89'
2161	2196915.99'	6319326.76'
2162	2196942.01'	6319345.80'
2163	2196976.35'	6319338.45'
2164	2196993.62'	6319304.97'
2165	2197054.41'	6319201.21'
2166	2197119.98'	6319193.14'
2167	2197200.19'	6319289.09'
2168	2197211.41'	6319333.27'
2169	2197247.46'	6319344.11'
2170	2197277.58'	6319322.42'
2171	2197273.18'	6319275.84'

GRID COORDINATES (U.S. SURVEY FEET)		
POINT	NORTHING	EASTING
2174	2197307.87'	6319105.32'
2175	2197242.63'	6319121.71'
2187	2197307.41'	6319157.35'

