

# CORNER RECORD

Document Number CK-16-57

City of Stockton

County of San Joaquin, California

Brief Legal Description Colonial West, Unit No. 5, Volume 19 of Maps & Plats, Page 84.

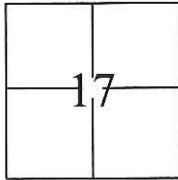

T. 2 N., R. 6 E., M.D.B.&M.

### CORNER TYPE

Government Corner  Control   
 Meander  Property   
 Rancho  Other

Date of Survey October 26, 2015

### COORDINATES(Optional)

N. \_\_\_\_\_  
 E. \_\_\_\_\_  
 Zone III NAD27  NAD83   
 NAD83 Epoch 1991.35  
 Elev. \_\_\_\_\_  
 Vert. Datum: NGVD29  NADV88   
 Meas. Units: Metric  Imperial

Corner - Left as found  Found and tagged  Established  Reestablished  Rebuilt

Identification and type of corner found: Evidence used to identify or procedure used to establish or reestablish the corner:

Used G.P.S. to locate the centerline monuments. Found cut "X"s at lot line projections and used total station set up on centerline monuments to establish location of each found cut "X".

A description of the physical condition of the monument as found and as set or reset: \_\_\_\_\_

Found cut "X"s in concrete, along the approximate property line extended into the right of way, approximately 5 feet from lot corners. Also, found 3/4" iron pipes tagged R.C.E. 15831 in monument wells as shown on page 2.

### SURVEYOR'S STATEMENT

This Corner Record was prepared by me or under my direction in conformance with

the Land Surveyor's Act on October 29, 2015.

Signed [Signature] P.L.S. or R.C.E. No.: 7051

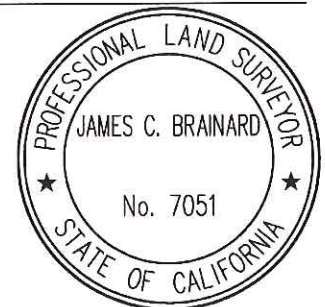

### COUNTY SURVEYOR'S STATEMENT

This Corner Record was received January 11, 2016 and examined

and filed February 9, 2016.

Signed [Signature] P.L.S. or R.C.E. No.: 4842

Title Acting County Surveyor

County Surveyor's Comment \_\_\_\_\_



**STATEMENT OF PURPOSE:**

THE PURPOSE OF THIS SURVEY IS TO IDENTIFY AND RECORD THE LOCATION OF EXISTING MONUMENTS PRIOR TO THE CONSTRUCTION OF PG&E FACILITIES AROUND THE MONUMENTS. THE PURPOSE OF THIS SURVEY IS NOT TO MAKE PROPERTY LINE DETERMINATIONS. LOT LINES SHOWN HEREON ARE FOR GENERAL LOCATION AND INFORMATIONAL PURPOSES ONLY.

**LEGEND:**

- ⊗ INDICATES FOUND CUT CROSS, NO TAG, NO REFERENCE.
- INDICATES FOUND 3/4" IRON PIPES IN WELL TAGGED R.C.E. 15831

**DATUM STATEMENT:**

COORDINATES SHOWN HEREON ARE GRID AND ARE BASED ON CITY OF STOCKTON MONUMENTS 4N-6 AND 4N-10, CALIFORNIA COORDINATE SYSTEM (CCS83), ZONE III, 1983 NAD, (1991.35 EPOCH STOCKTON & SAN JOAQUIN COUNTY GPS ADJUSTMENT) AND SHOWN ON RECORD OF SURVEY BOOK 33 OF SURVEYS, PAGE 20. THE PROJECT SPECIFIC COMBINED SCALE FACTOR IS 0.99994060.

**NOTE:**

FIELD EFFORT INCLUDED A SEARCH FOR EXISTING CUT CROSSES AT THEIR TYPICAL LOCATION, ONLY THOSE FOUND ARE SHOWN.

GRID COORDINATES (U.S. SURVEY FEET)		
POINT	NORTHING	EASTING
2012	2197600.13'	6319006.98'
2013	2197475.34'	6319071.49'
2014	2197495.33'	6319116.43'
2015	2197530.54'	6319305.22'
2172	2197633.71'	6319016.06'
2173	2197572.92'	6319051.16'
2179	2197491.00'	6319319.37'

GRID COORDINATES (U.S. SURVEY FEET)		
POINT	NORTHING	EASTING
2180	2197519.20'	6319345.67'
2181	2197557.13'	6319337.66'
2182	2197572.68'	6319305.68'
2183	2197549.47'	6319247.54'
2184	2197508.22'	6319238.53'
2185	2197539.99'	6319186.54'
2186	2197369.51'	6319138.87'

