

CORNER RECORD

Document Number CR-16-55

City of Stockton

County of San Joaquin, California

Brief Legal Description Colonial West, Unit No. 5, Volume 19 of Maps & Plats, Page 84 and Colonial West, Unit No. 6, Volume 19 of Maps & Plats, Page 89.

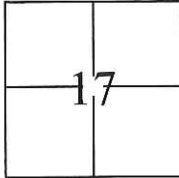

CORNER TYPE

Government Corner Control
Meander Property
Rancho Other

COORDINATES(Optional)

N. _____
E. _____
Zone III NAD27 NAD83
NAD83 Epoch 1991.35
Elev. _____
Vert. Datum: NGVD29 NADV88
Meas. Units: Metric Imperial

T. 2 N., R. 6 E., M.D.B.&M.

Date of Survey October 26, 2015

Corner - Left as found Found and tagged Established Reestablished Rebuilt

Identification and type of corner found: Evidence used to identify or procedure used to establish or reestablish the corner:

Used G.P.S. to locate the centerline monuments. Found cut "X"s at lot line projections and used total station set up on centerline monuments to establish location of each found cut "X".

A description of the physical condition of the monument as found and as set or reset: _____

Found cut "X"s in concrete, along the approximate property line extended into the right of way, approximately 5 feet from lot corners. Also, found 3/4" iron pipes tagged R.C.E. 15831 in monument wells as shown on page 2.

SURVEYOR'S STATEMENT

This Corner Record was prepared by me or under my direction in conformance with the Land Surveyor's Act on October 29, 2015.

Signed [Signature] P.L.S. or R.C.E. No.: 7051

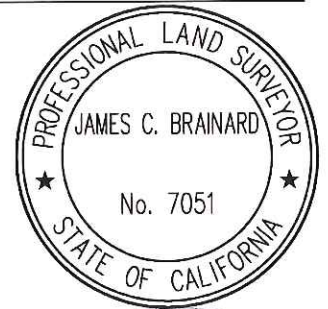

COUNTY SURVEYOR'S STATEMENT

This Corner Record was received January 11, 2016 and examined and filed February 9, 2016.

Signed [Signature] P.L.S. or R.C.E. No.: 4842

Title Acting County Surveyor

County Surveyor's Comment _____



STATEMENT OF PURPOSE:

THE PURPOSE OF THIS SURVEY IS TO IDENTIFY AND RECORD THE LOCATION OF EXISTING MONUMENTS PRIOR TO THE CONSTRUCTION OF PG&E FACILITIES AROUND THE MONUMENTS. THE PURPOSE OF THIS SURVEY IS NOT TO MAKE PROPERTY LINE DETERMINATIONS. LOT LINES SHOWN HEREON ARE FOR GENERAL LOCATION AND INFORMATIONAL PURPOSES ONLY.

LEGEND:

- ⊗ INDICATES FOUND CUT CROSS, NO TAG, NO REFERENCE.
- INDICATES FOUND 3/4" IRON PIPES IN WELL TAGGED R.C.E. 15831

DATUM STATEMENT:

COORDINATES SHOWN HEREON ARE GRID AND ARE BASED ON CITY OF STOCKTON MONUMENTS 4N-6 AND 4N-10, CALIFORNIA COORDINATE SYSTEM (CCS83), ZONE III, 1983 NAD, (1991.35 EPOCH STOCKTON & SAN JOAQUIN COUNTY GPS ADJUSTMENT) AND SHOWN ON RECORD OF SURVEY BOOK 33 OF SURVEYS, PAGE 20. THE PROJECT SPECIFIC COMBINED SCALE FACTOR IS 0.99994060.

NOTE:

FIELD EFFORT INCLUDED A SEARCH FOR EXISTING CUT CROSSES AT THEIR TYPICAL LOCATION, ONLY THOSE FOUND ARE SHOWN.



GRID COORDINATES (U.S. SURVEY FEET)		
POINT	NORTHING	EASTING
2000	2197452.25'	6318153.09'
2001	2197450.46'	6318258.59'
2002	2197566.74'	6318696.32'
2003	2197627.59'	6318700.88'
2004	2197584.47'	6318726.52'
2005	2197804.40'	6318673.76'
2006	2197804.26'	6318651.76'
2188	2197654.14'	6318794.54'
2199	2197432.43'	6318382.47'
2200	2197457.37'	6318504.34'
2201	2197499.74'	6318621.26'

