

CORNER RECORD

Document Number CR-16-54

City of Stockton

County of San Joaquin, California

Brief Legal Description Park North, Unit No. 4, Volume 21 of Maps & Plats, Page 9.

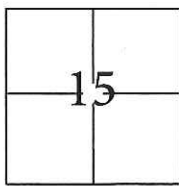

T.2.N., R.6.E., M.D.B.&M.

CORNER TYPE

Government Corner	<input type="checkbox"/>	Control	<input type="checkbox"/>
Meander	<input type="checkbox"/>	Property	<input checked="" type="checkbox"/>
Rancho	<input type="checkbox"/>	Other	<input checked="" type="checkbox"/>

Date of Survey October 28, 2015

COORDINATES(Optional)

N. _____
 E. _____
 Zone III NAD27 NAD83
 NAD83 Epoch _____
 Elev. _____
 Vert. Datum: NGVD29 NADV88
 Meas. Units: Metric Imperial

Corner - Left as found Found and tagged Established Reestablished Rebuilt

Identification and type of corner found: Evidence used to identify or procedure used to establish or reestablish the corner:

Used G.P.S. to locate the centerline monuments. Found cut "X"s at lot line projections and used total station set up on centerline monuments to establish location of each found cut "X".

A description of the physical condition of the monument as found and as set or reset:

Found cut "X"s in concrete, along the approximate property line extended into the right of way, approximately 6 feet from lot corners. Also, found 3/4" iron pipes tagged R.C.E. 7029 in monument wells as shown on page 2.

SURVEYOR'S STATEMENT

This Corner Record was prepared by me or under my direction in conformance with the Land Surveyor's Act on November 2, 2015.

Signed [Signature] P.L.S. or R.C.E. No.: 7051

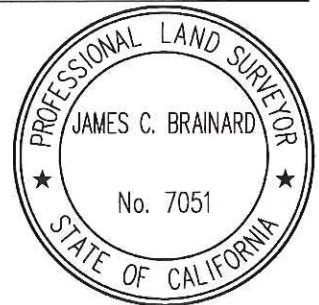

COUNTY SURVEYOR'S STATEMENT

This Corner Record was received January 11, 2016 and examined and filed February 9, 2016.

Signed [Signature] P.L.S. or R.C.E. No.: 4842

Title Acting County Surveyor

County Surveyor's Comment _____

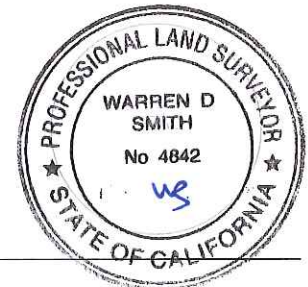

STATEMENT OF PURPOSE:

THE PURPOSE OF THIS SURVEY IS TO IDENTIFY AND RECORD THE LOCATION OF EXISTING MONUMENTS PRIOR TO THE CONSTRUCTION OF PG&E FACILITIES AROUND THE MONUMENTS. THE PURPOSE OF THIS SURVEY IS NOT TO MAKE PROPERTY LINE DETERMINATIONS. LOT LINES SHOWN HEREON ARE FOR GENERAL LOCATION AND INFORMATIONAL PURPOSES ONLY.

LEGEND:

- ⊗ INDICATES FOUND CUT CROSS, NO TAG, NO REFERENCE.
- INDICATES FOUND 3/4" IRON PIPES IN WELL TAGGED R.C.E. 7029

GRID COORDINATES (U.S. SURVEY FEET)		
POINT	NORTHING	EASTING
551	2196637.53'	6332385.22'
552	2196502.37'	6332356.34'
553	2196372.43'	6332356.40'
568	2196749.42'	6332435.28'
574	2196768.84'	6332416.55'
575	2196647.30'	6332363.26'
576	2196635.30'	6332358.18'
577	2196579.62'	6332340.82'
578	2196526.12'	6332333.08'
579	2196502.30'	6332332.35'
580	2196422.20'	6332332.51'
581	2196422.35'	6332380.31'
582	2196482.47'	6332380.24'
583	2196508.44'	6332406.28'
584	2196508.48'	6332502.37'
585	2196523.13'	6332534.71'
586	2196554.94'	6332542.95'
587	2196584.90'	6332518.50'
588	2196622.92'	6332433.36'
589	2196657.14'	6332420.03'

DATUM STATEMENT:

COORDINATES SHOWN HEREON ARE GRID AND ARE BASED ON CITY OF STOCKTON MONUMENTS 1N-6 AND 4N-16, CALIFORNIA COORDINATE SYSTEM (CCS83), ZONE III, 1983 NAD, (1991.35 EPOCH STOCKTON & SAN JOAQUIN COUNTY GPS ADJUSTMENT) AND SHOWN ON RECORD OF SURVEY BOOK 33 OF SURVEYS, PAGE 20. THE PROJECT SPECIFIC COMBINED SCALE FACTOR IS 0.99994059.

NOTE:

FIELD EFFORT INCLUDED A SEARCH FOR EXISTING CUT CROSSES AT THEIR TYPICAL LOCATION, ONLY THOSE FOUND ARE SHOWN.

GRID COORDINATES (U.S. SURVEY FEET)		
POINT	NORTHING	EASTING
591	2196396.40'	6332406.38'
592	2196396.50'	6332451.37'
593	2196396.51'	6332533.03'
597	2196372.66'	6332640.06'
598	2196396.34'	6332306.68'

