

CORNER RECORD

Document Number CR-16-52

City of Stockton

County of San Joaquin, California

Brief Legal Description Park North, Unit No. 4, Volume 21 of Maps & Plats, Page 9 and Summerplace, Unit No. 1, Volume 22 of Maps & Plats, Page 47.

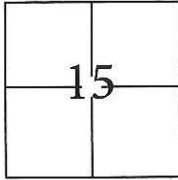

T.2.N., R.6.E., M.D.B.&M.

CORNER TYPE

Government Corner Control
 Meander Property
 Rancho Other

Date of Survey October 28, 2015

COORDINATES(Optional)

N. _____
 E. _____
 Zone III NAD27 NAD83
 NAD83 Epoch _____
 Elev. _____
 Vert. Datum: NGVD29 NADV88
 Meas. Units: Metric Imperial

Corner - Left as found Found and tagged Established Reestablished Rebuilt

Identification and type of corner found: Evidence used to identify or procedure used to establish or reestablish the corner:

Used G.P.S. to locate the centerline monuments. Found cut "X"s at lot line projections and used total station set up on centerline monuments to establish location of each found cut "X".

A description of the physical condition of the monument as found and as set or reset: _____

Found cut "X"s in concrete, along the approximate property line extended into the right of way, approximately 6 feet from lot corners. Also, found 3/4" iron pipes tagged R.C.E. 7029 in monument wells as shown on page 2.

SURVEYOR'S STATEMENT

This Corner Record was prepared by me or under my direction in conformance with the Land Surveyor's Act on November 2, 2015.

Signed [Signature] P.L.S. or R.C.E. No.: 7051



COUNTY SURVEYOR'S STATEMENT

This Corner Record was received January 11, 2016 and examined and filed February 9, 2016.

Signed [Signature] P.L.S. or R.C.E. No.: 4042

Title Acting County Surveyor

County Surveyor's Comment _____

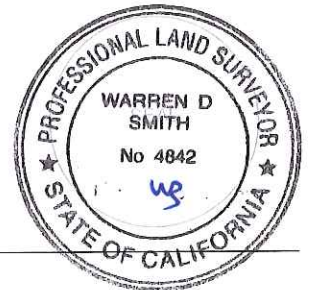

STATEMENT OF PURPOSE:

THE PURPOSE OF THIS SURVEY IS TO IDENTIFY AND RECORD THE LOCATION OF EXISTING MONUMENTS PRIOR TO THE CONSTRUCTION OF PG&E FACILITIES AROUND THE MONUMENTS. THE PURPOSE OF THIS SURVEY IS NOT TO MAKE PROPERTY LINE DETERMINATIONS. LOT LINES SHOWN HEREON ARE FOR GENERAL LOCATION AND INFORMATIONAL PURPOSES ONLY.

LEGEND:

- ⊗ INDICATES FOUND CUT CROSS, NO TAG, NO REFERENCE.
- INDICATES FOUND 3/4" IRON PIPES IN WELL TAGGED R.C.E. 7029

GRID COORDINATES (U.S. SURVEY FEET)		
POINT	NORTHING	EASTING
557	2196433.29'	6331849.00'
558	2196231.87'	6331819.65'
565	2196307.52'	6331892.76'
566	2196476.93'	6331846.17'
606	2196369.80'	6331889.72'
609	2196449.80'	6331872.33'
610	2196476.95'	6331821.10'
611	2196341.83'	6331849.35'
612	2196330.62'	6331854.31'
613	2196300.78'	6331848.53'
614	2196245.35'	6331799.12'
615	2196195.88'	6331765.19'
616	2196146.74'	6331730.70'
617	2196137.80'	6331724.40'

DATUM STATEMENT:

COORDINATES SHOWN HEREON ARE GRID AND ARE BASED ON CITY OF STOCKTON MONUMENTS 1N-6 AND 4N-16, CALIFORNIA COORDINATE SYSTEM (CCS83), ZONE III, 1983 NAD, (1991.35 EPOCH STOCKTON & SAN JOAQUIN COUNTY GPS ADJUSTMENT) AND SHOWN ON RECORD OF SURVEY BOOK 33 OF SURVEYS, PAGE 20. THE PROJECT SPECIFIC COMBINED SCALE FACTOR IS 0.99994059.

