

CORNER RECORD

Document Number CR-15-280

City of Stockton

County of San Joaquin, California

Brief Legal Description Quail Lakes, Unit No. 1, Book of Maps & Plats 21, Pages 25 and Quail Lakes Parcel Map No. 45, Book of Parcel Maps 10, Pages 137.

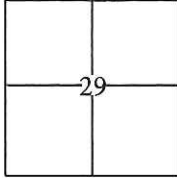

CORNER TYPE

Government Corner Control
 Meander Property
 Rancho Other

COORDINATES(Optional)

N. _____
 E. _____
 Zone _____ NAD27 NAD83
 NAD83 Epoch _____
 Elev. _____
 Vert. Datum: NGVD29 NADV88
 Meas. Units: Metric Imperial

T. 2 N. R. 6 E. M.D.B.&M.

Date of Survey September 10, 2015

Corner - Left as found Found and tagged Established Reestablished Rebuilt

Identification and type of corner found: Evidence used to identify or procedure used to establish or reestablish the corner:
Used G.P.S. to locate centerline monuments and used total station to traverse through centerline monuments as a verification of adjusted G.P.S. values. Found cut "X"s at lot line projections per M&P, 21-25, S.I.C.R. and used total station set up on centerline monuments to establish location of each found cut "X".

A description of the physical condition of the monument as found and as set or reset: _____
Found cut "X"s in concrete, along the approximate property line extended into the right of way, approximately 6 feet from lot corners. Also, found 3/4" iron pins with brass tags stamped R.C.E. 8189 as shown on page 2.

SURVEYOR'S STATEMENT

This Corner Record was prepared by me or under my direction in conformance with the Land Surveyor's Act on September 18, 2015.

Signed [Signature] P.L.S. or R.C.E. No.: 7051

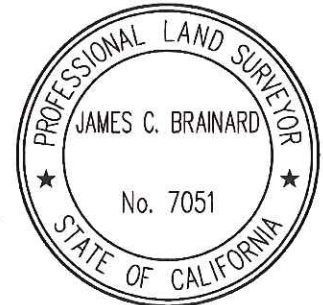

COUNTY SURVEYOR'S STATEMENT

This Corner Record was received October 27, 2015 and examined and filed November 23, 2015.

Signed [Signature] P.L.S. or R.C.E. No.: 4842

Title Acting County Surveyor

County Surveyor's Comment _____

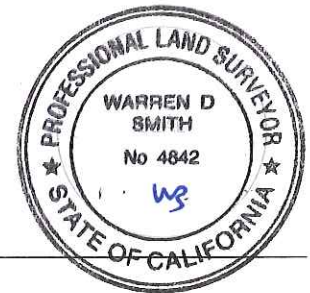

STATEMENT OF PURPOSE:

THE PURPOSE OF THIS SURVEY IS TO IDENTIFY AND RECORD THE LOCATION OF EXISTING MONUMENTS PRIOR TO THE CONSTRUCTION OF PG&E FACILITIES AROUND THE MONUMENTS. THE PURPOSE OF THIS SURVEY IS NOT TO MAKE PROPERTY LINE DETERMINATIONS. LOT LINES SHOWN HEREON ARE FOR GENERAL LOCATION AND INFORMATIONAL PURPOSES ONLY.

NOTE:

FIELD EFFORT INCLUDED A SEARCH FOR EXISTING CUT CROSSES AT THEIR TYPICAL LOCATION, ONLY THOSE FOUND ARE SHOWN.

BASIS OF BEARINGS:

BEARINGS AND DISTANCES SHOWN ON THIS MAP ARE BASED UPON THE CENTERLINE OF MALLARD CREEK CIRCLE AS SHOWN ON THE MAP FILED FOR RECORD IN BOOK 10 OF PARCEL MAPS AT PAGE 137, SAN JOAQUIN COUNTY RECORDS, WHICH BEARS S73°00'W.

LEGEND:

- ⊗ INDICATES FOUND CUT CROSS, NO TAG, NO REFERENCE.
- INDICATES FOUND 3/4" IRON PINS IN WELL WITH BRASS TAGS STAMPED R.C.E. 8189 PER 21 RM 25, S.J.C.R.

MEASURED DATA		
LINE #	BEARING	DISTANCE
L1	N54°58'49"E	152.76'
L2	N72°00'44"E	172.58'
L3	N75°42'19"E	118.35'
L4	N85°30'46"E	65.43'
L5	N25°50'49"W	24.02'
L6	N40°31'13"E	54.53'
L7	N86°35'29"E	76.17'
L8	N1°40'23"W	26.34'
L9	N47°29'18"E	84.35'
L10	N40°53'26"E	35.03'

MEASURED DATA		
LINE #	BEARING	DISTANCE
L11	N72°14'35"W	56.55'
L12	N15°40'00"W	24.42'
L13	N4°20'19"W	23.94'
L14	N4°29'17"W	23.99'
L15	N56°36'28"W	53.63'
L16	N55°50'40"W	52.84'
L17	N1°43'22"E	25.25'
L18	N85°13'06"W	29.18'
L19	N26°31'27"E	46.47'
L20	N54°41'06"E	46.49'

SCALE: 1"=100'

