

CORNER RECORD

Document Number CR-15-274

City of Stockton

County of San Joaquin, California

Brief Legal Description Brookside Estates, Unit No. 18, Book 33 of Maps & Plats, Page 16.

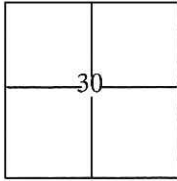

CORNER TYPE

Government Corner Control
 Meander Property
 Rancho Other

COORDINATES(Optional)

N. _____
 E. _____
 Zone III NAD27 NAD83
 NAD83 Epoch 1991.35
 Elev. _____
 Vert. Datum: NGVD29 NADV88
 Meas. Units: Metric Imperial

T. 2 N. R. 6 E. M.D.B.&M.

Date of Survey September 16, 2015

Corner - Left as found Found and tagged Established Reestablished Rebuilt

Identification and type of corner found; Evidence used to identify or procedure used to establish or reestablish the corner:

Found 2 foot swing ties at each street monument location shown but no brass disk inside monument well. Used G.P.S. to locate swing ties and used total station to traverse through swing ties as a verification of adjusted G.P.S. values. Found cut "X"s at lot line projections per M&P, 33-16, S.J.C.R. and used total station set up on swing ties to establish location of each found cut "X".

A description of the physical condition of the monument as found and as set or reset:

Found cut "X"s in concrete, along the approximate property line extended into the right of way, approximately 2 feet from lot corners. Also, found empty monument wells with four nails in pavement at approximate 2 foot offsets. As shown on page 2.

SURVEYOR'S STATEMENT

This Corner Record was prepared by me or under my direction in conformance with the Land Surveyor's Act on September 23, 2015.

Signed [Signature] P.L.S. or R.C.E. No.: 7051

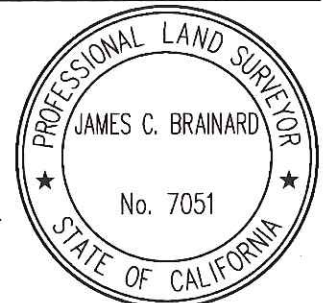

COUNTY SURVEYOR'S STATEMENT

This Corner Record was received October 27, 2015 and examined and filed November 23, 2015.

Signed [Signature] P.L.S. or R.C.E. No.: 4842

Title Acting County Surveyor

County Surveyor's Comment _____



STATEMENT OF PURPOSE:

THE PURPOSE OF THIS SURVEY IS TO IDENTIFY AND RECORD THE LOCATION OF EXISTING MONUMENTS PRIOR TO THE CONSTRUCTION OF PG&E FACILITIES AROUND THE MONUMENTS. THE PURPOSE OF THIS SURVEY IS NOT TO MAKE PROPERTY LINE DETERMINATIONS. LOT LINES SHOWN HEREON ARE FOR GENERAL LOCATION AND INFORMATIONAL PURPOSES ONLY.

DATUM STATEMENT:

COORDINATES SHOWN HEREON ARE GRID AND ARE BASED ON CITY OF STOCKTON MONUMENTS 12N-2 AND 12N-1, CALIFORNIA COORDINATE SYSTEM (CCS83), ZONE III, 1983 NAD, (1991.35 EPOCH STOCKTON & SAN JOAQUIN COUNTY GPS ADJUSTMENT) AND SHOWN ON RECORD OF SURVEY BOOK 33 OF SURVEYS, PAGE 20. THE PROJECT SPECIFIC COMBINED SCALE FACTOR IS 0.99993802.

LEGEND:

- ⊗ INDICATES FOUND CUT CROSS, NO TAG. PER M&P 33-16.
- INDICATES FOUND ROAD NAIL, 2 FOOT SWING TIE
- ⊙ INDICATES FOUND MONUMENT WELL, NO MONUMENT

NOTE:

FIELD EFFORT INCLUDED A SEARCH FOR EXISTING CUT CROSSES AT THEIR TYPICAL LOCATION, ONLY THOSE FOUND ARE SHOWN.

GRID COORDINATES (U.S. SURVEY FEET)		
POINT	NORTHING	EASTING
509	2183463.86'	6311494.50'
2051	2183513.50'	6311473.29'
2052	2183444.77'	6311496.62'
2053	2183440.59'	6311594.63'
2054	2183439.46'	6311644.61'
2055	2183438.31'	6311694.60'
2056	2183434.90'	6311844.55'
2058	2183473.49'	6311820.38'
2059	2183475.72'	6311720.39'
2060	2183478.00'	6311620.34'
2061	2183479.18'	6311570.35'
2114	2183462.00'	6311492.46'
2115	2183459.86'	6311494.45'
2116	2183461.72'	6311496.47'

