

# CORNER RECORD

Document Number CR-15-272

City of Stockton

County of San Joaquin, California

Brief Legal Description Brookside Estates, Unit No. 18, Book 33 of Maps & Plats, Page 16.

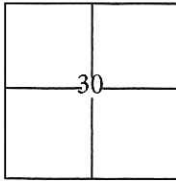

### CORNER TYPE

Government Corner  Control   
 Meander  Property   
 Rancho  Other

### COORDINATES(Optional)

N. \_\_\_\_\_  
 E. \_\_\_\_\_  
 Zone III NAD27  NAD83   
 NAD83 Epoch 1991.35  
 Elev. \_\_\_\_\_  
 Vert. Datum: NGVD29  NADV88   
 Meas. Units: Metric  Imperial

T. 2 N. R. 6 E. M.D.B.&M. Date of Survey September 16, 2015

Corner - Left as found  Found and tagged  Established  Reestablished  Rebuilt

Identification and type of corner found: Evidence used to identify or procedure used to establish or reestablish the corner:

Found 2 foot swing ties at each street monument location shown but no brass disk inside monument well. Used G.P.S. to locate swing ties and used total station to traverse through swing ties as a verification of adjusted G.P.S. values. Found cut "X"s at lot line projections per M&P, 33-16, S.J.C.R. and used total station set up on swing ties to establish location of each found cut "X".

A description of the physical condition of the monument as found and as set or reset: \_\_\_\_\_

Found cut "X"s in concrete, along the approximate property line extended into the right of way, approximately 2 feet from lot corners along Vintage Circle and 4.5 feet along Antique Place. Also, found empty monument wells with four nails in pavement at approximate 2 foot offsets. As shown on page 2.

### SURVEYOR'S STATEMENT

This Corner Record was prepared by me or under my direction in conformance with the Land Surveyor's Act on September 23, 2015.

Signed [Signature] P.L.S. or R.C.E. No.: 7051

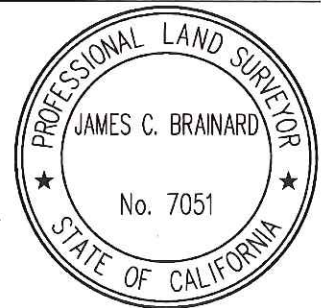

### COUNTY SURVEYOR'S STATEMENT

This Corner Record was received October 27, 2015 and examined and filed November 23, 2015.

Signed [Signature] P.L.S. or R.C.E. No.: 4842

Title Acting County Surveyor

County Surveyor's Comment \_\_\_\_\_

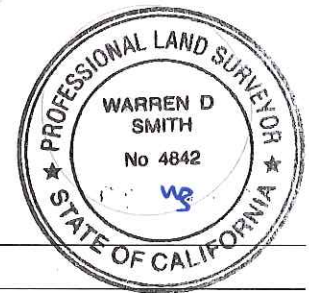

## STATEMENT OF PURPOSE:

THE PURPOSE OF THIS SURVEY IS TO IDENTIFY AND RECORD THE LOCATION OF EXISTING MONUMENTS PRIOR TO THE CONSTRUCTION OF PG&E FACILITIES AROUND THE MONUMENTS. THE PURPOSE OF THIS SURVEY IS NOT TO MAKE PROPERTY LINE DETERMINATIONS. LOT LINES SHOWN HEREON ARE FOR GENERAL LOCATION AND INFORMATIONAL PURPOSES ONLY.

## DATUM STATEMENT:

COORDINATES SHOWN HEREON ARE GRID AND ARE BASED ON CITY OF STOCKTON MONUMENTS 12N-2 AND 12N-1, CALIFORNIA COORDINATE SYSTEM (CCS83), ZONE III, 1983 NAD, (1991.35 EPOCH STOCKTON & SAN JOAQUIN COUNTY GPS ADJUSTMENT) AND SHOWN ON RECORD OF SURVEY BOOK 33 OF SURVEYS, PAGE 20. THE PROJECT SPECIFIC COMBINED SCALE FACTOR IS 0.99993802.

GRID COORDINATES (U.S. SURVEY FEET)		
POINT	NORTHING	EASTING
1011	2183777.82'	6312018.91'
1012	2183858.15'	6312073.31'
1014	2183816.37'	6312090.61'
1015	2183841.27'	6312154.71'
1016	2183875.72'	6312178.82'
1017	2183903.76'	6312168.46'
1018	2183981.99'	6312093.37'
1019	2183992.09'	6312053.44'
1020	2184052.29'	6311973.62'
1031	2184021.23'	6311986.61'
1032	2184018.29'	6311987.15'
1033	2184017.84'	6311984.50'
1034	2184020.75'	6311983.98'
1035	2183948.52'	6312048.06'
2079	2183948.88'	6311953.02'

GRID COORDINATES (U.S. SURVEY FEET)		
POINT	NORTHING	EASTING
2080	2183908.94'	6311922.93'
2081	2183837.86'	6311649.24'
2082	2183853.24'	6311629.08'
2083	2183905.98'	6311843.75'
2084	2183928.92'	6311896.47'
2085	2183968.76'	6311926.63'
2086	2183866.72'	6311667.66'
2087	2183867.13'	6311870.69'
2088	2183864.36'	6311871.11'
2089	2183863.92'	6311868.30'
2110	2183897.67'	6312147.05'
2111	2183897.46'	6312144.12'
2112	2183900.19'	6312143.92'
2113	2183900.43'	6312146.88'



## NOTE:

FIELD EFFORT INCLUDED A SEARCH FOR EXISTING CUT CROSSES AT THEIR TYPICAL LOCATION, ONLY THOSE FOUND ARE SHOWN.

## LEGEND:

- ⊗ INDICATES FOUND CUT CROSS, NO TAG PER M&P 33-16.
- INDICATES FOUND ROAD NAIL, 2 FOOT SWING TIE
- ⊙ INDICATES FOUND MONUMENT WELL, NO MONUMENT

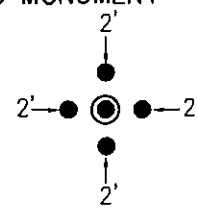

TYPICAL

