

# CORNER RECORD

Document Number CR-15-62

City of Escalon

County of San Joaquin, California

Brief Legal Description Westerly Right-of-Way line of Union Pacific Railroad Company.

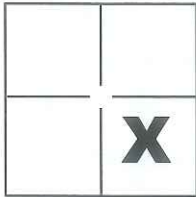

### CORNER TYPE

Government Corner  Control   
 Meander  Property   
 Rancho  Other

### COORDINATES(Optional)

N. \_\_\_\_\_  
 E. \_\_\_\_\_  
 Zone \_\_\_\_\_ NAD27  NAD83   
 NAD83 Epoch \_\_\_\_\_  
 Elev. \_\_\_\_\_  
 Vert. Datum: NGVD29  NADV88   
 Meas. Units: Metric  Imperial

Sec. 8, T.2S., R.9E.,  
M.D.B. & M.

Date of Survey March 30, 2009

Corner - Left as found  Found and tagged  Established  Reestablished  Rebuilt

Identification and type of corner found: Evidence used to identify or procedure used to establish or reestablish the corner:

See Sheet 2

A description of the physical condition of the monument as found and as set or reset: \_\_\_\_\_

See Sheet 2

### SURVEYOR'S STATEMENT

This Corner Record was prepared by me or under my direction in conformance with the Land Surveyor's Act on May 29, 2015.

Signed Michael L. Quartrone P.L.S. or R.C.E. No.: L.S. 4450



### COUNTY SURVEYOR'S STATEMENT

This Corner Record was received June 2, 2015 and examined and filed June 17, 2015.

Signed Warren D. Smith P.L.S. or R.C.E. No.: 4842

Title Acting County Surveyor

County Surveyor's Comment \_\_\_\_\_

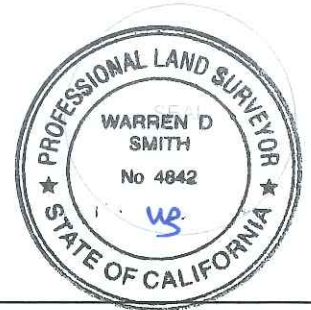

R.S. 27-194  
R.S. 11-177

### CLOUGH ROAD

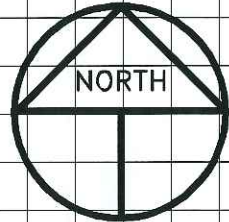

SCALE: 1" = 150'  
2009-40

FD. 3/4" IRON PIN NO  
REFERENCE, CALLED 3/4"  
IRON PIPE PER (A)(B)

### REFERENCES

- (A) P.M. 7-35, S.J.C.R.
- (B) R.S. 34-52, S.J.C.R.

P.M. 7-35  
R.S. 34-52  
R.S. 10-6  
R.S. 16-127

### LEGEND

- INDICATES FOUND MONUMENT AS NOTED
- FD. INDICATES FOUND ON THIS SURVEY
- (M) INDICATES MEASURED THIS SURVEY
- R.S. INDICATES RECORD OF SURVEY, BOOK AND PAGE, S.J.C.R.
- S.J.C.R. INDICATES SAN JOAQUIN COUNTY RECORDS
- P.M. INDICATES PARCEL MAP, BOOK AND PAGE, S.J.C.R.

1320.39' (M)

UNION PACIFIC RAILROAD

McHENRY AVENUE

M. & P. 8-56  
LOT 47

R.S. 7-289

FD. 3/4" IRON PIPE TAGGED RCE 22986, NO REFERENCE, TAG WAS REMOVED FROM MONUMENT TO FACILITATE READING REGISTRATION NUMBER, TAG WAS RESET AND ALSO SET A PLASTIC CAP STAMPED L.S. 4450. I SPOKE WITH ERNIE FREGGIARO, RCE 22986 AND HE HAD NO RECORDS TO REVIEW OR DOCUMENT SETTING THE MONUMENT.

R.S. 14-159  
R.S. 16-195  
P.M. 17-8  
R.S. 30-111

R.S. 14-147