

CORNER RECORD

Document Number CR-15-51
County of SAN JOAQUIN, California

City of MANTECA

Brief Legal Description MOFFAT BOULEVARD, SOUTH EAST 1/4 OF SECTION 4, T. 2 SOUTH, R. 7 EAST, M.D.M. AS SHOWN ON MAP FILED IN BOOK 33 OF SURVEYS, PAGE 196

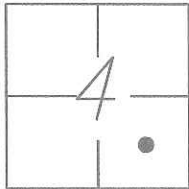

CORNER TYPE

Government Corner Control
Meander Property
Rancho Other

Date of Survey May 27, 2015

COORDINATES (Optional)

N _____
E _____
Zone _____ NAD27 NAD83
NAD83 Epoch _____
Elev. _____
Vert. Datum: NVGD29 NVGD88
Meas. Units: Metric Imperial

Corner— Left as found Found and tagged Established Reestablished Rebuilt

Identification and type of corner found: Evidence used to identify or procedure used to establish or reestablish the corner:
SEE SKETCH ON REVERSE SIDE.

A description of the physical condition of the monument as found and as set or reset: _____
SEE SKETCH ON REVERSE SIDE.
UNTAGGED REFERENCES SET WITH TOPO SURVEY MAY 7, 2014
TAGS ADDED TO REFERENCES MAY 27, 2015 WHEN NOTIFIED PROJECT WOULD NOT PROCEED IN THIS LOCATION.

SURVEYOR'S STATEMENT

This Corner Record was prepared by me or under my direction in conformance with
the Land Surveyors' Act on MAY 27, 2015,

Signed [Signature] P.L.S. or R.C.E. Number 6406

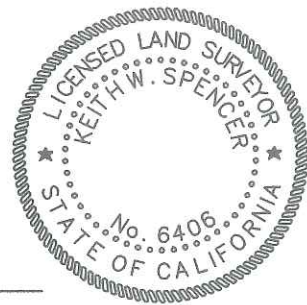

COUNTY SURVEYOR'S STATEMENT

This Corner Record was received June 1, 2015 and examined
and filed June 17, 2015

Signed Warren D. Smith P.L.S. or R.C.E. No: 4842

Title Acting County Surveyor

County Surveyor's Comment _____



