

CORNER RECORD

Document Number CR-15-18
County of San Joaquin, California

City of _____

Brief Legal Description MANCUSO ROAD (KASSON RD TO NORTHEAST END)
WITHIN RANCHO EL PESCADERO

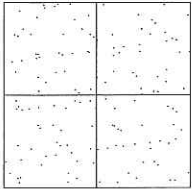

CORNER TYPE

Government Corner Control
Meander Property
Rancho Other

Date of Survey FEBRUARY 5, 2015

COORDINATES (Optional)

N. SEE CHART ON BACKSIDE
E. _____
Zone 3 NAD27 NAD83
NAD83 Epoch 2010.00
Elev. _____
Vert. Datum: NGVD29 NAVD88
Meas. Units: Metric Imperial

Corner - Left as found Found and tagged Established Reestablished Rebuilt

Identification and type of corner found: Evidence used to identify or procedure used to establish or reestablish the corner:
Multiple monuments on the centerline of Mancuso Road were found and surveyed. The coordinates provided on this
corner record are based on California HPGN D CA 10 HG (PID-AA4256), Epoch Date 2010.00.

A description of the physical condition of the monument as found and as set or reset: _____
SEE SKETCH ON BACKSIDE.

SURVEYOR'S STATEMENT

This Corner Record was prepared by me or under my direction in conformance with
the Land Surveyors' Act on February 9, 2015.

Signed James E. Hart P.L.S. Number 8657

COUNTY SURVEYOR'S STATEMENT

This Corner Record was received February 11, 2015 and examined
and filed February 17, 2015.

Signed Warren D. Smith P.L.S. No. 4842

Title Acting County Surveyor

County Surveyor's Comment _____





N.T.S.

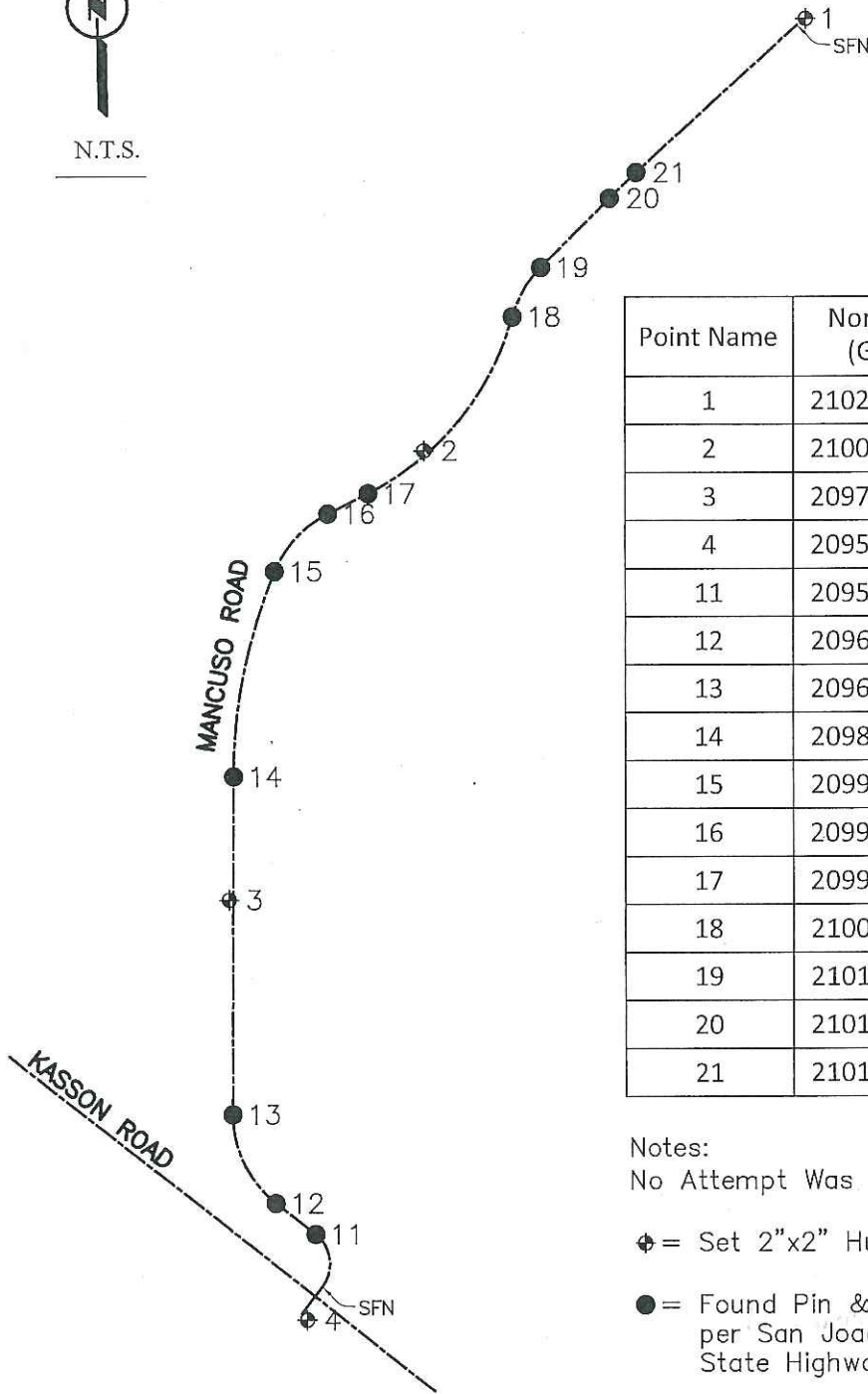

Point Name	Northing (Grid)	Easting (Grid)	Alignment
1	2102426.06	6321008.04	Control
2	2100113.56	6318933.18	Control
3	2097701.36	6317868.43	Control
4	2095446.46	6318285.69	Control
11	2095905.60	6318332.64	EC
12	2096072.81	6318117.53	BC
13	2096548.87	6317885.82	EC
14	2098365.23	6317892.68	BC
15	2099468.81	6318115.86	PCC
16	2099776.54	6318405.54	EC
17	2099885.46	6318627.45	BC
18	2100830.11	6319412.65	PRC
19	2101094.02	6319567.05	EC
20	2101464.40	6319938.94	BC
21	2101602.26	6320084.51	EC

Notes:

No Attempt Was Made to Verify the Monument(s)

⊕ = Set 2"x2" Hub & Tack

● = Found Pin & Washer w/Punch at surface
per San Joaquin County Records
State Highway Map Book 15 Page 43

SFN=Searched Found Nothing

N.T.S.=Not To Scale

BC = Begin Curve

EC = End Curve

PRC = Point of Reverse Curvature

PCC = Point of Compound Curvature

To obtain ground distances, multiply grid inverses
by a factor of 1.000067.