

CORNER RECORD

Document Number CR 15-17

City of _____

County of San Joaquin, California

Brief Legal Description South line of 1.56 acre Parcel Per R.S. 31-99, S.J.C.R.

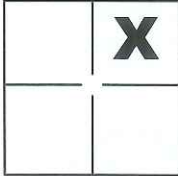

CORNER TYPE

Government Corner Control
 Meander Property
 Rancho Other

COORDINATES(Optional)

N. _____
 E. _____
 Zone _____ NAD27 NAD83
 NAD83 Epoch _____
 Elev. _____
 Vert. Datum: NGVD29 NADV88
 Meas. Units: Metric Imperial

Sec. 35, T.1S., R.7E.,
M.D.B. & M.

Date of Survey January 26, 2015

Corner - Left as found Found and tagged Established Reestablished Rebuilt

Identification and type of corner found: Evidence used to identify or procedure used to establish or reestablish the corner:

See Sheet 2

A description of the physical condition of the monument as found and as set or reset: _____

See Sheet 2

SURVEYOR'S STATEMENT

This Corner Record was prepared by me or under my direction in conformance with
 the Land Surveyor's Act on JAN. 29, 2015.

Signed Michael L. Quarfordt P.L.S. or R.C.E. No.: _____ L.S. 4450



COUNTY SURVEYOR'S STATEMENT

This Corner Record was received February 2, 2015 and examined
 and filed February 5, 2015.

Signed Warren D. Smith P.L.S. or R.C.E. No.: 4842

Title Acting County Surveyor

County Surveyor's Comment _____

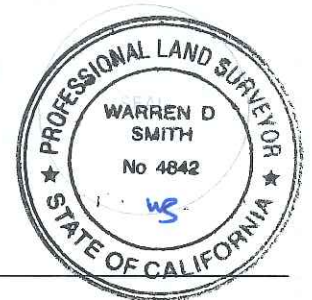

LOUISE AVENUE

20' 20'

20' 30'

S89°03'59"E (M) 257.58'(M)

FD. 3/4" IRON PIPE PER (B), NO TAG,
SET PLASTIC CAP STAMPED L.S. 4450,
CALLED IRON PIN PER (A)

FD. 3/4" IRON PIN W/PLASTIC CAP
STAMPED R.C.E. 14269, NO
REFERENCE, S00°42'32"E 10.00'(M)
FROM 3/4" IRON PIPE

FD. 3/4" IRON PIN PER
(A), NO CAP, SET TAG
STAMPED L.S. 4450, FD.
5/8" REBAR NEXT TO
3/4" IRON PIN, NOT
ACCEPTED

DOC. NO. 2014-103653

R.S. 31-99



SCALE: 1" = 60'
2014-272

REFERENCES

(A) R.S. 31-99, S.J.C.R.
(B) R.S. 8-166, S.J.C.R.

FD. 3/4" IRON PIN PER (A),
BENT, REPLACED AS NOTED

FD. 3/4" IRON PIN PER (A),
DESTROYED
247.61'(M)

44.74' (M)(A)

257.61'(M) 257.75'(A)
S89°03'59"E (M) S89°05'E (A)

DOC. NO. 2005-206973

BASIS OF BEARINGS

THE BASIS OF BEARINGS FOR THIS SURVEY IS THE WEST LINE
OF THE 20.13 ACRE PARCEL, SHOWN ON R.S. 31-99, S.J.C.R.,
AS S.00°42'32"E.

LEGEND

- INDICATES SET 3/4" X 30" IRON PIPE TAGGED L.S. 4450
- INDICATES FOUND MONUMENT AS NOTED
- (M) INDICATES MEASURED THIS SURVEY
- DOC. NO. INDICATES DOCUMENT NUMBER, S.J.C.R.
- R.S. INDICATES RECORD OF SURVEY, BOOK AND PAGE,
- S.J.C.R. INDICATES SAN JOAQUIN COUNTY RECORDS

1303.52'(M) 1303.48'(A) 1302.84'(B)

253.52'(M) 253.74' CALC(A)

S00°42'54"E (M) S00°46'09"E (A)

253.52'(M) 253.74'(A)

208.78'(M) 209.00'(A)

1039.74'(A)

1040.00'(M)

N00°42'32"W (M)(A)

FD. 3/4" IRON PIN W/PLASTIC CAP
STAMPED R.C.E. 14269 PER (A)