

CORNER RECORD

Document Number CR-14-151

City of STOCKTON

County of SAN JOAQUIN, California

Brief Legal Description MONUMENT AT THE INTERSECTION OF ARCH ROAD AND FRONTIER WAY
LOCATED IN THE WEST HALF OF SECTION 28, T.1N, R.7E, M.D.B.&M.

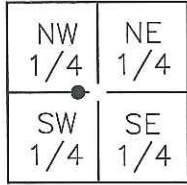

CORNER TYPE

Government Corner Control
 Meander Property
 Rancho Other

COORDINATES (Optional)

N _____
 E _____
 Zone _____ NAD27 NAD83
 NAD83 Epoch _____
 Elev. _____
 Vert. Datum: NVGD29 NVGD88
 Meas. Units: Metric Imperial

SEC. 28 T.1N, R.7E

Date of Survey 5-2-2014

Corner- Left as found Found and tagged Established Reestablished Rebuilt

Identification and type of corner found: Evidence used to identify or procedure used to establish or reestablish the corner:
FOUND 3/4" IRON PIN NOT TAGGED IN MONUMENT WELL, AT THE INTERSECTION OF ARCH ROAD AND
FITE COURT LOCATED IN THE WEST HALF OF SECTION 28, T.1N, R.7E, M.D.B.&M. FOUND MONUMENT AS
SHOWN ON MAP FILED IN BOOK 27 OF MAPS AND PLATS AT PAGE 33, SAN JOAQUIN COUNTY RECORDS.

A description of the physical condition of the monument as found and as set or reset:
MONUMENT IS IN AREA OF RECONSTRUCTION, SET TIES AS SHOWN ON PAGE 2.

SURVEYOR'S STATEMENT

This Corner Record was prepared by me or under my direction in conformance with
 the Land Surveyors' Act on JUNE 5, 2014,



Signed [Signature] P.L.S. or R.C.E. Number 6953

COUNTY SURVEYOR'S STATEMENT

This Corner Record was received June 17, 2014 and examined
 and filed August 6, 2014

Signed [Signature] P.L.S. or R.C.E. No: 26994

Title County Surveyor

County Surveyor's Comment _____

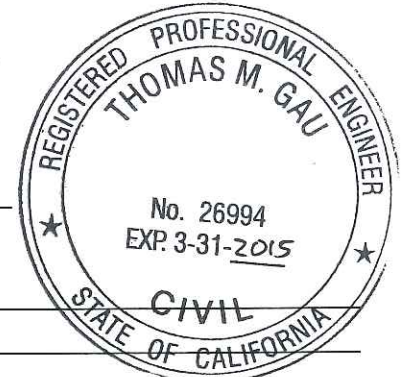

LEGEND:

- ⊗ SET MONUMENT AS NOTED
- FOUND MONUMENT AS NOTED.
- S.J.C.R. DENOTES SAN JOAQUIN COUNTY RECORDS
- M.&P. DENOTES MAPS AND PLATS
- R.S. DENOTES RECORD OF SURVEY
- (M) MEASURED DISTANCE. ALL DISTANCES ARE MEASURED UNLESS NOTED OTHERWISE.

REFERENCE:

- (R1) M.P. 27-33, S.J.C.R.
- (R2) R.S. 32-69, S.J.C.R.

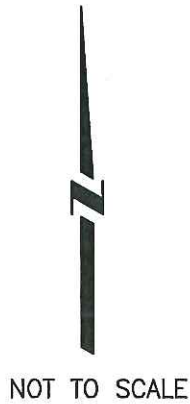

FRONTIER WAY

"B" ⊗ SET CONCRETE NAIL WITH BRASS TAG L.S. 6953 IN PAVEMENT.

X AND DISTANCE TABLE		
BS-@-FS	X	FS DISTANCE
B-A-B	00°00'00"	195.96'
B-A-C	00°00'00"	93.09'
B-A-D	42°19'20"	91.46'
B-A-E	322°45'43"	71.49'

"C" ⊗ SET CONCRETE NAIL WITH BRASS TAG L.S. 6953 IN PAVEMENT.

SET CONCRETE NAIL WITH BRASS TAG L.S. 6953 IN TOP OF CURB BY STOP BAR.

"E" ⊗

"D" ⊗

SET CONCRETE NAIL WITH BRASS TAG L.S. 6953 IN TOP OF CURB BY YIELD SIGN.

SECTION LINE

ARCH ROAD

"A" ●

FOUND 3/4" IRON PIN IN MONUMENT WELL, NOT TAGGED.(R1)(R2)