

# CORNER RECORD

Document Number CR-13-184  
 County of San Joaquin, California

City of \_\_\_\_\_

Brief Legal Description EIGHTH STREET @ BIEGHLE STREET  
SECTION 43 C.M. WEBER GRANT

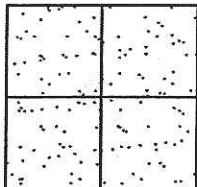

## CORNER TYPE

Government Corner ☐ Control ☐  
 Meander ☐ Property ☐  
 Rancho ☐ Other ☒

Date of Survey March 12, 2013

## COORDINATES (Optional)

N. \_\_\_\_\_  
 E. \_\_\_\_\_  
 Zone \_\_\_\_\_ NAD27 ☐ NAD83 ☐  
 NAD83 Epoch \_\_\_\_\_  
 Elev. \_\_\_\_\_  
 Vert. Datum: NGVD29 ☐ NAVD88 ☐  
 Meas. Units: Metric ☐ Imperial ☒

Corner - Left as found ☐ Found and tagged ☐ Established ☐ Reestablished ☒ Rebuilt ☐

Identification and type of corner found: Evidence used to identify or procedure used to establish or reestablish the corner:  
SEE SKETCH ON BACKSIDE.

A description of the physical condition of the monument as found and as set or reset:  
SEE SKETCH ON BACKSIDE.

## SURVEYOR'S STATEMENT

This Corner Record was prepared by me or under my direction in conformance with  
 the Land Surveyors' Act on May 20, 2013.

Signed James E. Hart P.L.S. No. 8657

## COUNTY SURVEYOR'S STATEMENT

This Corner Record was received May 20, 2013 and examined  
 and filed June 18, 2013.

Signed Thomas M. Gau R.C.E. Number 26994

Title County Surveyor

County Surveyor's Comment \_\_\_\_\_





N.T.S.

Set MAG Nail & Washer stamped "IP" per  
ties FB 697-43. PK Nail & Shiner per FB  
697-43 destroyed in construction.

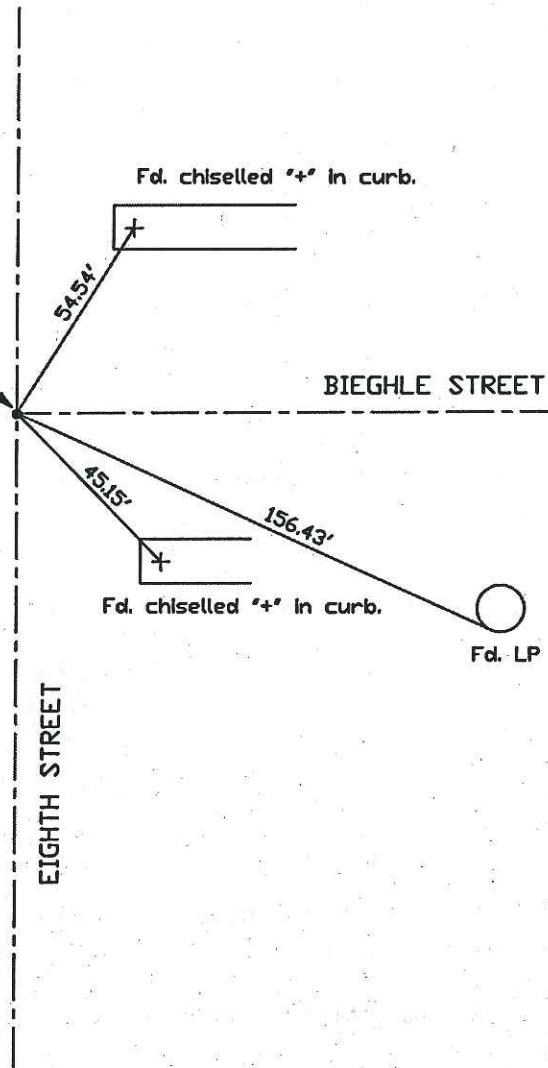

Note: Found Monuments are not tagged  
unless otherwise noted.

"No Attempt Was Made to Verify the Monument(s)"

CCGS=Concrete Curb Gutter Sidewalk

FP=Fence Post

GP=Guy Post

JP=Joint Pole

LP=Lamp Pole

M & P=Maps and Plats

PP=Power Pole

SP=Service Pole

TP=Telephone Pole

S.F.N=Searched Found Nothing

N.T.S.=Not To Scale

Set=Conc. Nail with Brass Washer Stamped

"S.J. Co.", unless otherwise noted