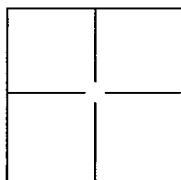

# CORNER RECORD

Document Number CR-13-92

City of \_\_\_\_\_

County of San Joaquin, CaliforniaBrief Legal Description Monuments in Sections 25, T4N R7E, and Sections 30 & 31, T4N R8E, MDB&M**CORNER TYPE**

Government Corner	<input type="checkbox"/>	Control	<input type="checkbox"/>
Meander	<input type="checkbox"/>	Property	<input checked="" type="checkbox"/>
Rancho	<input type="checkbox"/>	Other	<input checked="" type="checkbox"/>

Date of Survey September 3, 2012**COORDINATES(Optional)**

N. \_\_\_\_\_  
E. \_\_\_\_\_  
Zone 3 NAD27 ☐ NAD83 ☒  
NAD83 Epoch \_\_\_\_\_  
Elev. \_\_\_\_\_  
Vert. Datum: NGVD29 ☐ NADV88 ☐  
Meas. Units: Metric ☐ Imperial ☒

Corner - Left as found ☒ Found and tagged ☐ Established ☐ Reestablished ☐ Rebuilt ☐

Identification and type of corner found: Evidence used to identify or procedure used to establish or reestablish the corner:  
Multiple monuments on the centerline of Tully Road & Elliot Road were found and surveyed. This work was done by CLSA Central Valley Chapter volunteers as part of an effort to preserve property corner monuments during San Joaquin County summer chip seal projects. The coordinates shown on this corner record are based on the California Central Valley Control Network, Epoch Date 2012-09-23, Version 1.01. A copy of the control survey is available from KSN in digital form upon request.

A description of the physical condition of the monument as found and as set or reset: See the back of this corner record for a description of found property corner monuments. Monument photos and field notes are available in digital form from KSN or the CLSA California Central Valley Chapter. The combined scale factor for the coordinates shown is 0.9999549553. The mapping angle is -00-23-56. Both the combined scale factor and mapping angle were calculated at Point #306.

**SURVEYOR'S STATEMENT**

This Corner Record was prepared by me or under my direction in conformance with

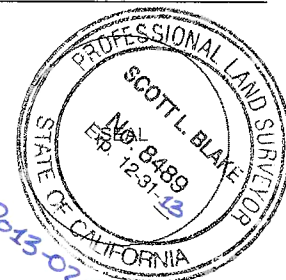
the Land Surveyor's Act on February 1, 2013.Signed [Signature] P.L.S. or R.C.E. No.: PLS 8489**COUNTY SURVEYOR'S STATEMENT**This Corner Record was received APRIL 8, 2013 and examinedand filed MAY 12, 2013.Signed [Signature] P.L.S. or R.C.E. No.: 26994Title COUNTY SURVEYOR

County Surveyor's Comment \_\_\_\_\_

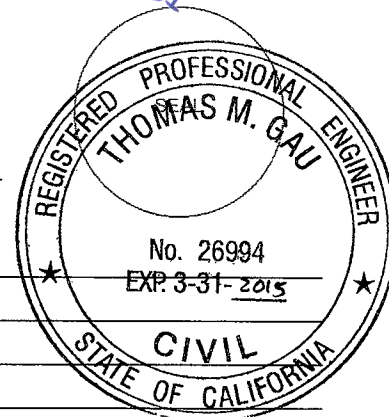

# MONUMENT LIST

POINT NUMBER: 301  
DESCRIPTION: FOUND METAL ROD 22' DEEP IN MONUMENT WELL.  
NORTHING: 2240875.67 EASTING: 6379625.23

POINT NUMBER: 302  
DESCRIPTION: FOUND 1/2" ROD IN 3" HOLE IN PAVEMENT. 3.0' NORTHEAST OF NAIL.  
NORTHING: 2243553.91 EASTING: 6377531.74

POINT NUMBER: 303  
DESCRIPTION: FOUND REBAR AND 1 1/2" YELLOW PLASTIC CAP STAMPED "SJCO PUB WORKS".  
NORTHING: 2244810.89 EASTING: 6376440.67

POINT NUMBER: 304  
DESCRIPTION: FOUND 1/2" METAL ROD IN MONUMENT WELL.  
NORTHING: 2246966.78 EASTING: 6374564.36

POINT NUMBER: 305  
DESCRIPTION: FOUND 1" METAL ROD IN MONUMENT WELL.  
NORTHING: 2246968.23 EASTING: 6374563.16

POINT NUMBER: 306  
DESCRIPTION: FOUND 1/2" METAL ROD IN MONUMENT WELL.  
NORTHING: 2247123.34 EASTING: 6374403.05

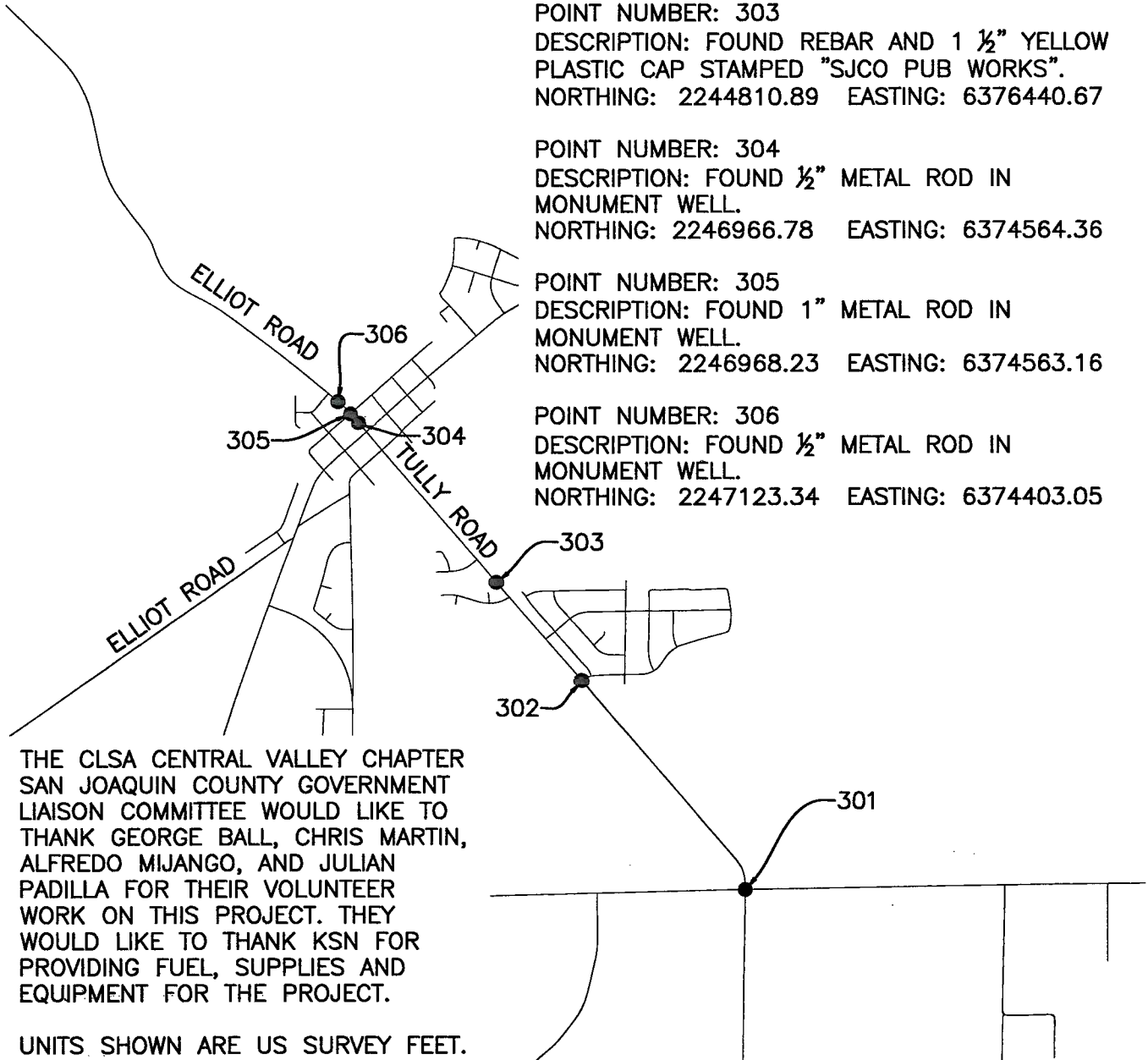

THE CLSA CENTRAL VALLEY CHAPTER  
SAN JOAQUIN COUNTY GOVERNMENT  
LIAISON COMMITTEE WOULD LIKE TO  
THANK GEORGE BALL, CHRIS MARTIN,  
ALFREDO MIJANGO, AND JULIAN  
PADILLA FOR THEIR VOLUNTEER  
WORK ON THIS PROJECT. THEY  
WOULD LIKE TO THANK KSN FOR  
PROVIDING FUEL, SUPPLIES AND  
EQUIPMENT FOR THE PROJECT.

UNITS SHOWN ARE US SURVEY FEET.

**KSN**  
INC.  
CIVIL ENGINEERS  
AND LAND SURVEYORS

711 N. Pershing Avenue  
Stockton, CA 95203-2152  
Office: (209) 946-0268  
Faxes: (209) 946-0296  
E-mail: KSN@ksninc.com

CLSA CENTRAL VALLEY CHAPTER  
SUMMER 2012 SAN JOAQUIN COUNTY  
CHIP SEAL PROJECTS  
CORNER RECORD

Design  
SLB  
Drawn  
SLB  
Check  
BAS

Scale  
1"=2000'  
Original Drawing Scale  
0 1/4" 1/2"

Date  
JANUARY 2013  
Sheet Number  
2 Of 2  
Project File No.