

CORNER RECORD

City of STOCKTON

Document Number

CR-13-83

County of SAN JOAQUIN

, California

Brief Legal Description BEING LOTS 5 AND 6 OF R.S. 16-142.

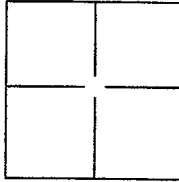

CORNER TYPE

Government Corner ☐ Control ☐
Meander ☐ Property ☒
Rancho ☐ Other ☐

Date of Survey July 7, 2011

COORDINATES(Optional)

N. _____

E. _____

Zone _____ NAD27 ☐ NAD83 ☐

NAD83 Epoch _____

Elev. _____

Vert. Datum: NGVD29 ☐ NADV88 ☐

Meas. Units: Metric ☐ Imperial ☒

Corner - Left as found ☐ Found and tagged ☐ Established ☐ Reestablished ☒ Rebuilt ☐

Identification and type of corner found: Evidence used to identify or procedure used to establish or reestablish the corner:

SEARCHED FOUND NOTHING. SET SURVEY MONUMENT BY USING FOUND MONUMENTS AS SHOWN ON
RECORD OF SURVEY 16-142. SEE ATTACHED PLAT.

A description of the physical condition of the monument as found and as set or reset: SEARCHED FOUND NOTHING, SET
WITH A 3/4" IRON PIN CAPPED L.S. 7600 AND CHISELED CROSSES TAGGED L.S. 7600

SURVEYOR'S STATEMENT

This Corner Record was prepared by me or under my direction in conformance with
the Land Surveyor's Act on JANUARY 4, 2013.

Signed [Signature] P.L.S. or R.C.E. No.: L.S. 7600

COUNTY SURVEYOR'S STATEMENT

This Corner Record was received APRIL 1, 2013 and examined
and filed May 11, 2013.

Signed [Signature] P.L.S. or R.C.E. No.: 26994

Title COUNTY SURVEYOR

County Surveyor's Comment _____

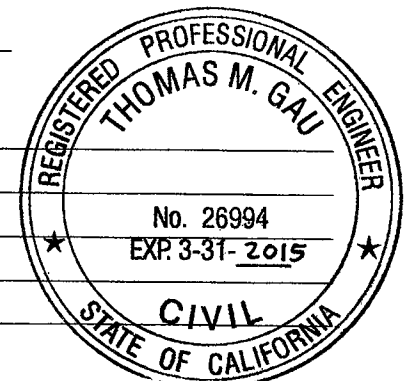
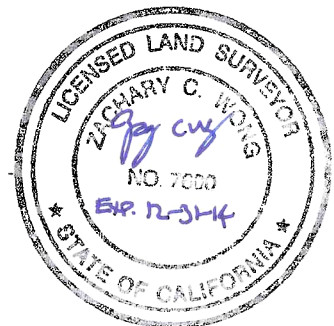

WONG ENGINEERS, INC.

PLANNING ENGINEERING SURVEYING
4578 FEATHER RIVER DRIVE, SUITE A
STOCKTON, CALIFORNIA 95219
(209) 476-0011

BASIS OF BEARINGS:

BEARINGS, DISTANCES, AND COORDINATES ARE BASED ON THE CALIFORNIA COORDINATE SYSTEM 83, ZONE 3 (1991.35). A LINE BETWEEN CITY OF STOCKTON MONUMENTS STOCKTON S.W. BASE 1954 AND NO. 1N-2 WHICH BEARS N32°17'40"W AS CALCULATED FROM COORDINATES SHOWN ON CITY OF STOCKTON TRAVERSE CONTROL MONUMENT SURVEY, FILED FOR RECORD IN BOOK 35 OF SURVEYS, AT PAGE 5, SAN JOAQUIN COUNTY RECORDS. ALL DISTANCES SHOWN ARE GROUND LEVEL DISTANCES AND MUST BE MULTIPLIED BY 0.99993800 TO OBTAIN GRID DISTANCES.

LEGEND:

- L.S. DENOTES LICENSED SURVEYOR
FD. DENOTES FOUND
R.S. DENOTES RECORD OF SURVEY
O DENOTES SET 3/4" IRON PIN, CAPPED L.S. 7600
+ DENOTES SET CHISELED CROSS WITH TAG L.S. 7600
● DENOTES FD. 3/4" IRON ROD PER R.S. 16-142 UNLESS OTHERWISE NOTED
-Z- DENOTES MERGED

REFERENCES:

- (A) R.S. 16-142

