

# CORNER RECORD

Document Number CR-12-15

City of STOCKTON

County of SAN JOAQUIN, California

Brief Legal Description BAY VIEW CIRCLE, M.&P. 34-93, SEC. 31, T.2N., R.6E., M.D.B.&M.

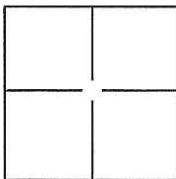

## CORNER TYPE

Government Corner ☐ Control ☐  
Meander ☐ Property ☐  
Rancho ☐ Other ☒

Date of Survey NOVEMBER 22, 2011

## COORDINATES(Optional)

N. \_\_\_\_\_  
E. \_\_\_\_\_  
Zone \_\_\_\_\_ NAD27 ☐ NAD83 ☐  
NAD83 Epoch \_\_\_\_\_  
Elev. \_\_\_\_\_  
Vert. Datum: NGVD29 ☐ NADV88 ☐  
Meas. Units: Metric ☐ Imperial ☐

Corner - Left as found ☐ Found and tagged ☐ Established ☐ Reestablished ☒ Rebuilt ☐

Identification and type of corner found: Evidence used to identify or procedure used to establish or reestablish the corner:

SEE PLAT ON BACK

A description of the physical condition of the monument as found and as set or reset: \_\_\_\_\_

SET 3/4", 30" LONG REBAR WITH CAP ATTACHED AND STAMPED "LS 8247" IN MONUMENT WELL.

## SURVEYOR'S STATEMENT

This Corner Record was prepared by me or under my direction in conformance with  
the Land Surveyor's Act on DECEMBER 19, 2011.

Signed [Signature] P.L.S. or R.C.E. No.: 8247

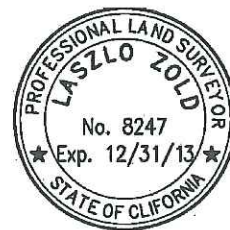

## COUNTY SURVEYOR'S STATEMENT

This Corner Record was received January 9, 2012 and examined  
and filed FEBRUARY 6, 2012

Signed [Signature] P.L.S. or R.C.E. No.: 26994

Title County Surveyor

County Surveyor's Comment \_\_\_\_\_

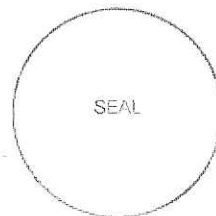

# **LEGEND:**

M.&P. BOOK OF MAPS AND PLATS, VOLUME-PAGE  
 + FOUND CHISELED CROSS PER M.&P. 34-93  
 ⊙ SET 3/4" REBAR, 30" LONG W/CAP ATTACHED AND STAMPED "LS 8247" IN MONUMENT WELL  
 △ FOUND MONUMENT WELL W/2' STRADS, NO MONUMENT IN MONUMENT WELL  
 ● FOUND PK NAIL W/TAG STAMPED "LS 8092" PER CORNER RECORD CR 11-118

| LINE TABLE |             |        |
|------------|-------------|--------|
| LINE #     | DIRECTION   | LENGTH |
| L1         | S14°52'45"W | 35.12' |
| L2         | N60°06'40"E | 24.72' |
| L3         | N74°28'41"W | 35.19' |
| L4         | S3°25'01"W  | 29.09' |
| L5         | S83°00'46"E | 21.26' |
| L6         | S24°15'08"W | 21.00' |
| L7         | N44°44'54"W | 51.41' |
| L8         | N10°25'34"E | 35.61' |
| L9         | N46°09'23"W | 36.35' |
| L10        | N4°11'19"W  | 46.46' |
| L11        | S85°55'11"W | 18.91' |
| L12        | S28°10'40"W | 29.53' |
| L13        | N78°06'36"E | 24.73' |
| L14        | N12°38'08"E | 26.19' |
| L15        | N61°01'01"W | 44.66' |
| L16        | N80°49'51"W | 26.91' |
| L17        | N26°35'02"E | 18.09' |
| L18        | N56°29'19"W | 58.14' |

