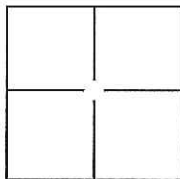

CORNER RECORD

Document Number CR 11-120City of STOCKTONCounty of SAN JOAQUIN, CaliforniaBrief Legal Description BAY VIEW CIRCLE AND BAY VIEW COURT, M.&P. 34-93, SEC. 31, T.2N., R.6E., M.D.B.&M.**CORNER TYPE**

Government Corner	<input type="checkbox"/>	Control	<input type="checkbox"/>
Meander	<input type="checkbox"/>	Property	<input type="checkbox"/>
Rancho	<input type="checkbox"/>	Other	<input checked="" type="checkbox"/>

Date of Survey MAY 13, 2011**COORDINATES(Optional)**

N. _____
E. _____
Zone _____ NAD27 ☐ NAD83 ☐
NAD83 Epoch _____
Elev. _____
Vert. Datum: NGVD29 ☐ NADV88 ☐
Meas. Units: Metric ☐ Imperial ☐

Corner - Left as found ☒ Found and tagged ☐ Established ☐ Reestablished ☐ Rebuilt ☐

Identification and type of corner found: Evidence used to identify or procedure used to establish or reestablish the corner:

SEE PLAT ON BACK

A description of the physical condition of the monument as found and as set or reset:

FOUND 3/4" REBAR WITH CAP ATTACHED AND STAMPED "LS 7079" IN MONUMENT WELL AND
CHISELED CROSS ON LOT LINE PROJECTION PER M.&P. 34-93.

SURVEYOR'S STATEMENT

This Corner Record was prepared by me or under my direction in conformance with
the Land Surveyor's Act on JUNE 14, 2011.

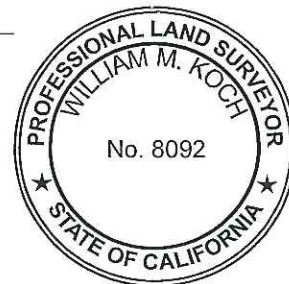
Signed William M. Koch P.L.S. or R.C.E. No.: 8092**COUNTY SURVEYOR'S STATEMENT**

This Corner Record was received JULY 18, 2011 and examined
and filed AUGUST 3, 2011.

Signed Thomas M. Gau P.L.S. or R.C.E. No.: 26994Title COUNTY SURVEYOR

County Surveyor's Comment _____

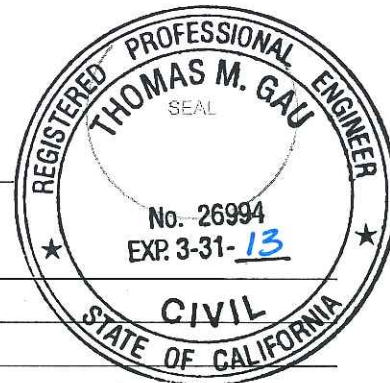

LEGEND:

- M.&P. BOOK OF MAPS AND PLATS, VOLUME-PAGE
 + FOUND CHISELED CROSS PER M.&P. 34-93
 ● FOUND $\frac{3}{4}$ " REBAR W/CAP ATTACHED AND STAMPED "LS 7079" IN MONUMENT WELL PER M.&P. 34-93
 ▲ FOUND MONUMENT WELL W/2' STRADS, NO MONUMENT IN MONUMENT WELL
 ○ SET PK NAIL W/TAG STAMPED "LS 8092"

BASIS OF BEARINGS:

THE CENTERLINE OF BAY VIEW CIRCLE WHICH BEARS S66°28'24"E PER M.&P. 34-93

LINE TABLE		
LINE #	DIRECTION	LENGTH
L1	N47°55'09"E	39.79'
L2	N42°57'59"E	21.98'
L3	S48°34'18"E	33.85'
L4	S71°47'54"E	29.06'
L5	N52°14'43"E	61.48'
L6	N77°54'55"W	39.83'
L7	N59°49'47"E	55.91'
L8	S16°25'19"E	25.56'
L9	N62°31'56"E	50.67'
L10	N7°43'40"W	54.50'
L11	N11°48'01"E	47.58'
L12	N54°25'58"E	74.38'
L13	S28°58'52"E	43.41'
L14	S4°11'20"E	58.03'
L15	S77°03'25"W	36.80'

