

CORNER RECORD

Document Number C.R. 11-51
County of SAN JOAQUIN, California

City of RIPON

Brief Legal Description CENTERLINE MONUMENT AT INTERSECTION OF SPRING CREEK DRIVE WITH MANLEY ROAD, IN THE SOUTHEAST QUARTER OF SECTION 20, T.2S., R.8E., M.D.B.&M.

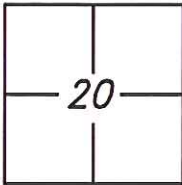

CORNER TYPE

Government Corner ☐ Control ☐
Meander ☐ Property ☐
Rancho ☐ Other ☒

Date of Survey APRIL 13, 2011

COORDINATES (Optional)

N _____
E _____
Zone _____ NAD27 ☐ NAD83 ☐
NAD83 Epoch _____
Elev. _____
Vert. Datum: NVGD29 ☐ NVGD88 ☐
Meas. Units: Metric ☐ Imperial ☐

Corner— Left as found ☐ Found and tagged ☐ Established ☐ Reestablished ☐ Rebuilt ☒

Identification and type of corner found: Evidence used to identify or procedure used to establish or reestablish the corner:
CENTERLINE MONUMENT AT INTERSECTION OF SPRING CREEK DRIVE WITH MANLEY ROAD.

A description of the physical condition of the monument as found and as set or reset: _____
RESET FROM TIES AS SHOWN ON PAGE 2.

SURVEYOR'S STATEMENT

This Corner Record was prepared by me or under my direction in conformance with
the Land Surveyors' Act on APRIL 21, 2011,

Signed [Signature] P.L.S. or R.C.E. Number 6406



COUNTY SURVEYOR'S STATEMENT

This Corner Record was received APRIL 25, 2011 and examined
and filed MAY 19, 2011

Signed Thomas M. Gau P.L.S. or R.C.E. No: 26994

Title INTERIM COUNTY SURVEYOR

County Surveyor's Comment _____

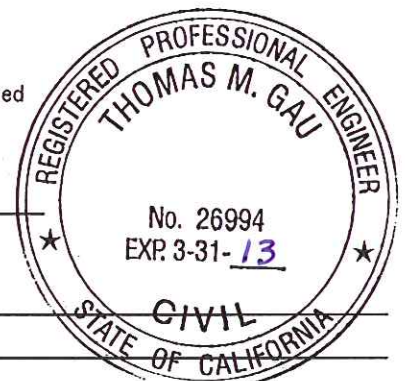

LEGEND:

- FOUND MONUMENT AS NOTED.
- ✕— FOUND NAIL AND TAG L.S.6406 IN PAVEMENT, C.R.-10-55
- SET 3/4" x 24" IRON PIPE, TAGGED L.S.6406 IN MONUMENT WELL
- C.R. CORNER RECORD
- P.M. PARCEL MAPS, BOOK-PAGE, S.J.C.R.
- M.&P. MAPS AND PLATS, BOOK-PAGE, S.J.C.R.
- S.J.C.R. SAN JOAQUIN COUNTY RECORDS
- (A) CORNER RECORD, CR-10-55

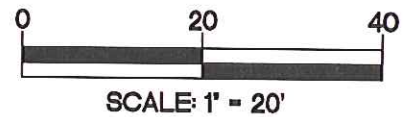

MANLEY ROAD

M.&P., 27-22

WELLS LANE

FOUND 3/4" IRON PIPE TAGGED RCE 29547 IN MONUMENT WELL—
(M.&P., 27-22)

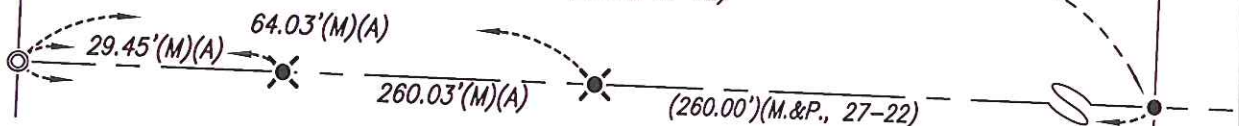

SPRING CREEK DRIVE

M.&P., 27-22

WELLS COURT