

# CORNER RECORD

Document Number CR-10-19  
 City of \_\_\_\_\_ County of San Joaquin, California

Brief Legal Description FRENCH CAMP ROAD 4680± SOUTHEAST OF MURPHY ROAD

(WITHIN SECTION 33, TOWNSHIP 1 SOUTH, RANGE 8 EAST)

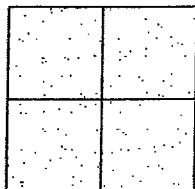

## CORNER TYPE

Government Corner ☐ Control ☐  
 Meander ☐ Property ☐  
 Rancho ☐ Other ☒

Date of Survey November 24, 2009

## COORDINATES (Optional)

N. \_\_\_\_\_  
 E. \_\_\_\_\_  
 Zone \_\_\_\_\_ NAD27 ☐ NAD83 ☐  
 NAD83 Epoch \_\_\_\_\_  
 Elev. \_\_\_\_\_  
 Vert. Datum: NGVD29 ☐ NAVD88 ☐  
 Meas. Units: Metric ☐ Imperial ☒

Corner - Left as found ☐ Found and tagged ☐ Established ☐ Reestablished ☐ Rebuilt ☒

Identification and type of corner found: Evidence used to identify or procedure used to establish or reestablish the corner:  
SEE SKETCH ON BACKSIDE.

A description of the physical condition of the monument as found and as set or reset:  
SEE SKETCH ON BACKSIDE.

## SURVEYOR'S STATEMENT

This Corner Record was prepared by me or under my direction in conformance with the Land Surveyors' Act on 3/9/, 2010.

Signed [Signature] P.L.S. Number 8470

## COUNTY SURVEYOR'S STATEMENT

This Corner Record was received MARCH 10, 2010 and examined and filed MARCH 26, 2010.

Signed Thomas M. Gau R.C.E. No. 23341

Title County Surveyor

County Surveyor's Comment \_\_\_\_\_

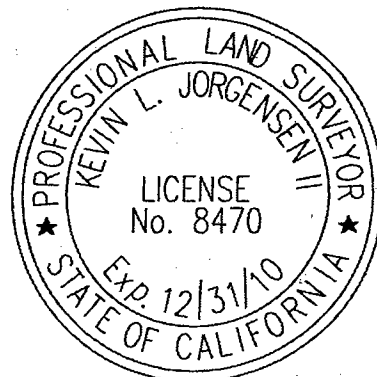

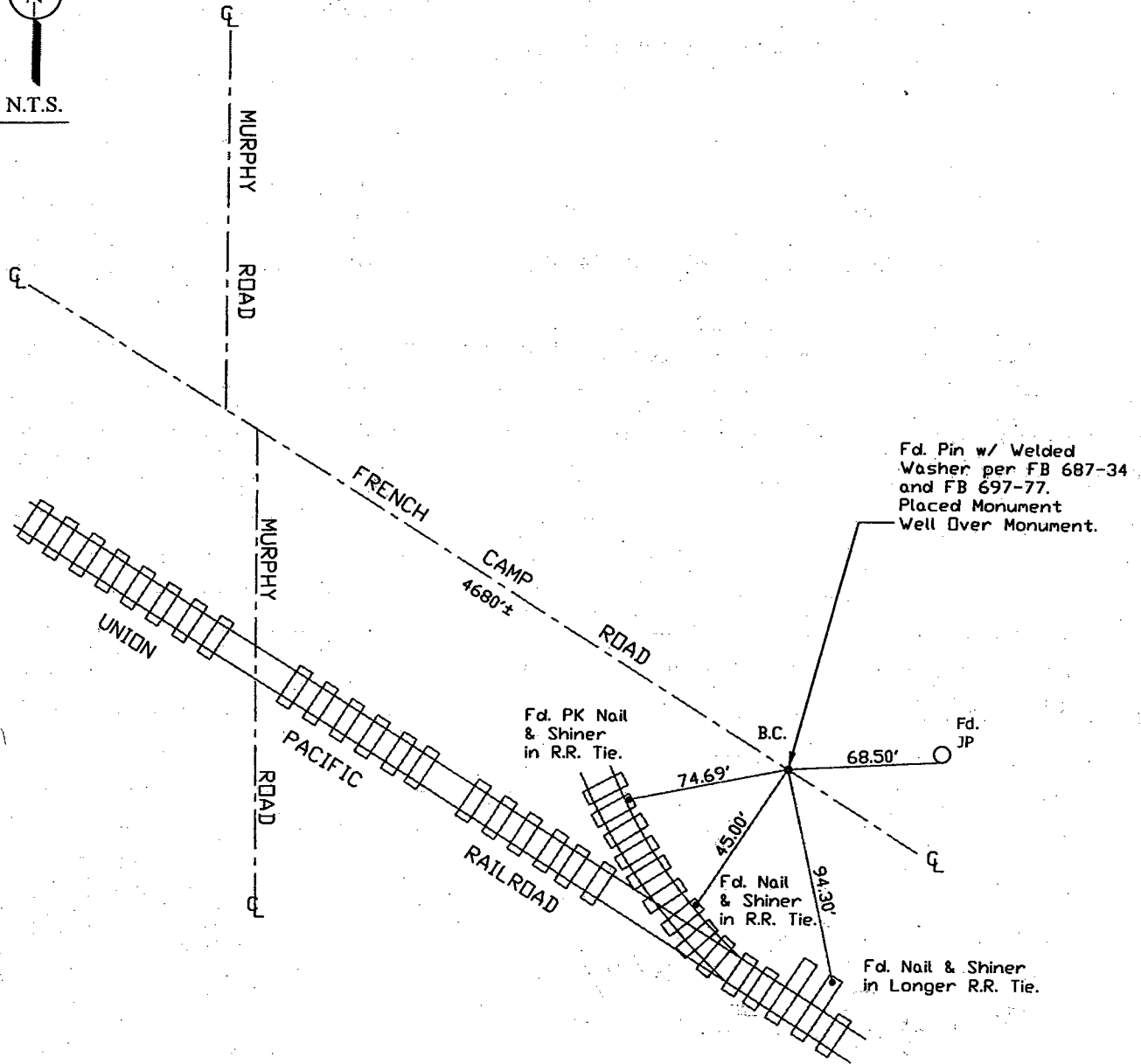

Note: Found Monuments are not tagged nor of Record, Unless otherwise noted.

"No Attempt Was Made to Verify the Monument(s)"

Fd.=Found  
NTS=Not to Scale  
B.C.=Beginning of Curve  
GP=Guy Post  
JP=Joint Pole  
PP=Power Pole  
SP=Service Pole  
TP=Telephone Pole  
S.F.N=Searched Found Nothing  
N.T.S.=Not To Scale  
Fd.=Conc. Nail with Brass Washer Stamped  
"S.J. Co.", unless otherwise noted

0) H.D. 1/1/11

*Handwritten signature: Thomas M. Bear*

12