

CORNER RECORD

Document Number CR-10-14
 City of _____ County of San Joaquin, California

Brief Legal Description FRENCH CAMP ROAD 3350± SOUTHEAST OF MURPHY ROAD

(WITHIN SECTION 33, TOWNSHIP 1 SOUTH, RANGE 8 EAST)

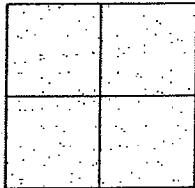

CORNER TYPE

Government Corner ☐ Control ☐
 Meander ☐ Property ☐
 Rancho ☐ Other ☒

Date of Survey November 24, 2009

COORDINATES (Optional)

N. _____
 E. _____
 Zone _____ NAD27 ☐ NAD83 ☐
 NAD83 Epoch _____
 Elev. _____
 Vert. Datum: NGVD29 ☐ NAVD88 ☐
 Meas. Units: Metric ☐ Imperial ☒

Corner - Left as found ☐ Found and tagged ☐ Established ☐ Reestablished ☐ Rebuilt ☒

Identification and type of corner found: Evidence used to identify or procedure used to establish or reestablish the corner:
SEE SKETCH ON BACKSIDE.

A description of the physical condition of the monument as found and as set or reset:
SEE SKETCH ON BACKSIDE.

SURVEYOR'S STATEMENT

This Corner Record was prepared by me or under my direction in conformance with the Land Surveyors' Act on 3/9/2010.

Signed [Signature] P.L.S. Number 8470

COUNTY SURVEYOR'S STATEMENT

This Corner Record was received MARCH 10, 2010 and examined and filed MARCH 26, 2010.

Signed Thomas M. Gau R.C.E. No. 23341

for Title County Surveyor

County Surveyor's Comment _____

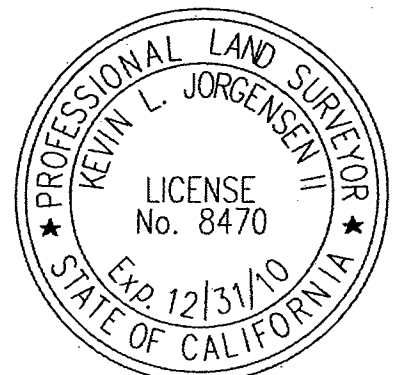



N.T.S.

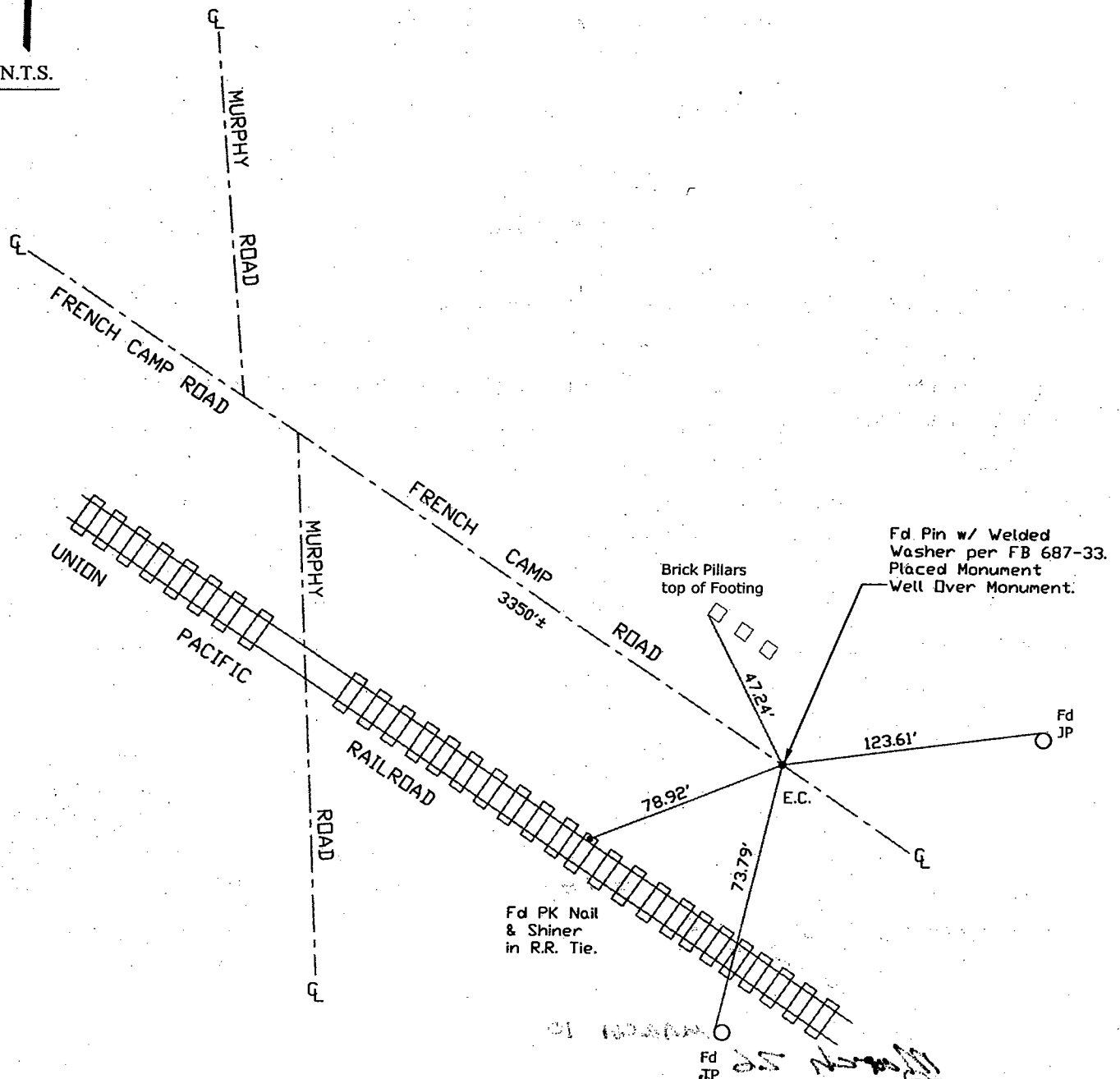

Note: Found Monuments are not tagged nor of Record, Unless otherwise noted.

"No Attempt Was Made to Verify the Monument(s)"

Fd=Found
 NTS=Not to Scale
 E.C.=End of Curve
 GP=Guy Post
 JP=Joint Pole
 PP=Power Pole
 SP=Service Pole
 TP=Telephone Pole
 S.F.N=Searched Found Nothing
 N.T.S.=Not To Scale
 Fd=Conc. Nail with Brass Washer Stamped
 "S.J. Co.", unless otherwise noted