

# CORNER RECORD

Document Number CR-10-05  
 City of \_\_\_\_\_ County of San Joaquin, California

Brief Legal Description FRENCH CAMP ROAD 250± SOUTHEAST OF JACK TONE ROAD

(WITHIN SECTION 30, TOWNSHIP 1 SOUTH, RANGE 8 EAST)

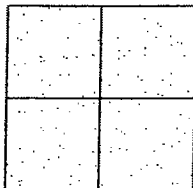

## CORNER TYPE

Government Corner ☐ Control ☐  
 Meander ☐ Property ☐  
 Rancho ☐ Other ☒

Date of Survey November 24, 2009

## COORDINATES (Optional)

N. \_\_\_\_\_  
 E. \_\_\_\_\_  
 Zone \_\_\_\_\_ NAD27 ☐ NAD83 ☐  
 NAD83 Epoch \_\_\_\_\_  
 Elev. \_\_\_\_\_  
 Vert. Datum: NGVD29 ☐ NAVD88 ☐  
 Meas. Units: Metric ☐ Imperial ☒

Corner - Left as found ☐ Found and tagged ☐ Established ☐ Reestablished ☐ Rebuilt ☒

Identification and type of corner found: Evidence used to identify or procedure used to establish or reestablish the corner:  
SEE SKETCH ON BACKSIDE.

A description of the physical condition of the monument as found and as set or reset:  
SEE SKETCH ON BACKSIDE.

## SURVEYOR'S STATEMENT

This Corner Record was prepared by me or under my direction in conformance with  
 the Land Surveyors' Act on 3/9/ 2010.

Signed [Signature] P.L.S. Number 8470

## COUNTY SURVEYOR'S STATEMENT

This Corner Record was received MARCH 10 2010 and examined  
 and filed 3/26 2010.

Signed Thomas M. Gau R.C.E. No. 23341

Title County Surveyor

County Surveyor's Comment \_\_\_\_\_





N.T.S.

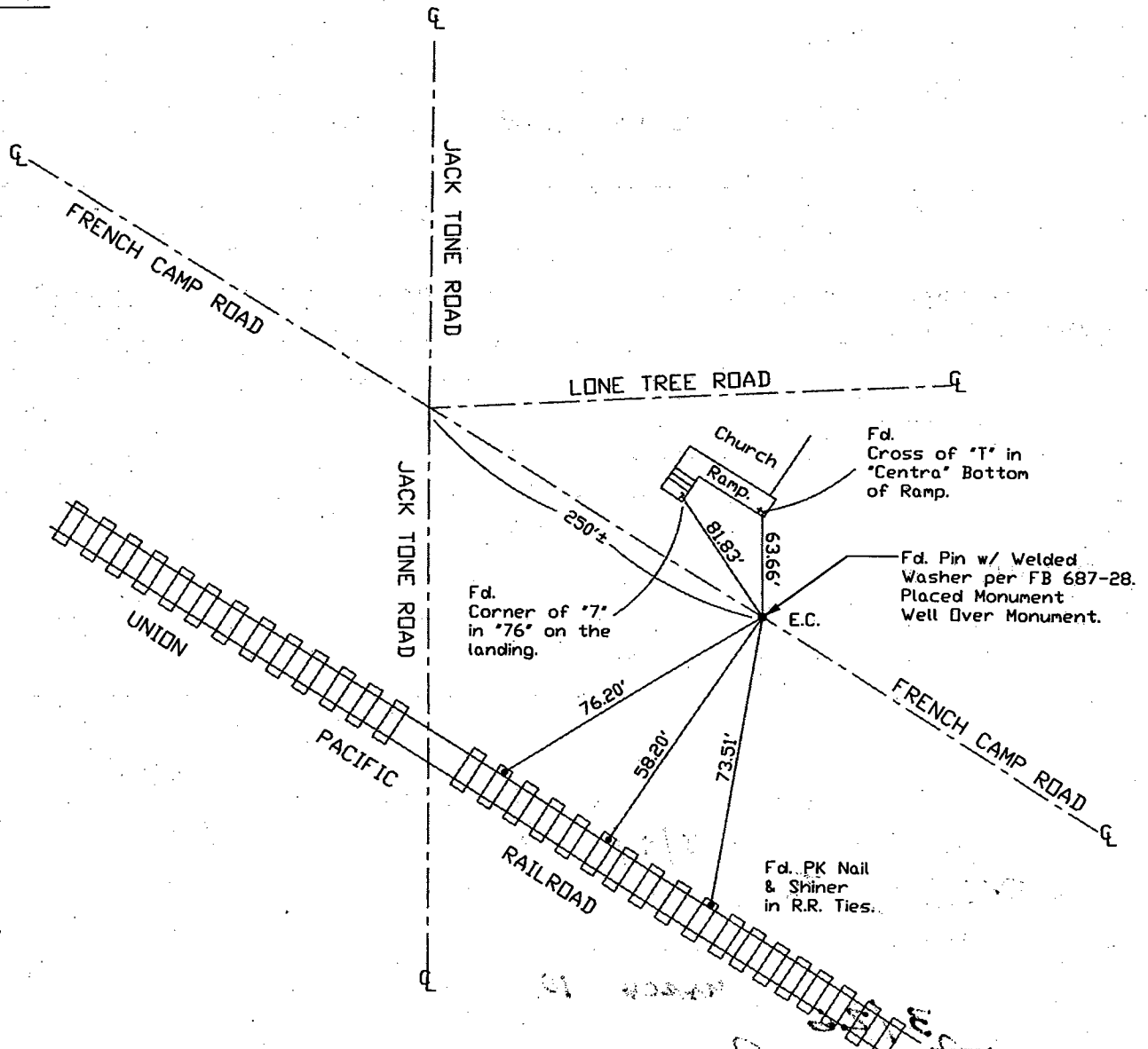

Note: Found Monuments are not tagged nor of Record, Unless otherwise noted.

"No Attempt Was Made to Verify the Monument(s)"

Fd.=Found  
 NTS=Not to Scale  
 E.C.=End of Curve  
 GP=Guy Post  
 JP=Joint Pole  
 PP=Power Pole  
 SP=Service Pole  
 TP=Telephone Pole  
 S.F.N=Searched Found Nothing  
 N.T.S.=Not To Scale  
 Fd.=Conc. Nail with Brass Washer Stamped  
 "S.J. Co.", unless otherwise noted