

# CORNER RECORD

Document Number CR-08-193  
County of San Joaquin, California

City of \_\_\_\_\_

Brief Legal Description HARNEY LANE @ EBERHARD ROAD  
(WITHIN SECTION 19, TOWNSHIP 3 NORTH, RANGE 8 EAST)

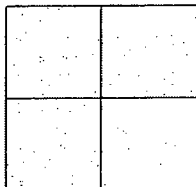

## CORNER TYPE

Government Corner ☐ Control ☐  
Meander ☐ Property ☐  
Rancho ☐ Other ☒

Date of Survey August 5, 2008

## COORDINATES (Optional)

N. \_\_\_\_\_  
E. \_\_\_\_\_  
Zone \_\_\_\_\_ NAD27 ☐ NAD83 ☐  
NAD83 Epoch \_\_\_\_\_  
Elev. \_\_\_\_\_  
Vert. Datum: NGVD29 ☐ NAVD88 ☐  
Meas. Units: Metric ☐ Imperial ☒

Corner - Left as found ☒ Found and tagged ☐ Established ☐ Reestablished ☐ Rebuilt ☐

Identification and type of corner found: Evidence used to identify or procedure used to establish or reestablish the corner:  
SEE SKETCH ON BACKSIDE.

A description of the physical condition of the monument as found and as set or reset:  
SEE SKETCH ON BACKSIDE.

## SURVEYOR'S STATEMENT

This Corner Record was prepared by me or under my direction in conformance with  
the Land Surveyors' Act on Aug. 27, 2008.

Signed Manuel Solorio R.C.E. Number C30890



## COUNTY SURVEYOR'S STATEMENT

This Corner Record was received SEPT. 16TH, 2008 and examined  
and filed SEPT. 17TH, 2008.

Signed John G. May P.L.S. No. 6186  
Title Deputy County Surveyor

Manuel Solorio

County Surveyor's Comment \_\_\_\_\_

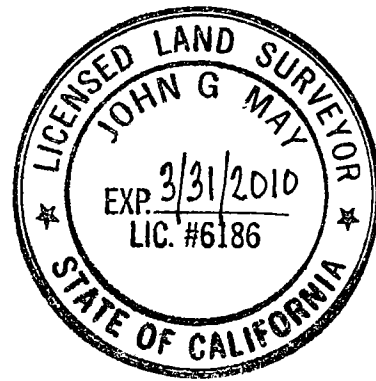

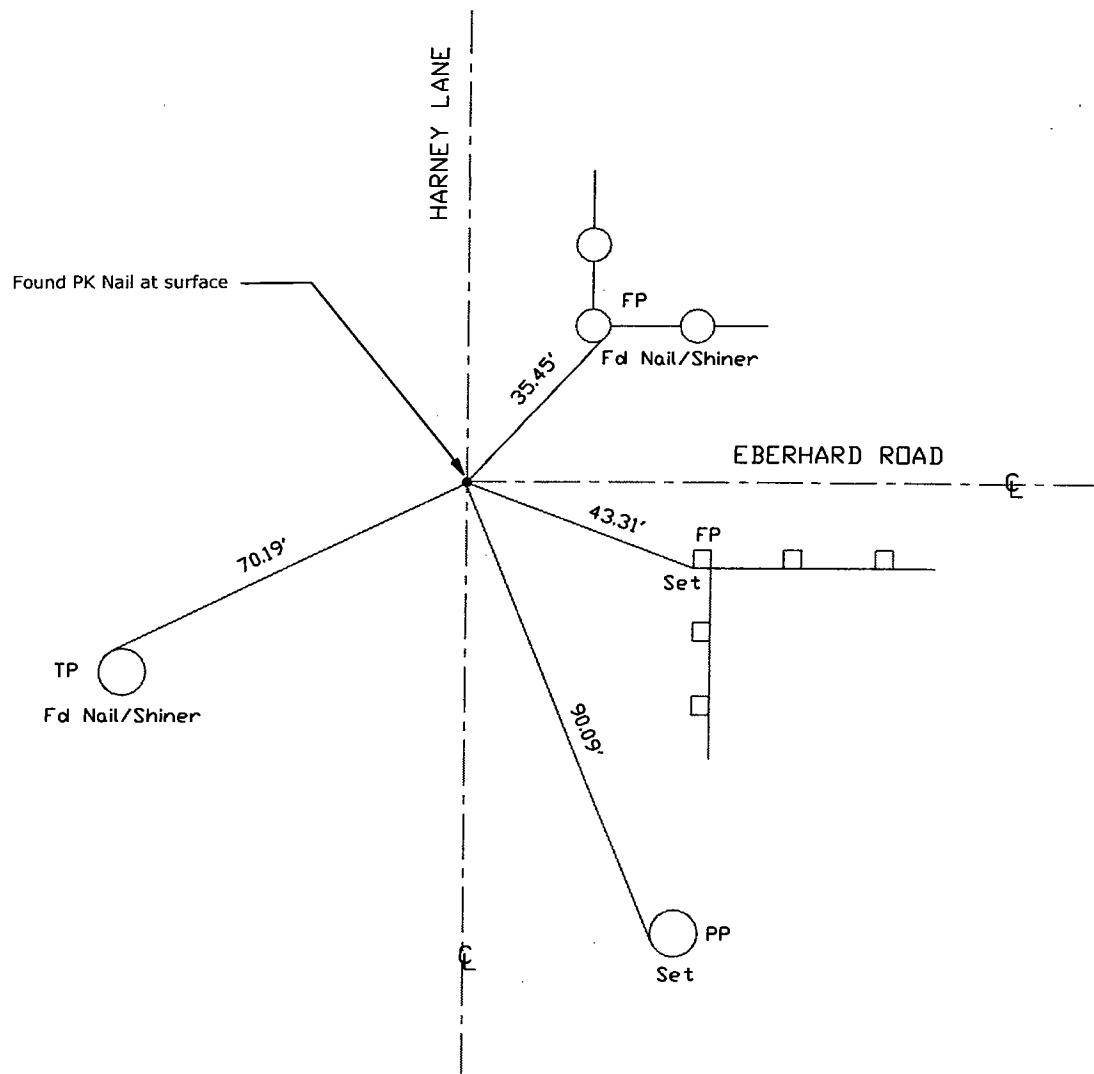
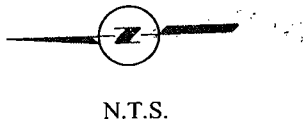

Note: Found Monuments are not tagged unless otherwise noted.

"No Attempt Was Made to Verify the Monument(s)"

FP=Fence Post  
GP=Guy Post  
JP=Joint Pole  
LP=Lamp Pole  
PP=Power Pole  
RS=Record of Survey  
SP=Service Pole  
TP=Telephone Pole  
S.F.N=Searched Found Nothing  
N.T.S.=Not To Scale

Set=Conc. Nail with Brass Washer Stamped  
"S.J. Co.", unless otherwise noted

Note: Set Ties are Brass Washers  
Stamped "S.J.Co. PUBLIC WORKS"