

CORNER RECORD

Document Number CR-08-177
 County of San Joaquin, California

City of _____

Brief Legal Description AUSTIN ROAD 1250' NORTH OF NORTHLAND ROAD
(WITHIN SECTION 22, TOWNSHIP 1 SOUTH, RANGE 7 EAST)

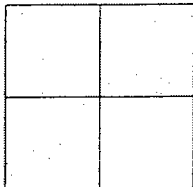

CORNER TYPE

Government Corner ☐ Control ☐
 Meander ☐ Property ☐
 Rancho ☐ Other ☒
 Date of Survey June 27, 2008

COORDINATES (Optional)

N. _____
 E. _____
 Zone _____ NAD27 ☐ NAD83 ☐
 NAD83 Epoch _____
 Elev. _____
 Vert. Datum: NGVD29 ☐ NAVD88 ☐
 Meas. Units: Metric ☐ Imperial ☒

Corner - Left as found ☐ Found and tagged ☐ Established ☐ Reestablished ☐ Rebuilt ☒

Identification and type of corner found: Evidence used to identify or procedure used to establish or reestablish the corner:
SEE SKETCH ON BACKSIDE.

A description of the physical condition of the monument as found and as set or reset:
SEE SKETCH ON BACKSIDE.

SURVEYOR'S STATEMENT

This Corner Record was prepared by me or under my direction in conformance with
 the Land Surveyors' Act on July 17, 2008.

Signed Manuel Solorio R.C.E. Number C30890



Manuel Solorio

COUNTY SURVEYOR'S STATEMENT

This Corner Record was received JULY 24 TH, 2008 and examined
 and filed JULY 25 TH, 2008.

Signed John G. May P.L.S. No. 6186
 Title Deputy County Surveyor



County Surveyor's Comment _____

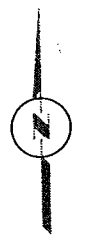

N.T.S.

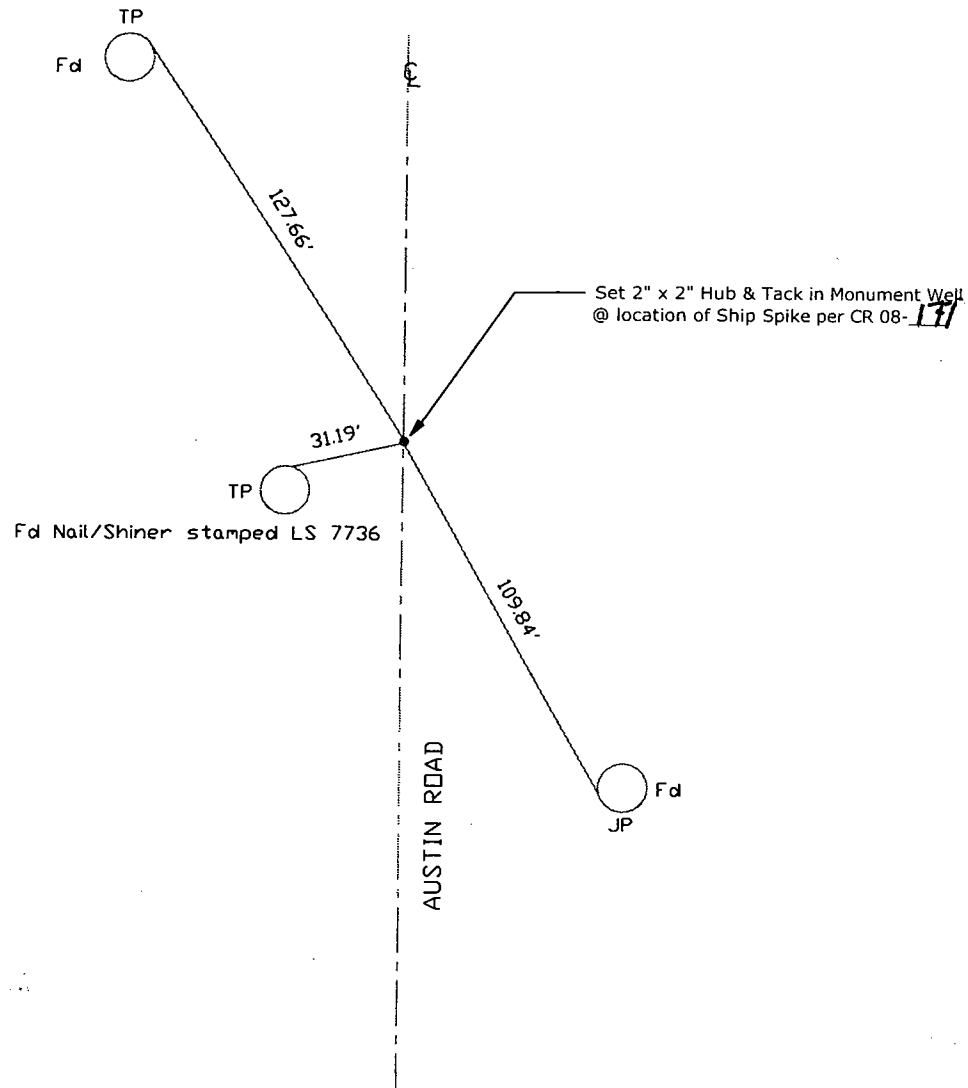

Note: Found Monuments are not tagged
unless otherwise noted.

"No Attempt Was Made to Verify the Monument(s)"

FP=Fence Post
GP=Guy Post
JP=Joint Pole
PP=Power Pole
SP=Service Pole
TP=Telephone Pole
S.F.N=Searched Found Nothing
N.T.S.=Not To Scale
Fd=Conc. Nail with Brass Washer Stamped
"S.J. Co.", unless otherwise noted

Note: Found Ties are Brass Washers
Stamped "S.J.Co. PUBLIC WORKS" per
CR 08-17/ _ unless otherwise noted