

# CORNER RECORD

City of \_\_\_\_\_

Document Number CR-08-104  
County of San Joaquin, California

Brief Legal Description CHRISMAN ROAD NW CORNER SECTION 14

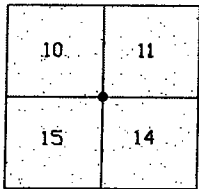

T3S R5E

## CORNER TYPE

Government Corner ☒ Control ☐

Meander ☐ Property ☐

Rancho ☐ Other ☐

Date of Survey June 20, 2005

## COORDINATES (Optional)

N. \_\_\_\_\_

E. \_\_\_\_\_

Zone \_\_\_\_\_ NAD27 ☐ NAD83 ☐

NAD83 Epoch

Elev. \_\_\_\_\_

Vert. Datum: NGVD29 ☐ NAVD88 ☐

Meas. Units:    Metric    ☐    Imperial    ☒

Corner - Left as found ☒ Found and tagged ☐ Established ☐ Reestablished ☐ Rebuilt ☐

Identification and type of corner found: Evidence used to identify or procedure used to establish or reestablish the corner:  
SEE SKETCH ON BACKSIDE.

A description of the physical condition of the monument as found and as set or reset: \_\_\_\_\_  
SEE SKETCH ON BACKSIDE.

### SURVEYOR'S STATEMENT

This Corner Record was prepared by me or under my direction in conformance with the Land Surveyors' Act on March 18, 2008.

Signed Manuel Dolzorio R.C.E. Number C30890



## COUNTY SURVEYOR'S STATEMENT

This Corner Record was received MARCH 24, 2008 and examined and filed MARCH 26, 2008.

Signed *[Signature]* P.L.S. No. 4440

Title Assistant County Surveyor

County Surveyor's Comment

THIS CORNER RECORD IS NOT IN COMPLIANCE WITH BOARD RULE 464(C)

REGARDING SUBMITTAL WITHIN 90 DAYS FROM THE DATE OF SURVEY.

A circular seal for a Professional Land Surveyor. The outer ring contains the text "PROFESSIONAL LAND SURVEYOR" at the top and "STATE OF CALIFORNIA" at the bottom, separated by two stars. The inner circle contains the name "JEFF D. LUND" at the top, "No. 4440" in the center, "Expires" below the number, and "9-30-09" at the bottom, with the "09" underlined.

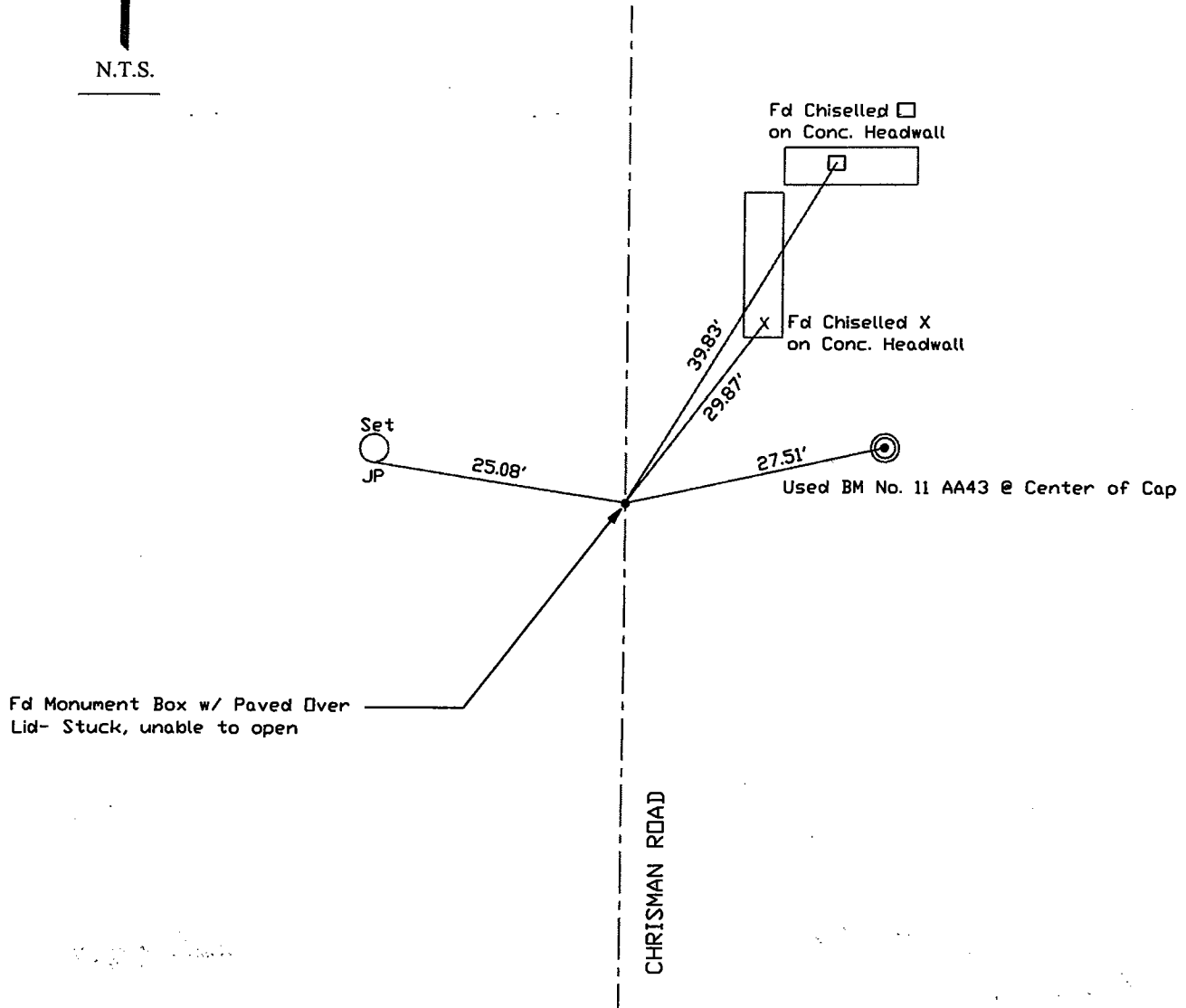
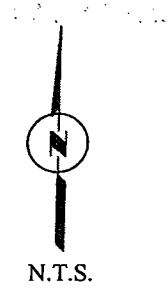

Note: Found Monuments are not tagged unless otherwise noted.

"No Attempt Was Made to Verify the Monument(s)"

Note: Set Ties are Brass Washers Stamped "S.J.Co. PUBLIC WORKS"

FP=Fence Post  
 GP=Guy Post  
 JP=Joint Pole  
 PP=Power Pole  
 SP=Service Pole  
 TP=Telephone Pole  
 S.F.N=Searched Found Nothing  
 N.T.S.=Not To Scale  
 Set=Conc. Nail with Brass Washer Stamped  
 "S.J. Co.", unless otherwise noted