

City of \_\_\_\_\_

Document Number CR-08-49  
County of San Joaquin, California

Brief Legal Description HEWITT ROAD NW CORNER SECTION 7

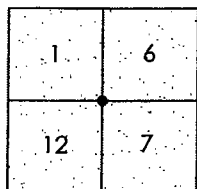

T1N R8E T1N R9E

Government Corner ☒ Control ☐  
 Meander ☐ Property ☐  
 Rancho ☐ Other ☐

Date of Survey January 16, 2008

N. \_\_\_\_\_  
E. \_\_\_\_\_  
Zone \_\_\_\_\_ NAD27 ☐ NAD83 ☐  
NAD83 Epoch \_\_\_\_\_  
Elev. \_\_\_\_\_  
Vert. Datum: NGVD29 ☐ NAVD88 ☐  
Meas. Units: Metric ☐ Imperial ☒

Corner - Left as found ☒ Found and tagged ☐ Established ☐ Reestablished ☐ Rebuilt ☐

Identification and type of corner found: Evidence used to identify or procedure used to establish or reestablish the corner:  
SEE SKETCH ON BACKSIDE.

A description of the physical condition of the monument as found and as set or reset:  
SEE SKETCH ON BACKSIDE.

This Corner Record was prepared by me or under my direction in conformance with the Land Surveyors' Act on Jan. 30, 2008.

Signed Manuel Lopez R.C.E. Number C30890



This Corner Record was received JANUARY 31, 2008 and examined  
and filed FEBRUARY 4, 2008.

Signed *[Signature]* P.L.S. No. 4440

Title Assistant County Surveyor

County Surveyor's Comment\_\_\_\_\_

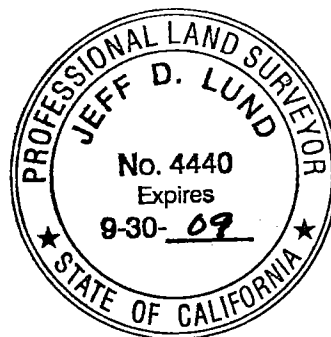



N.T.S.

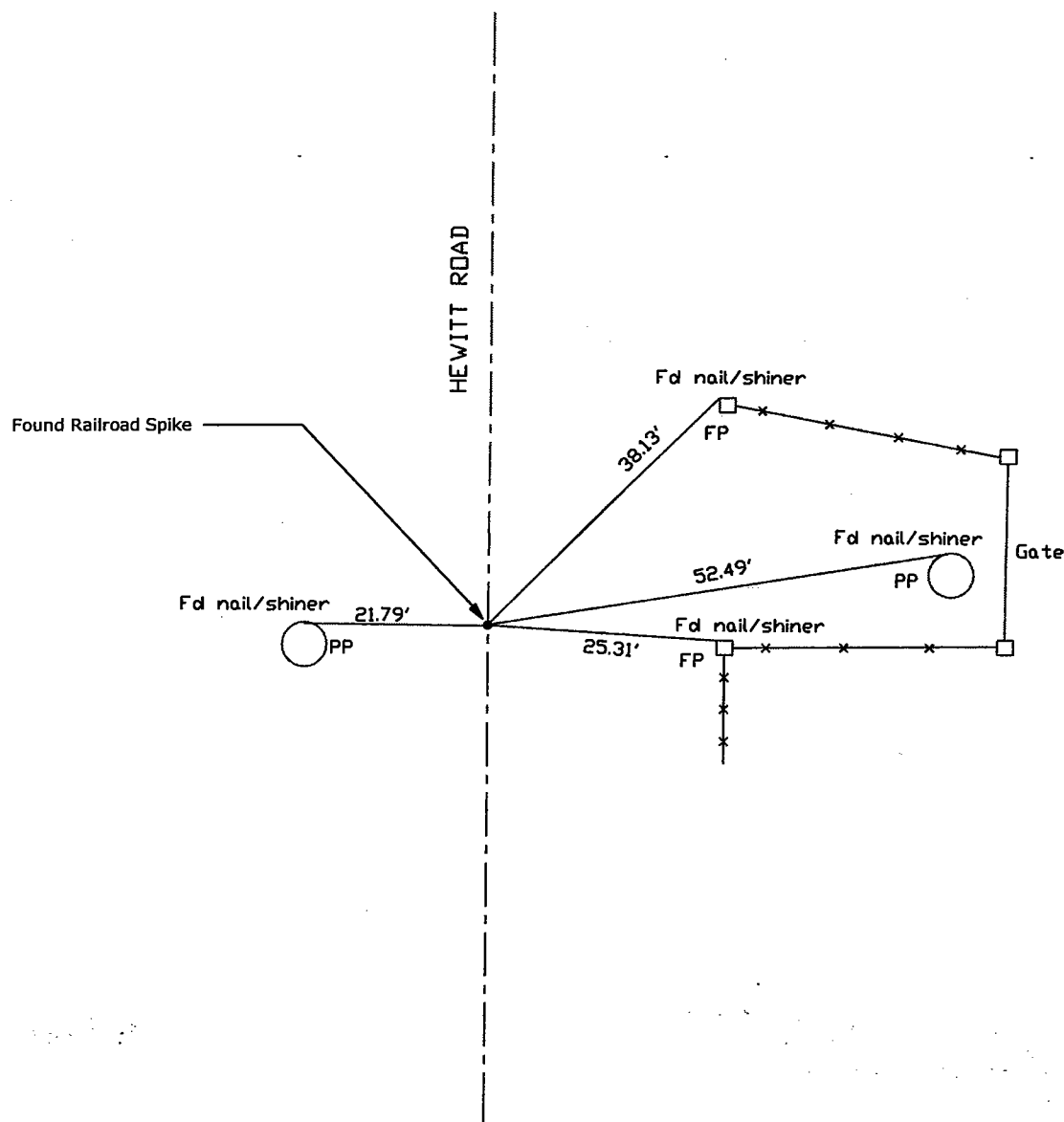

Note: Found Monuments are not tagged unless otherwise noted.

"No Attempt Was Made to Verify the Monument(s)"

FP=Fence Post  
 GP=Guy Post  
 JP=Joint Pole  
 PP=Power Pole  
 SP=Service Pole  
 TP=Telephone Pole  
 S.F.N=Searched Found Nothing  
 N.T.S.=Not To Scale  
 Set=Conc. Nail with Brass Washer Stamped  
 "S.J. Co.", unless otherwise noted

Note: Set Ties are Brass Washers  
 Stamped "S.J.Co. PUBLIC WORKS"