

# CORNER RECORD

Document Number CR-08-25  
 County of San Joaquin, California

City of                     

Brief Legal Description TRETHEWAY ROAD @ KETTLEMAN LANE

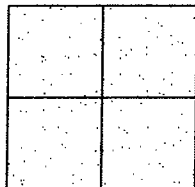

## CORNER TYPE

Government Corner ☐ Control ☐  
 Meander ☐ Property ☐  
 Rancho ☐ Other ☒

Date of Survey June 21, 2005

## COORDINATES (Optional)

N.                       
 E.                       
 Zone                      NAD27 ☐ NAD83 ☐  
 NAD83 Epoch                       
 Elev.                       
 Vert. Datum: NGVD29 ☐ NAVD88 ☐  
 Meas. Units: Metric ☐ Imperial ☒

Corner - Left as found ☒ Found and tagged ☐ Established ☐ Reestablished ☐ Rebuilt ☐

Identification and type of corner found: Evidence used to identify or procedure used to establish or reestablish the corner:  
SEE SKETCH ON BACKSIDE.

A description of the physical condition of the monument as found and as set or reset:  
SEE SKETCH ON BACKSIDE.

## SURVEYOR'S STATEMENT

This Corner Record was prepared by me or under my direction in conformance with  
 the Land Surveyors' Act on Jan. 10, 2008.

Signed Manuel Solario R.C.E. Number C30890

## COUNTY SURVEYOR'S STATEMENT

This Corner Record was received JANUARY 17, 2008 and examined  
 and filed JANUARY 18, 2008.

Signed Jeff D. Lund P.L.S. No. 4440  
 Title Assistant County Surveyor

County Surveyor's Comment                       
THIS CORNER RECORD IS NOT IN COMPLIANCE WITH BOARD RULE 464(c)  
REGARDING SUBMITTAL WITHIN 90 DAYS FROM THE DATE OF SURVEY.



Manuel Solario





N.T.S.

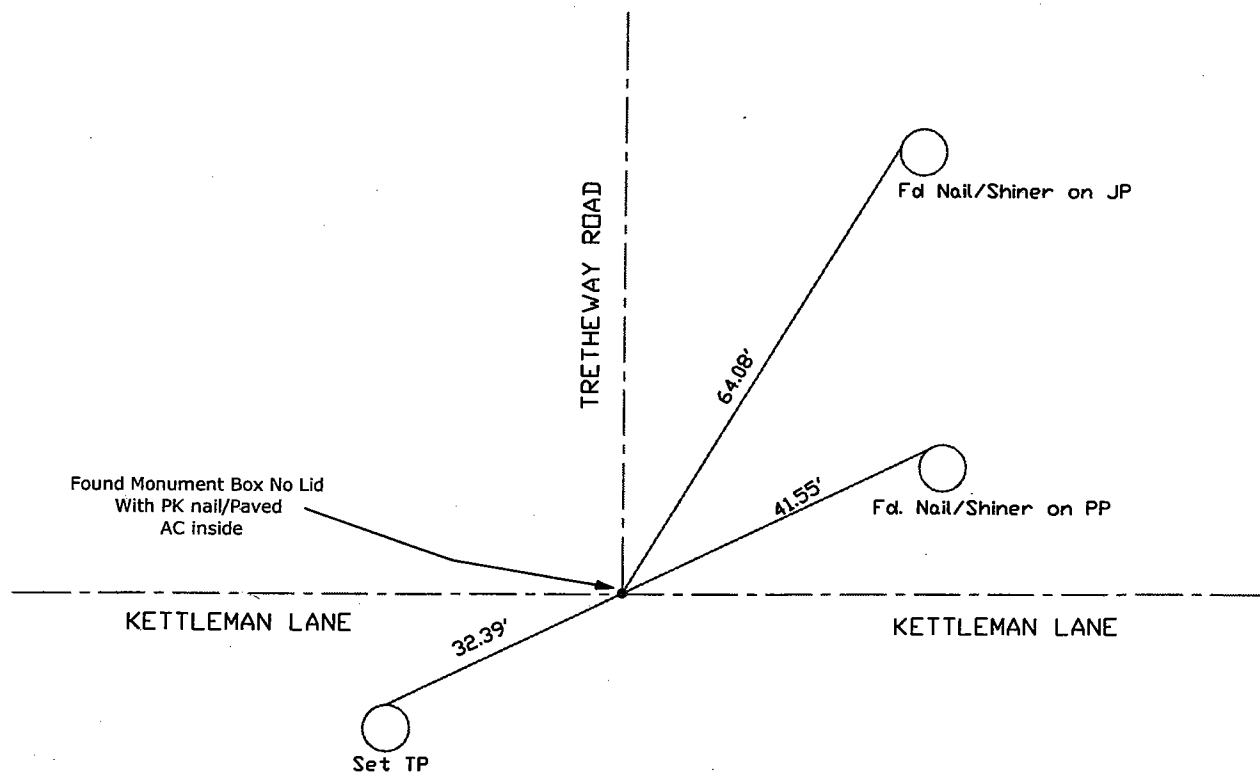

Note: Found Monuments are not tagged unless otherwise noted.

"No Attempt Was Made to Verify the Monument(s)"

FP=Fence Post  
 GP=Guy Post  
 JP=Joint Pole  
 PP=Power Pole  
 SP=Service Pole  
 TP=Telephone Pole  
 S.F.N=Searched Found Nothing  
 N.T.S.=Not To Scale  
 Set=Conc. Nail with Brass Washer Stamped  
 "S.J. Co.", unless otherwise noted

Note: Set Ties are Brass Washers Stamped "S.J.Co. PUBLIC WORKS"