

City of _____

Brief Legal Description INDIANA STREET @ LA SALLE STREET IN WOODBRIDGE

Identification and type of corner found: Evidence used to identify or procedure used to establish or reestablish the corner:
SEE SKETCH ON BACKSIDE.

A description of the physical condition of the monument as found and as set or reset: _____
SEE SKETCH ON BACKSIDE.

This Corner Record was prepared by me or under my direction in conformance with the Land Surveyors' Act on Jan. 4, 2008.

Signed Manuel H. Ruiz R.C.E. Number C30890

This Corner Record was received JANUARY 7, 2008 and examined and filed JANUARY 10, 2008.

Signed  P.L.S. No. 4440
Title Assistant County Surveyor

County Surveyor's Comment _____
THIS CORNER RECORD IS NOT IN COMPLIANCE WITH BOARD RULE 464(c)
REGARDING SUBMITTAL WITHIN 90 DAYS FROM THE DATE OF SURVEY.



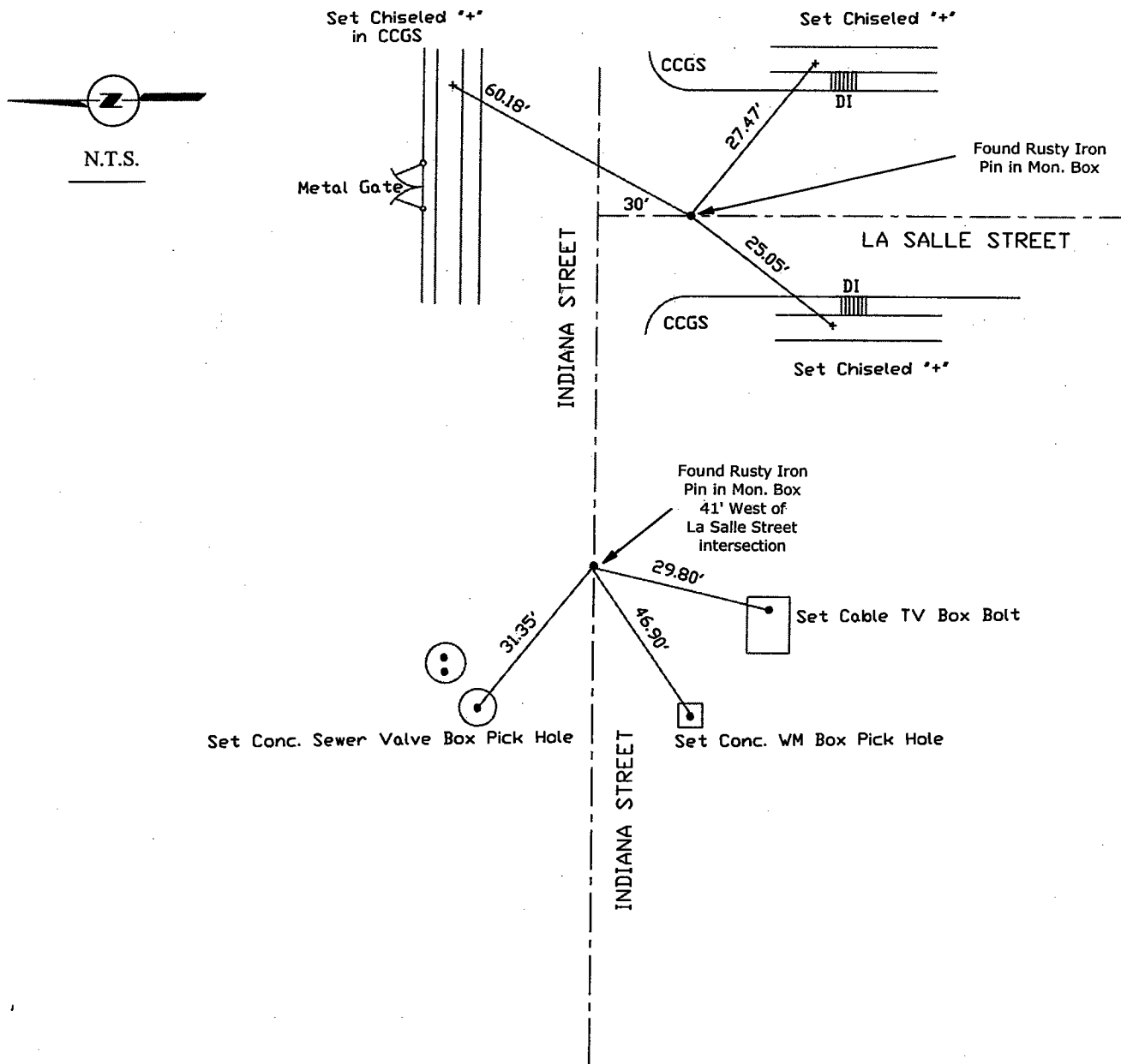

Note: Found Monuments are not tagged unless otherwise noted.

"No Attempt Was Made to Verify the Monument(s)"

WM=Water Meter
DI=Drainage Inlet
CCGS=Concrete Curb Gutter Sidewalk
PP=Power Pole
SP=Service Pole
TP=Telephone Pole
S.F.N=Searched Found Nothing
N.T.S.=Not To Scale
Set=Conc. Nail with Brass Washer Stamped
"S.J. Co.", unless otherwise noted

Note: Set Ties are Brass Washers
Stamped "S.J.Co. PUBLIC WORKS"