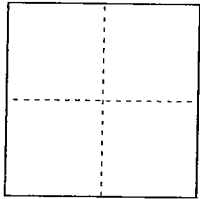
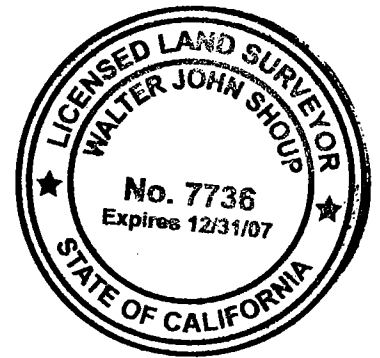
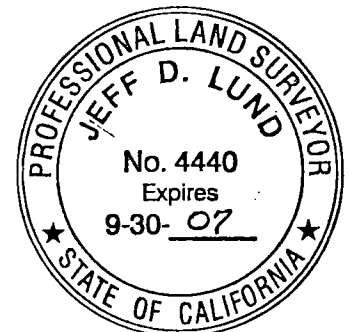

**CORNER RECORD**City of                     Document Number 07-16  
County of San Joaquin, CaliforniaBrief Legal Description RETRACEMENT SURVEY OF PARCEL 2 AS SHOWN ON R.S. 30-121, BEING  
A PORTION OF SECTION 93, C.M. WEBER GRANT, LOCATED ON THE WEST SIDE OF TULSA  
AVENUE AND SOUTH OF ADA AVENUE IN SAN JOAQUIN COUNTY, CA.**CORNER TYPE**Government Corner      Control  
Meander                      Property ☐  
Rancho                        OtherDate of Survey MAY 17, 2007**COORDINATES (Optional)**N.                       
E.                       
Zone                      NAD27 NAD83  
NAD83 Epoch                       
Elev.                       
Vert. Datum: NGVD29 NAVD88  
Meas. Units: Metric Imperial ☐Corner - Left as found ☐ Found and tagged ☐ Established Reestablished ☐ RebuiltIdentification and type of corner found: Evidence used to identify or procedure used to establish or reestablish the corner:  
SEE SKETCH ON BACKSIDEA description of the physical condition of the monument as found and as set or reset:                       
FOUND MONUMENTS IN GOOD CONDITION, SEE SKETCH ON BACKSIDE**SURVEYOR'S STATEMENT**This Corner Record was prepared by me or under my direction in conformance with  
the Land Surveyors' Act on MAY 23, 2007.Signed Walter John Shoup L.S. Number 7736**COUNTY SURVEYOR'S STATEMENT**This Corner Record was received MAY 25, 2007 and examined  
and filed JUNE 19, 2007.Signed Jeff D. Lund P.L.S. No. 4440  
Title Assistant County SurveyorCounty Surveyor's Comment                     (D.D. Sheet No. 33 )

LEGEND:

(M) FIELD MEASURED DATA

R.S. RECORD OF SURVEY, BOOK-PAGE, S.J.C.R.

M.&P. MAPS AND PLATS, VOL-PAGE, S.J.C.R.

D.N. RECORDER'S DOCUMENT NO., S.J.C.R.

S.F.N. SEARCHED, FOUND NOTHING

S.J.C.R. SAN JOAQUIN COUNTY RECORDS

REFERENCES:

(R1) R.S. 30-121

(R2) D.N. 2002-034571

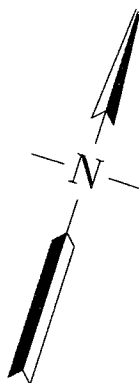

SCALE: 1" = 50'



0' 50' 100' 150'

M.&P. 13-22

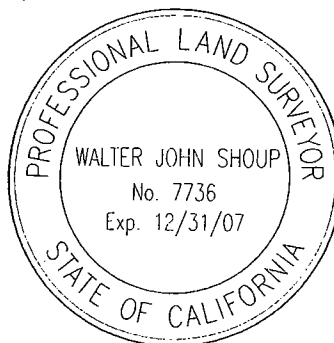

S.F.N. - FOR NAIL & SHINER AS  
SET ON TOP OF FENCE POST  
PER (R1), SET MON. NEAR N.W.  
COR. OF 6"x8" FENCE COR. POST

FD. 5/8" REBAR  
WITH CAP STAMPED  
"RCE 14269" PER (R1)  
[3/4" I. PIN PER (R1)]

N73°00'00"E

263.00'(M)(R1)(R2)

N17°24'00"W  
143.70'(M)(R1)(R2)

MIDGLEY  
D.N. 2002-034571  
PARCEL 2, R.S. 30-121

0.87 AC.

S17°24'00"E  
143.70'(M)(R1)(R2)

TULSA AVENUE

30'

S73°00'00"W (BASIS OF BEARINGS)

263.00'(M)(R1)(R2)

FD. 5/8" REBAR,  
NO TAG, NO REF.,  
SET CAP STAMPED  
"PLS 7736" ON MON.  
[3/4" I. PIN PER (R1)]

R.S. 12-211

FD. 5/8" REBAR  
WITH CAP STAMPED  
"RCE 14269" PER (R1)  
[3/4" I. PIN PER (R1)]

BASIS OF BEARINGS:

THE SOUTH LINE OF PARCEL 2 WHICH  
BEARS NORTH 73°00' EAST PER (R1).

MONUMENTS FOUND AND SET:

—●— FOUND MONUMENT AS DESCRIBED AND REFERENCED

—○— SET 3/4"x30" REBAR WITH CAP STAMPED "PLS 7736"

(D.D. SHEET #33)

05/23/07

07022CR.DWG