

# CORNER RECORD

Document Number 06-14

City of                     

County of SAN JOAQUIN, California

Brief Legal Description NW CORNER OF THE NE 1/4 OF THE NW 1/4 OF THE SW 1/4 OF SECTION 5 OF T3N, R7E OF THE MDB 3 M.

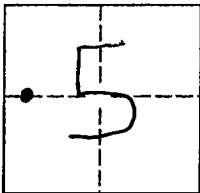

## CORNER TYPE

Government Corner ☐ Control ☐  
 Meander ☐ Property ☐  
 Rancho ☐ Other ☒

Date of Survey Oct. 25, 2005

## COORDINATES(Optional)

N.                       
 E.                       
 Zone                      NAD27 ☐ NAD83 ☐  
 NAD83 Epoch                       
 Elevation                       
 Vert. Datum: NGVD29 ☐ NAV88 ☐  
 Meas. Units: Metric ☐ Imperial ☒

Corner - Left as found ☒ Found and tagged ☐ Established ☐ Reestablished ☐ Rebuilt ☐

Identification and type of corner found: Evidence used to identify or procedure used to establish or reestablish the corner:  
FOUND RAILROAD SPIKE IN A.C. DOWN 0.1' BELOW A.C. SURFACE

A description of the physical condition of the monument as found and as set or reset: MONUMENT WAS FOUND IN GOOD CONDITION.

## SURVEYOR'S STATEMENT

This Corner Record was prepared by me or under my direction in conformance with

the Land Surveyor's Act on MAY 25, 2006.

Signed [Signature] P.L.S. or R.C.E. Number 8022  
 For the State of California  
 Department of Transportation

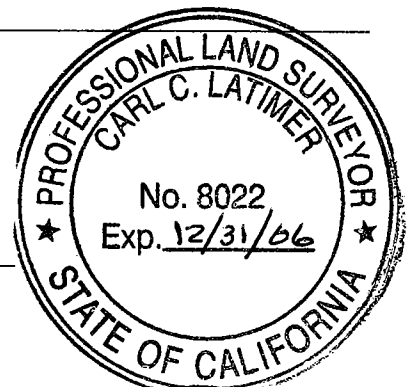

## COUNTY SURVEYOR'S STATEMENT

This Corner Record was received MAY 30, 2006 and examined

and filed JUNE 9, 2006.

Signed [Signature] P.L.S. or R.C.E. Number 4440

Title Assistant County Surveyor

County Surveyor's Comment                     

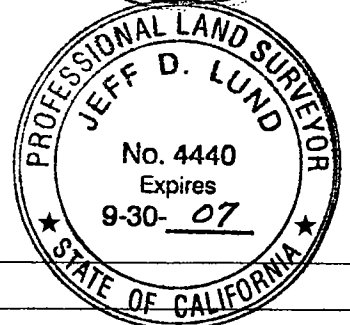

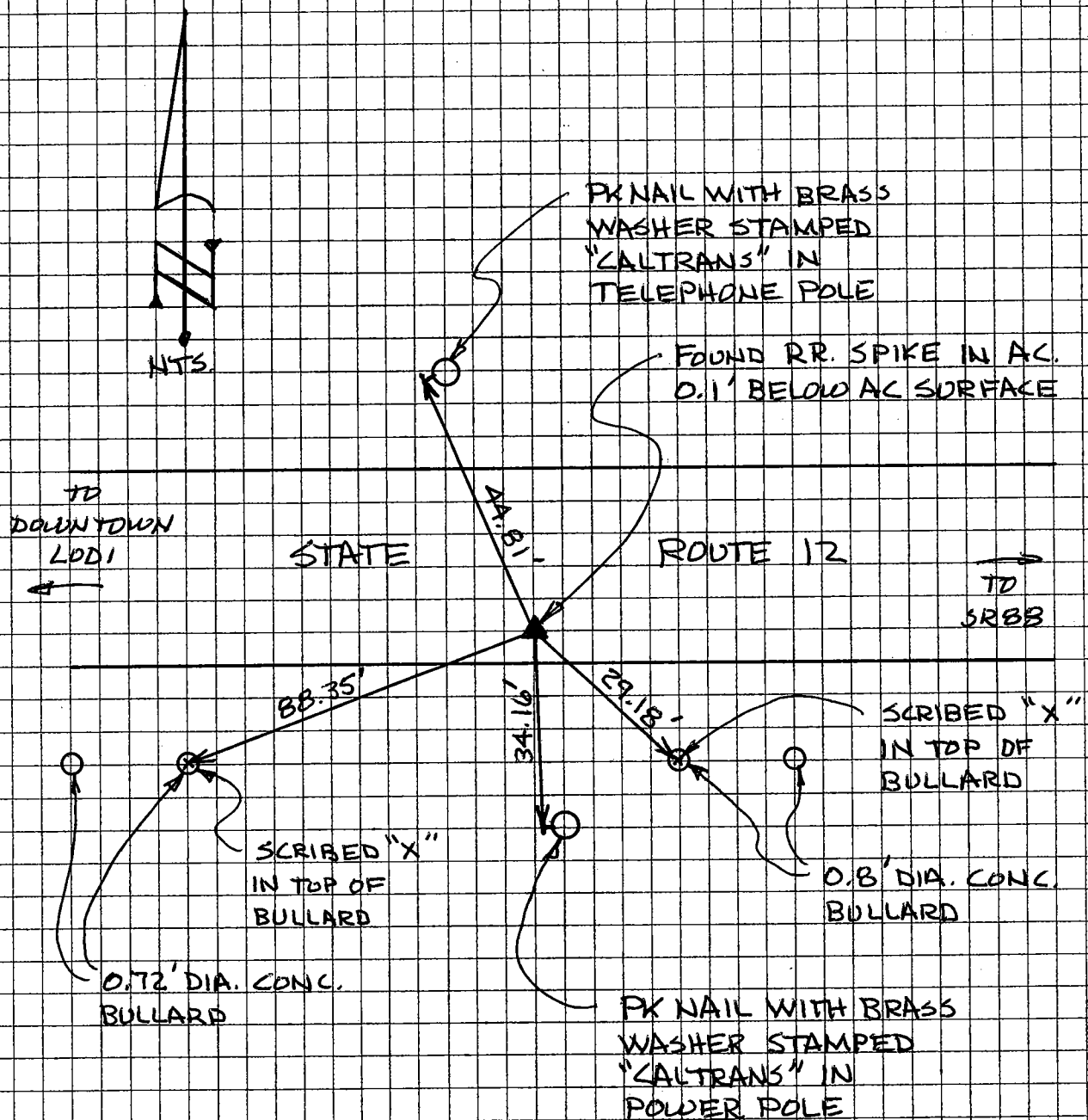

THE TIES SHOWN HEREON ARE FOR THE PURPOSE OF PERPETUATING THE MONUMENTATION CURRENTLY EXISTING. NO ATTEMPT WAS MADE TO DETERMINE THE VALIDITY OF THE MONUMENT OR IT'S PROPER LOCATION IN RELATION TO LEGAL BOUNDARY LINES IN THE AREA.