

CORNER RECORD

City of Lodi

Document Number 02-56
County of San Joaquin, California

Brief Legal Description Vine Street at Lower Sacramento Road

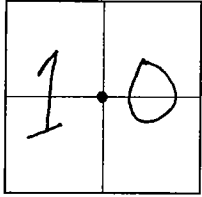

T.3N., R.6E.

CORNER TYPE

- Government Corner Control
- Meander Property
- Rancho Other

Date of Survey 8/8/99

COORDINATES (Optional)

N. _____
 E. _____
 Zone _____ NAD27 NAD83
 NAD83 Epoch _____
 Elev. _____
 Vert. Datum: NGVD29 NAVD88
 Meas. Units: Metric Imperial

Corner - Left as found Found and tagged Established Reestablished Rebuilt

Identification and type of corner found: Evidence used to identify or procedure used to establish or reestablish the corner:

Found axle at center of Section 10, Township 3 North, Range 6 East, Mount Diablo Base and Meridian,

per RS G-254

No tag

A description of the physical condition of the monument as found and as set or reset: Found monument in good condition approximately 6 inches below surface of asphalt. Reference points were set in case monument is disturbed.

SURVEYOR'S STATEMENT

This Corner Record was prepared by me or under my direction in conformance with the Land Surveyors' Act on November 15, 2002.

Signed Terry Piazza L.S. or R.C.E. Number 19638



COUNTY SURVEYOR'S STATEMENT

This Corner Record was received DECEMBER 27, 2002 and examined and filed JANUARY 3, 2003.

Signed Jeff Lund P.L.S. No. 4440
Title Assistant County Surveyor



County Surveyor's Comment This corner record is not in compliance with Board Rule 464(c) regarding submittal within 90 days from the date of survey.

(D.D. Sheet No. 15-A)

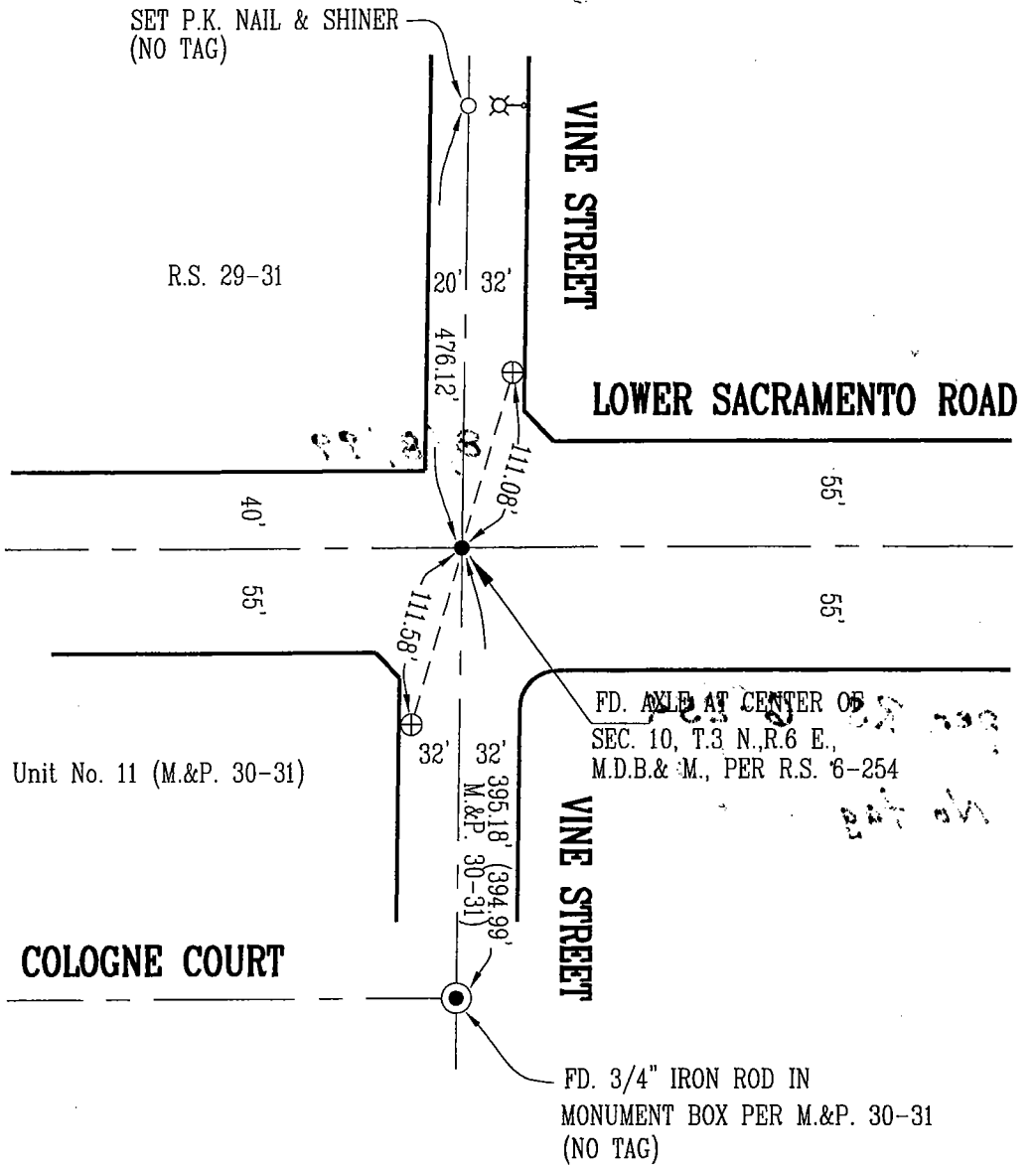

FD. AXLE AT CENTER OF
SEC. 10, T.3 N., R.6 E.,
M.D.B. & M., PER R.S. 6-254

FD. 3/4" IRON ROD IN
MONUMENT BOX PER M.&P. 30-31
(NO TAG)



NOT TO SCALE

LEGEND

- ⊕ SET CHISELLED CROSS IN CURB
 - ⊗ EXISTING STREET LIGHT
 - SET MONUMENT, AS NOTED
 - FD. FOUND
 - R.S. RECORD OF SURVEY
 - M. & P. BOOK OF MAPS AND PLATS
- ALL REFERENCES ARE TO SAN JOAQUIN COUNTY RECORDS AND BOOK OR VOLUME PRECEDES PAGE.

NOTE:
THE TIES SHOWN HEREON ARE FOR THE PURPOSE OF PERPETUATING THE MONUMENTATION CURRENTLY EXISTING. NO ATTEMPT WAS MADE TO DETERMINE THE VALIDITY OF THE MONUMENTS OR THEIR PROPER LOCATION IN RELATION TO LEGAL BOUNDARY LINES IN THE AREA.